

Gaggenau

en Operating instructions

RW 414

RW 464

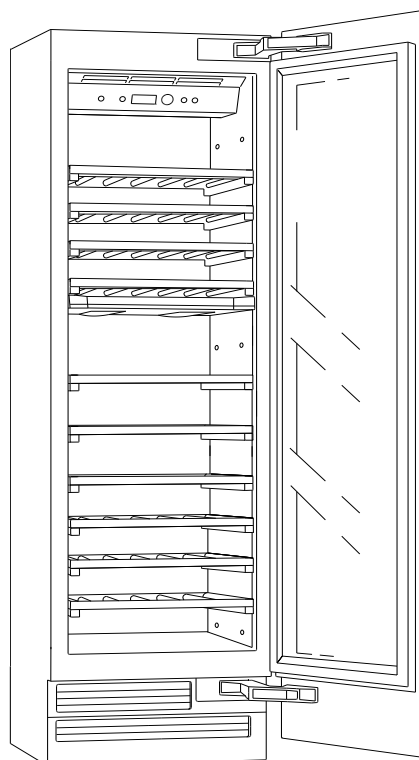

Table of Contents

Congratulations	5
Safety and warning information	5
Before you switch ON the appliance	5
Technical safety	5
Important information when using the appliance	6
Children in the household	6
General regulations	6
Information concerning disposal	7
Disposal of packaging	7
Disposal of your old appliance	7
Your new appliance	8
Fascia	9
Installation instructions	10
Installation location	10
Observing ambient temperature and ventilation	10
Fixing	10
Subsurface	10
Connecting the appliance	10
Electrical connection	11
Factory settings	11
Switching on the appliance	11
Selecting the temperature	11
Set the language	12
Door alarm	12
Door lock (optional)	12
LED presentation light	12

Variable interior design	13
Pull outs	13
Presentation attachment	13
Setup mode	13
Individual adjustments	13
Menus in the setup mode	14
Temperature unit	15
Language setting	15
Humidity function	15
Holiday mode	16
Rest mode	16
Storage examples	17
Practical tips for storing wine	17
Drinking temperatures	17
Tips for saving energy	18
Operating noises	18
Normal operating noises	18
Noises which can be easily rectified	18
Thawing the appliance	18
Switching off and disconnecting the appliance ..	18
Switching off the appliance	18
Disconnecting the appliance	18
Cleaning the appliance	18

Odours	19
Warning messages via the display	19
Door alarm.....	19
Sensor failure.....	19
Low voltage	19
Eliminating minor faults yourself.....	20
Change the light bulbs	21
Upper halogen lamp	21
LED presentation light.....	21
Changing activated carbon air filter	22
Customer service.....	22

Congratulations

By buying our temperature-controlled wine unit you have chosen a modern, high-quality domestic appliance.

Only when they have reached the right drinking temperature do good wines first develop their aroma and flavour for your full enjoyment. Your temperature-controlled wine unit provides slowly and steadily the ideal drinking temperature for your wines. Both red and white wines can be stored at the same time in the two separately configurable climatic zones.

The outstanding feature of your new appliance is its low power consumption.

Each appliance which leaves our factory is inspected thoroughly to ensure that it functions properly and is in perfect condition.

If you have any questions – particularly concerning installation and connection of the appliance – please do not hesitate to contact our customer service.

Further information and a selection of our products can be found on our home page.

Safety and warning information

Before you switch ON the appliance

Please read the operating and installation instructions carefully.

They contain important information on how to install, use and maintain the appliance.

Retain all documents for subsequent use or for the next owner.

Technical safety

Warning

This appliance contains a small quantity of environmentally friendly but flammable R600a refrigerant. Ensure that the tubing of the refrigerant circuit is not damaged during transportation and installation. Leaking refrigerant may cause eye injuries or ignite.

If damage has occurred

- keep naked flames and/or ignition sources away from the appliance,
- pull out the mains plug,
- thoroughly ventilate the room for several minutes,
- notify customer service.

The more refrigerant an appliance contains, the larger the room must be. Leaking refrigerant can form a flammable gas-air mixture in rooms which are too small.

The room must be at least 1 m³ per 8 g of refrigerant. The amount of refrigerant in your appliance is indicated on the rating plate inside the appliance.

Important information when using the appliance

- Never use electrical appliances inside the appliance (e.g. heater, electric ice maker, etc.).
Risk of explosion!
- Never use a steam cleaner to defrost or clean the appliance! The steam may penetrate electrical parts and cause a short-circuit.
Risk of electric shock!
- Do not store products which contain flammable propellants (e.g. spray cans) or explosive substances in the appliance.
Risk of explosion!
- Do not stand or support yourself on the base, drawers or doors, etc.
- For cleaning and exchanging the bulb, pull the mains plug out or switch off the fuse.
Do not pull out the mains plug by tugging the cable.

Warning: When the appliance is switched off using the temperature setting (Display: $\square F F$), the supply of current is not disrupted.

- Bottles which contain a high percentage of alcohol must be sealed and stored in an upright position.
- Keep plastic parts and the door seal free of oil and grease. Otherwise, parts and door seal will become porous.
- Never cover or block the ventilation openings for the appliance.
- People who have limited physical, sensory or mental abilities or inadequate knowledge must not use this appliance unless they are supervised or given meticulous instructions.
- Only customer service may change the power cable and carry out any other repairs. Improper installations and repairs may put the user at considerable risk.
- Only original parts supplied by the manufacturer may be used. The manufacturer guarantees that only these parts satisfy the safety requirements.

Children in the household

- Do not allow children to play with the appliance!
- If the appliance features a lock, keep the key out of the reach of children.

General regulations

This appliance is designed exclusively for the storage of wine.

This appliance is intended for use in the home and the home environment.

The appliance is suppressed according to EU Directive 2004/108/EC.

The refrigeration circuit has been checked for leaks.

This product complies with the relevant safety regulations for electrical appliances (EN 60335/2/24).

Information concerning disposal

Disposal of packaging

The packaging protects your appliance from damage during transit. All utilised materials are environmentally safe and recyclable. Please help us by disposing the packaging in an environmentally friendly manner.

Please ask your dealer or inquire at your local authority about current means of disposal.

Warning

Keep children away from packaging and its parts.
Danger of suffocation from collapsible boxes and foil!

Disposal of your old appliance

Old appliances are not worthless rubbish! Valuable raw materials can be reclaimed by recycling old appliances.



This appliance has been identified in accordance with the European directive 2002/96/EG on Waste Electrical and Electronic Equipment – WEEE. The directive specifies the framework for an EU-wide valid return and re-use of old appliances.

Warning

Redundant appliances:

- Pull out the mains plug.
- Cut off the power cord and discard with the mains plug.

Refrigerators contain refrigerant and gases in the insulation. Refrigerant and gases must be disposed of professionally. Ensure that tubing of the refrigerant circuit is not damaged prior to proper disposal.

Your new appliance

These operating instructions refer to several models. Illustrations can differ.

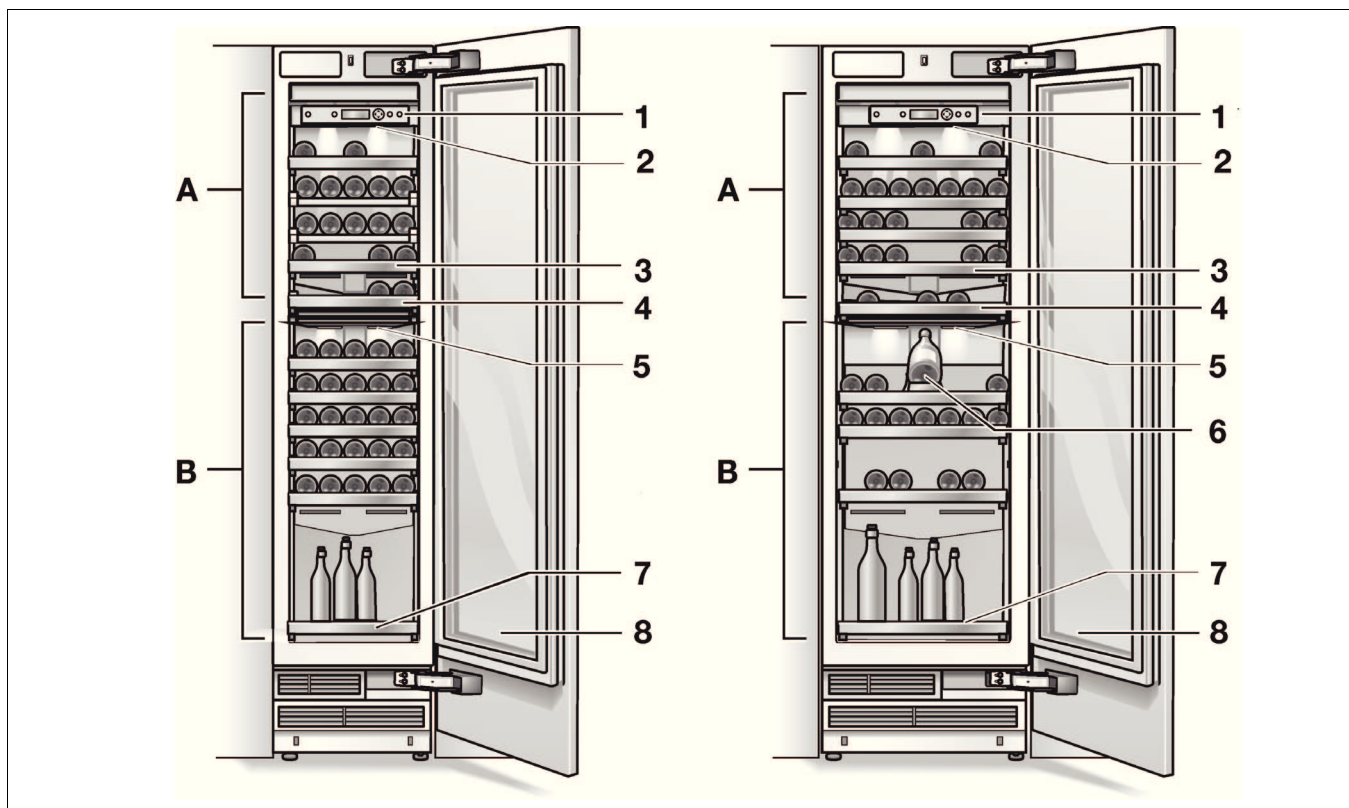

A Upper climatic zone

B Lower climatic zone

- 1 Fascia
- 2 Lighting for the upper climatic zone
- 3 Pull out
for storing wine bottles lying down
- 4 Division wall
for dividing up the different climatic zones
- 5 Light
LED presentation light for the lower climatic zone
- 6 Presentation attachment *
for full effect presentation of wine bottles
- 7 Pull out
for the storage of wine bottles standing up
- 8 Glass door

* optional accessories

Fascia

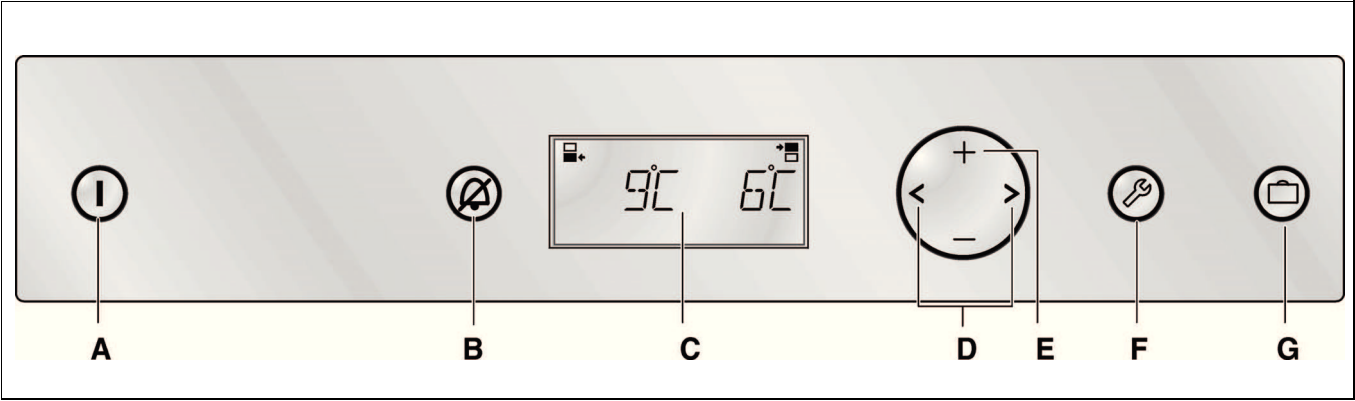

A On/off button ⓘ

Serves to switch the appliance on and off.

B Alarm button ⓘ

Used to switch off the warning signal.
See section “Door alarm”.

C Display panel

The temperature of the two climatic zones is indicated in the display field. Activated special functions are shown via “symbol”.

The menus and setting options which are available are represented on the fascia in the setup mode.
See section “Setup mode”.

D Selection buttons < >

The temperature setting is activated using the selection buttons < >.
See section “Selecting the temperature”.

For selecting a menu in the setup mode.
See section “Setup mode”.

E Setting buttons +/-

In the temperature setting mode, the temperature can be changed using the setting buttons +/-.
See section “Selecting the temperature”.

For setting the parameters available in the menu.
See section “Setup mode”.

F Press setup button ⓘ

This button starts and ends the setup mode.
If the setup mode is ended using the setup button ⓘ, the changes which have been made are stored.

G Press Holiday button ⓘ

For switching the energy saving holiday mode on and off.
See section “Holiday mode”.

Note

A sound can be heard every time a button is actuated if this function is activated (**ON**) in the sound menu during the setup mode.

Symbols in the display.

	Display for the upper climatic zone
	Display for the lower climatic zone
	“Humidity” function is activated, see “Humidity function”.
	Holiday mode is activated, see “Holiday mode”.
	For the setting options in the set up mode, see “Setup mode”.
	A warning message is displayed, see “Warning messages via the display”.

Installation instructions

Installation location

The appliance should be installed in a dry, well ventilated room.

The installation location should neither be exposed to direct sunlight nor near a heat source, e.g. a cooker, radiator, etc.

If installation near a heat source is unavoidable, use a suitable insulating plate or observe the following minimum distances to a heat source:

- to electric or gas cookers 3 cm.
- to an oil-fired or solid-fuel cooker 30 cm.

Observing ambient temperature and ventilation

Ambient temperature

The climatic class can be found on the rating plate. It states the room temperature within which the appliance can be operated.

Climate class	Permitted ambient temperature
SN	+10 °C to 32 °C
N	+16 °C to 32 °C
ST	+16 °C to 38 °C
T	+16 °C to 43 °C

Ventilation

Never cover the ventilation openings in the base panel. The cooling motor otherwise has to increase its output, and this increases the electricity consumption.

Fixing

For secure installation, the appliance is screwed to neighbouring kitchen furniture and/or units.

It is very important therefore that all bordering furniture and/or units are fixed securely to the floor and/or walls. If making structural changes fix the appliance in place again corresponding to the installation instructions.

Subsurface

⚠ Caution

The appliance is very heavy!

- Wine storage cabinet 45.7 cm (18") 245 kg
- Wine storage cabinet 61.0 cm (24") 310 kg

A load-bearing base is necessary because of the heavy weight of the fully laden appliance.

In case of doubt, consult an architect or structural engineer.

The floor of the installation location must not give way; if required, reinforce floor.

Connecting the appliance

⚠ Caution

Have a technician install and connect the appliance according to the enclosed installation instructions.

After installing the appliance, wait at least 8 hours until the appliance starts up. During transportation the oil in the compressor may have flowed into the refrigeration system.

Before switching on the appliance for the first time, clean the interior (see "Cleaning the appliance").

Apart from statutory national regulations, you should adhere to the connection terms applied by local electricity and water companies.

Do not remove the transportation protection devices from the shelves and storage compartments until the appliance has been installed.

Electrical connection

Do not use extension cables or distributors.
This appliance must be connected to a permanent socket.

The socket for connecting the appliance must be freely accessible. Connect the appliance only to 220–240 V/ 50 Hz AC current via a socket which has been properly installed. The socket must be fused with a 10 to 16 A fuse.

For appliances operated in non-European countries, the identification plate should be checked whether the electric supply and the current model stated match the values of the mains supply. The power cord may be replaced by a technician only.

Warning

Never connect the appliance to electronic energy saver plugs (e.g. Ecoboy: Sava Plug) or to power inverters which convert the direct current to 230 V alternating current (e.g. solar equipment, power supplies on ships).

Factory settings

The factory settings (language, temperature unit) can be changed in the setup mode.

Switching on the appliance

- Press the on/off button .

The appliance starts to cool down when switched on for the first time. When the door is opened, the interior light comes on.

Note

The preset temperatures (factory settings) are reached after several hours. Do not put any food in the appliance beforehand.

To change the set temperatures → see “Selecting the temperature”.

Selecting the temperature

The temperatures in both climatic zones can be set independently of each other from +5 °C to +18 °C. We recommend a setting of +11 °C.

The temperature setting can be changed using the + (warmer) or – (cooler) setting buttons. The temperature can be set at 1 °C intervals.

To set the temperature:

- Active the setup mode using the < or > buttons.

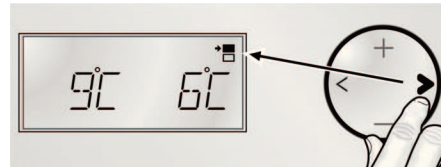

> for the upper climatic zone

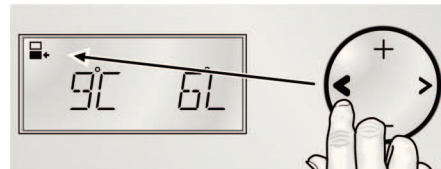

< for the lower climatic zone

The corresponding symbol ( / ) is shown.

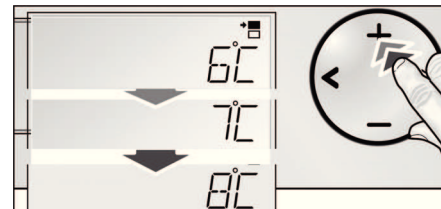

- Set the desired temperature using the + (warmer) or – (cooler) setting buttons.

Set the language

When the appliance is operated, all messages are displayed in fascia in English.

Alternatively, the display languages can be selected corresponding to the table on page 14.

In order to change the display language:

- Press setup button .
- Press the selection button **>**, until *ENGLISH* is displayed.
- Press the **+** or **-** setting button, until the desired language is displayed.



- Press the setup button , in order to store the settings. The set temperature is displayed again in the fascia.

Door alarm

If an appliance door is left open, an alarm signal is emitted after one minute and a corresponding alarm message appears in the fascia.



Close the door.

Pressing the alarm button  switches the signal off.

Door lock (optional)

A door lock is available as an accessory which can be used to lock the temperature-controlled wine cabinet (child-proof lock).

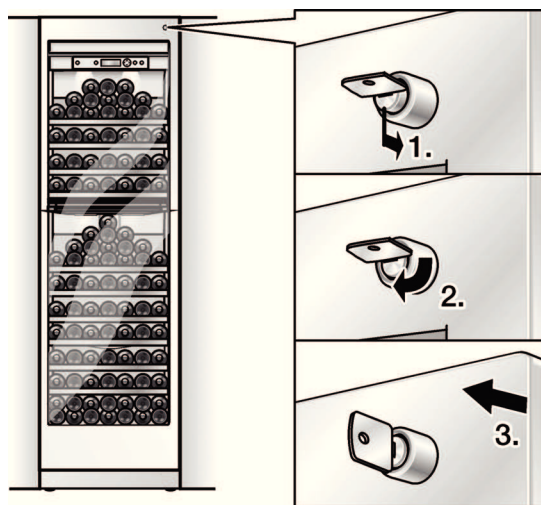

The door lock can be purchased either from customer service or a GAGGENAU dealer.

LED presentation light

Caution

Class 1M laser lighting (IEC 60825 Standard).
Do not look directly into the lighting with optical instruments.

Risk of eye injury!

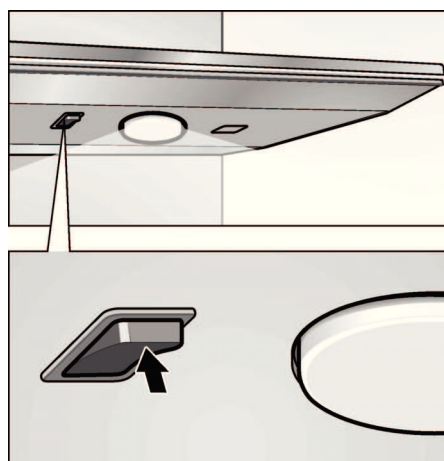

The presentation in the lower climatic zone can be switched on and off with the switch.

If the presentation light is switched on, it also lights up when the door is closed. This way wine bottles are presented on the presentation part to full effect through the glass door.

If the presentation light is switched off, it only lights up when the door is closed.

Variable interior design

You can vary the shelves inside the appliance and the containers in the door to suit your requirements.

Pull outs

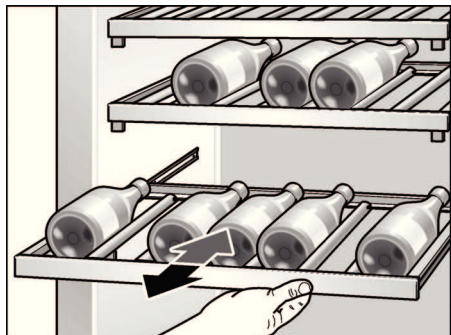

The pull outs can be easily pulled out and pushed in.

- To take out the pull outs, lift slightly and take out.

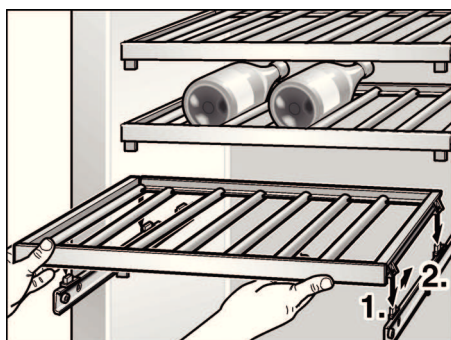

- To insert the pull outs, lift slightly forwards and insert onto the rails.
Lower the pull outs and slide backwards.

For the storage of wine bottles standing up:



- Remove the two lower pull outs from the lower climatic zone.
- Insert the pull out for standing storage (optional accessory) onto the lowest rail.

Presentation attachment

In order to be able to use the presentation part, the uppermost pull out must be taken out of the lower climatic zone.

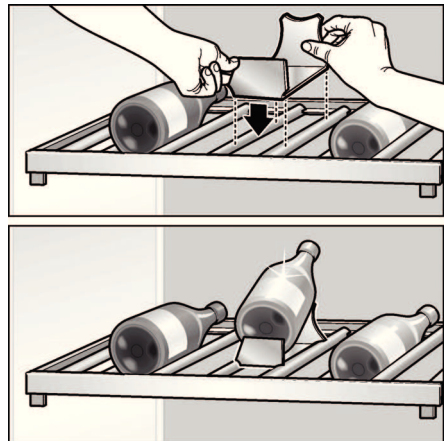

Setup mode

Individual adjustments

There are menus for adapting the appliance to the individual user requirements. These adaptations are carried out in the setup mode.

To activate the setup mode:

- Press setup button .



The first menu (temperature unit) is displayed in the fascia.

To switch to the next menu:

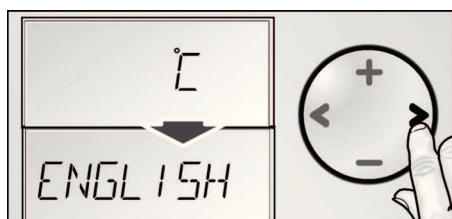

- Press the selection button < or >. The next menu is displayed and its current setting (mostly **ON** or **OFF**).

To make a selection within the setting options of a menu:

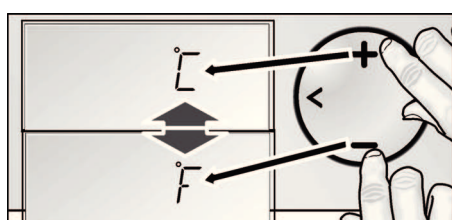

- Press the setting button + or -.
- A changed setting is stored, if the next menu is selected using < or >.

To deactivate the setup mode:

- Press setup button . All of the changed settings are stored.

If no button is selected within 20 seconds, the setup mode ends automatically. All of the changed settings are stored. The set temperature is displayed again in the fascia.

Menus in the setup mode

Menu	Setting options	Displayed text
Temperature unit	°C (degrees Celsius) °F (degrees Fahrenheit)	°C °F
Language	German English French Danish Finnish Greek Dutch Italian Polish Portuguese Norwegian Russian Swedish Spanish Turkish Czech	DEUTSCH ENGLISH FRANCAIS DANSK SUOMI ELLINIKI NEDERL ITALIANO POLSKI PORTUG NORSK RUSSK SVENSKA ESPANOL TURKCE CESKY
Sound	On/ ON Off/ OFF	TONE
Humidity (upper climatic zone)	On/ ON Off/ OFF	HUMIDITY
Humidity (lower climatic zone)	On/ ON Off/ OFF	HUMIDITY

Temperature unit

The temperature can be displayed in degrees Fahrenheit (°F) or degrees Celsius (°C).

- Press setup button (ⓘ).



The first menu (temperature unit) is displayed.

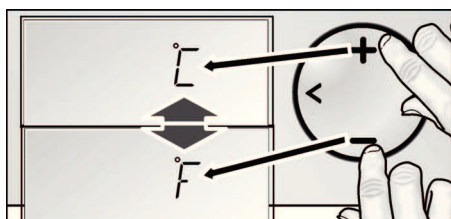

- Press the **+** or **-** setting button in order to switch between degrees Fahrenheit (°F) and degrees Celsius (°C).
- Press the setup button (ⓘ), in order to store the settings. The set temperature is displayed again in the fascia.

Language setting

When the appliance is operated, all messages are displayed in fascia in English.

Alternatively, the display languages can be selected corresponding to the table above.

- Press setup button (ⓘ).
- Press the selection button **>**, until *ENGLISH* is displayed.



- Press the **+** or **-** setting button, until the desired language is displayed.
- Press the setup button (ⓘ), in order to store the settings. The set temperature is displayed again in the fascia.

Humidity function

Independent from one another, the air humidity in the two climatic zones can be increased.

In order to switch the increased air humidity on:

- Press setup button (ⓘ).
- Press the selection button **>** until *HUMIDITY* and the momentary setting (**ON/OFF**) for the respective climatic zone is shown (in the example: Off/**OFF** for the upper climatic zone).



- Press the **+** or **-** setting button, in order to reset the setting.
- Press the setup button (ⓘ), in order to store the settings.



The symbol **HUMIDITY** is shown in the display field. The humidity function ends:

- by switching the humidity function off in the setup mode,
- by switching the appliance off using the on/off button (ⓘ).

Holiday mode

If leaving the appliance for a long period of time, you can switch the appliance to the energy-saving holiday mode.

Holiday mode settings:

- the temperature in both climatic zones is converted to an energy-saving value;
- the interior illumination is switched off.

To switch the holiday mode on:

- Press Holiday button .

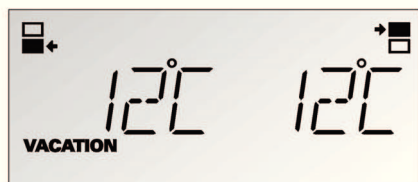

The **VACATION** symbol appears in the fascia under the eco-temperature preset at the factory.

To switch the holiday mode off:

- Press Holiday button .

The previous settings and temperature values are once again activated.

Rest mode

Settings in Rest mode:

- the acoustic signal is switched off when the button is actuated (if activated);
- The interior illumination is switched off;
- the background illumination of the fascia is switched off.

If the presentation light is switched on, it also lights up when the Rest mode is activated.

To switch on Rest mode:

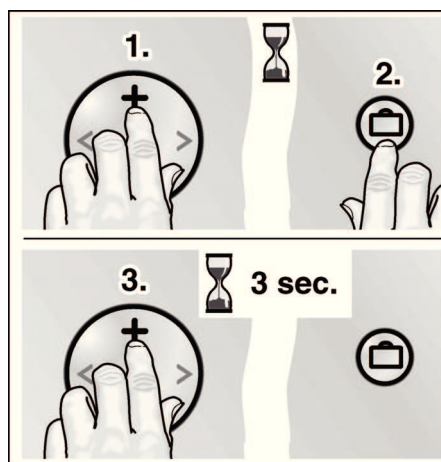

- Press and hold down the setting button **+**.
- Press Holiday button .
- Keep the button **+** held down for 3 seconds longer.

The symbol **VACATION** flashes on the display panel.

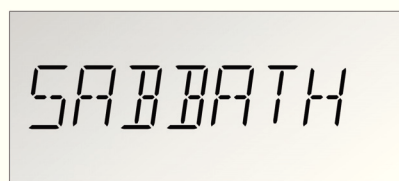

The background illumination in the fascia is switched off. **SABBATH** is displayed in the fascia. Rest mode is switched on.

To end Rest mode:

- Press Holiday button .

The previous settings and temperature values are once again activated.

Storage examples

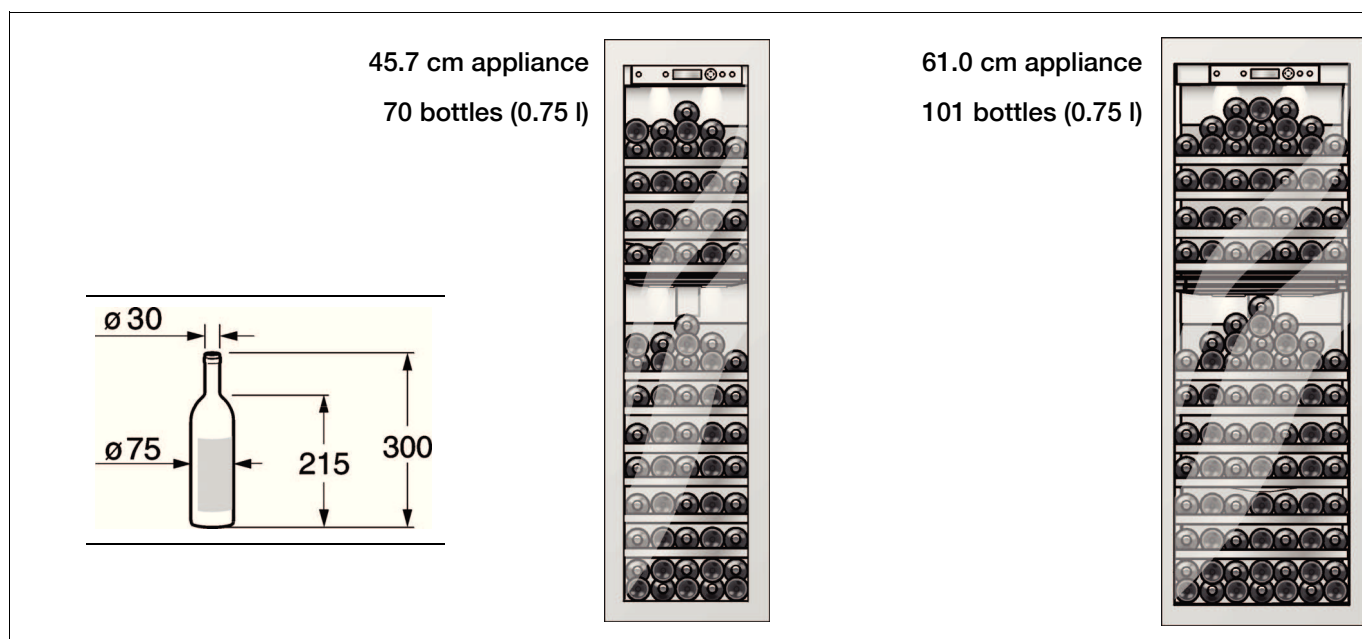

Practical tips for storing wine

- Always unpack bottles of wine – do not store in crates or boxes.
- Place old bottles so that the cork is always wet. There should never be an air gap between the wine and the cork.
- Before the wine is drunk, it should be “warmed up” (chambré): Place e.g. rosé wine on the table approx. 2–5 hours before drinking, red wine 4–5 hours before drinking. The wine will then be at the correct drinking temperature. Sparkling wine and Champagne should be cooled in the refrigerator shortly before drinking.
- Remember that wine should always be cooled slightly lower than the ideal serving temperature, as its temperature increases by 1 to 2 °C as soon as it is poured into a glass!

Drinking temperatures

The correct serving temperature is crucial for the taste and therefore your enjoyment of the wine. We recommend serving wine at the following drinking temperatures:

Type of wine	Drinking temperature
Bordeaux red	18 °C
Côtes du Rhône red/Barolo	17 °C
Burgundy red/ Bordeaux red	16 °C
Port	15 °C
Young Burgundy red	14 °C
Young red wine	12 °C
Young Beaujolais/ all white wines with little residual sugar	11 °C
Old white wines/ Chardonnay	10 °C
Sherry	9 °C
Young white wines from late vintage	8 °C
White wines Loire/ Entre-deux-Mers	7 °C

Tips for saving energy

- Install the appliance in a cool, well ventilated room, but not in direct sunlight and not near a heat source (e.g. radiator, cooker, etc.). If required, use an insulating plate.
- Allow warm food and drinks to cool down before placing in the appliance!
- Open the appliance door as briefly as possible.

Operating noises

Normal operating noises

Humming – refrigerating unit is running.
The fan in the circulating air system is running.

Bubbling, gurgling or whirring noises – refrigerant is flowing through the tubing.

Clicking – motor is switching on or off.

Noises which can be easily rectified

The appliance is not level

Align the appliance with the aid of a spirit-level.

Use the height-adjustable feet or place packing underneath them.

The pull outs wobble or stick

Please check the removable parts and re-insert them if required.

Receptacles are touching each other

Please move bottles or receptacles away from each other.

Thawing the appliance

The appliance starts to defrost automatically.

Switching off and disconnecting the appliance

Switching off the appliance

- Press the on/off button .

Disconnecting the appliance

If you do not use the appliance for a prolonged period:

- Switch off the appliance.
- Pull out the mains plug or switch off the fuse!
- Clean the appliance interior (see "Cleaning the appliance").
- To prevent odours, leave the doors open.

Cleaning the appliance

Warning

Never clean the appliance with a steam cleaner!

Water used for cleaning must not drip onto the fascia or light.

Caution

Do not use abrasive or acidic cleaning agents and solvents.

Never clean shelves and containers in the dishwasher. The parts may warp.

- Press the on/off button  and switch the appliance off! Pull out the mains plug or switch off the fuse!
- Clean the appliance with lukewarm water and a little washing-up liquid. Water used for cleaning must not drip onto the fascia or light.
- Clean the door seal with water only and dry thoroughly with a cloth.
- Remove dirt on the ventilation and air release openings using a vacuum cleaner.
- Clean the surface of the appliance using a damp cloth. Afterwards, rub dry.

After cleaning:

- Insert the plug and/or switch the fuse on.
- Press the on/off button  and switch the appliance on!

Odours

If you experience unpleasant odours:

- Press the on/off button ① and switch the appliance off! Pull out the mains plug or switch off the fuse!
- Take all food out of the appliance.
- Clean the appliance interior (see "Cleaning the appliance").
- Clean all packages.
- Seal strong smelling food in order to avoid odours from forming.
- Press the on/off button ① and switch the appliance on!
- Storing food in the appliance.
- Check whether the formation of odours is still occurring after 24 hours.
- Change the activated carbon air filter, see "Changing activated carbon air filter".

Warning messages via the display

If several warning notices appear at once, see to each warning in turn.

As long as a warning is displayed, no buttons can be pressed.

Door alarm

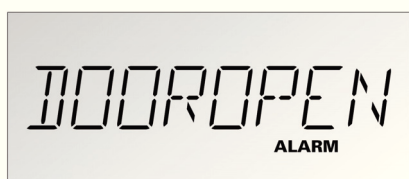

Cause

One door of the appliance has not been closed correctly or has been open too long.

Remedial action

Press the alarm button ②. Close the door. The display goes out.

Sensor failure

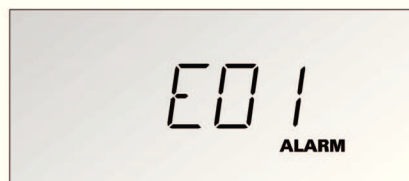

Cause

A technical defect on the appliance is possible.

Remedial action

Call Customer service.

Low voltage



Cause

The mains voltage falls below the permitted limiting value.

Remedial action

No button actuations are possible. When the mains voltage reaches the stipulated value again, the warning message goes out. If the warning message lasts for longer, inform the energy supply company.

Eliminating minor faults yourself

Before you call customer service: Please check whether you can eliminate the fault yourself based on the following information. Customer service will charge you for advice – even if the appliance is still under guarantee!

Fault	Possible cause	Remedial action
Appliance has no refrigerating capacity. Interior light does not function. The display does not illuminate.	Power failure; the fuse has been switched off; the mains plug has not been inserted properly.	Check whether the power is on. The appliance must be switched on. Check whether the mains plug is secure.
The refrigerating unit is switching on more frequently and for longer.	Appliance door opened frequently.	Do not open the door unnecessarily.
	The ventilation openings have been covered.	Remove obstructions and dirt.
The temperature in the refrigerator compartment is too cold.	Temperature has been set too low.	Select a warmer temperature (see “Selecting the temperature”).
Interior light does not function.	The bulb is defective.	Replace bulb (see “Change the light bulbs”).
	Light switch is sticking.	Check whether it can be moved.
You experience unpleasant odours.	Strongly smelling food is not sealed.	Clean the appliance. Seal strongly smelling food (see “Odours”).

Change the light bulbs

Warning

Pull out mains plug or switch off fuse.
Risk of electric shock!

Caution

Do not touch the halogen bulb with your fingers.
Always use a soft cloth when inserting a halogen bulb.

Upper halogen lamp

Halogen lamp type: 12 V/20 W/bulbholder G4

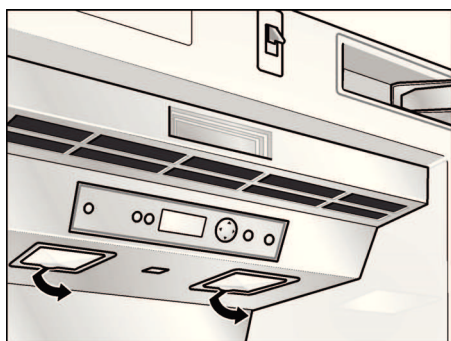

- Free the cover and remove.
- Remove the defective halogen bulb.

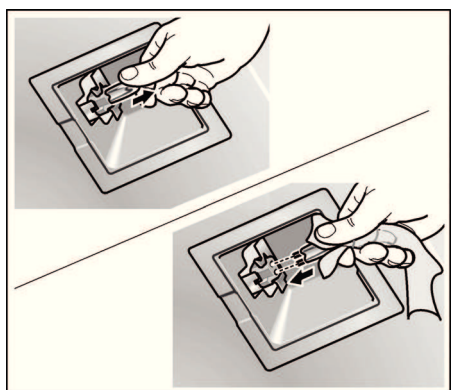

- Insert the new halogen bulb. Always use a soft cloth when inserting a halogen bulb.
- Replace the cover and press it until it engages.

LED presentation light

A new LED can be obtained from customer service.

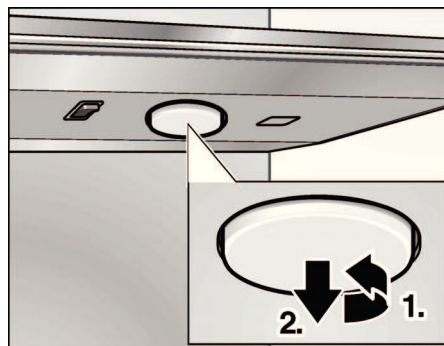

- Take out the LED by turning in a clockwise direction.



- Insert the new LED and fasten by turning anti-clockwise.

Changing activated carbon air filter

Spare filters are available from your dealer.



- Opening the filter holder.

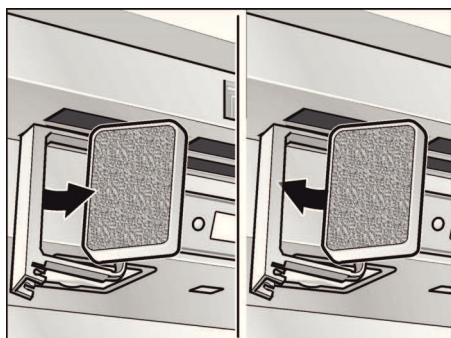

- Take out used activated carbon air filter.
- Insert new activated carbon air filter.

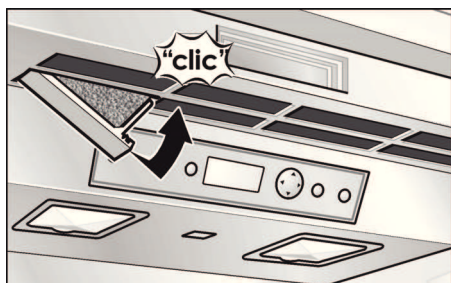

- Opening the filter holder.

Customer service

Check whether you can remedy the fault yourself on the basis of information provided in the "Eliminating minor faults yourself" section. Your local customer service can be found in the telephone directory or in the customer-service index.

Please provide customer service with the appliance product number (E-Nr.) and production number (FD).

To prevent unnecessary call-outs, please assist customer service by quoting the product and production numbers. This will save you additional costs.

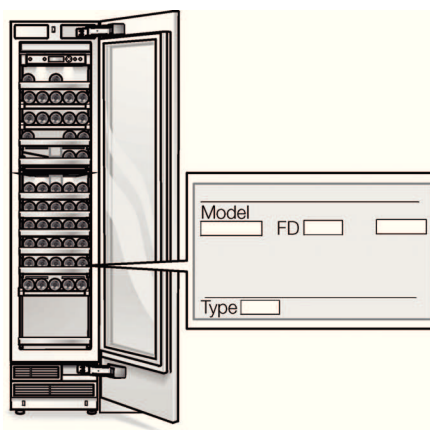

This information can be found on the product label.

Gaggenau Hausgeräte GmbH

Carl-Wery-Straße 34

D-81739 München

www.gaggenau.com