

**Gaggenau**  
en Instruction for Use



# **RB 289**

Built-in appliance

---

## en Table of Contents

---

<b>Safety and warning information</b>	<b>4</b>	<b>The “cool-fresh” compartment</b>	<b>10</b>
Before you switch ON the appliance	4	“Cool-fresh” container	10
Technical safety	4	Humidity container	11
Important information when using the appliance	4	Foods suitable for “cool-fresh” container:	11
Children in the household	5	Storage times (at 0 °C)	11
General regulations	5		
<b>Information concerning disposal</b>	<b>5</b>	<b>Freezer compartment</b>	<b>11</b>
 Disposal of packaging	5	Use the freezer compartment	11
 Disposal of your old appliance	5	<b>Max. freezing capacity</b>	<b>11</b>
<b>Scope of delivery</b>	<b>5</b>	Prerequisites for max. freezing capacity	11
<b>Observe ambient temperature and ventilation</b>	<b>6</b>	<b>Freezing and storing food</b>	<b>12</b>
Ambient temperature	6	Purchasing frozen food	12
Ventilation	6	Note when loading products	12
		Storing frozen food	12
<b>Installation location</b>	<b>6</b>	<b>Freezing fresh food</b>	<b>12</b>
<b>Connecting the appliance</b>	<b>6</b>	Packing frozen food	12
Electrical connection	6	Shelf life of frozen food	12
<b>Getting to know your appliance</b>	<b>7</b>	<b>Fast freezing</b>	<b>13</b>
Controls	8	Switching on and off	13
<b>Switching the appliance on</b>	<b>8</b>	<b>Thawing frozen food</b>	<b>13</b>
Operating tips	8	<b>Interior fittings</b>	<b>13</b>
<b>Setting the temperature</b>	<b>9</b>	Glass shelf	13
Refrigerator compartment	9	Extendable glass shelf	14
Cool-fresh compartment	9	Serving tray	14
Freezer compartment	9	Wine and champagne rack	14
		Bottle holder	14
<b>Alarm functions</b>	<b>9</b>	Gastronorm drawer	15
Door opening alarm	9	Multi-level shelf	15
Temperature alarm	9	Changing multi-level shelf	15
Switching off the alarm	9	Ice cube tray	15
		Ice pack	16
<b>Usable capacity</b>	<b>9</b>	<b>Switching off and disconnecting the appliance</b>	<b>16</b>
Fully utilising the freezer volume	9	Switching the appliance off	16
		Disconnecting the appliance	16
<b>Refrigerator compartment</b>	<b>10</b>	<b>Defrosting</b>	<b>16</b>
Storing food	10	Refrigerator and “cool-fresh” compartments	16
Note the chill zones in the refrigerator compartment	10	Freezer compartment	16
<b>Fast cooling</b>	<b>10</b>	<b>Cleaning the appliance</b>	<b>17</b>
Switching on and off	10	Interior fittings	17

<b>Odours</b>	<b>19</b>
<b>Light (LED)</b>	<b>19</b>
<b>Tips for saving energy</b>	<b>19</b>
<b>Operating noises</b>	<b>19</b>
Quite normal noises	19
Preventing noises	20
<b>Eliminating minor faults yourself</b>	<b>20</b>
<b>Customer service</b>	<b>21</b>
Repair order and advice on faults	21

## Safety and warning information

### Before you switch ON the appliance

Please read the operating and installation instructions carefully! They contain important information on how to install, use and maintain the appliance.

The manufacturer is not liable if you fail to comply with the instructions and warnings. Retain all documents for subsequent use or for the next owner.

### Technical safety

The appliance contains a small quantity of environmentally friendly but flammable refrigerant R600a. Ensure that the tubing of the refrigerant circuit is not damaged during transportation and installation. Leaking refrigerant may cause eye injuries or ignite.

#### If damage has occurred

- Keep naked flames and/or ignition sources away from the appliance,
- thoroughly ventilate the room for several minutes,
- switch off the appliance and pull out the mains plug,
- inform customer service.

The more refrigerant an appliance contains, the larger the room must be in which the appliance is situated. Leaking refrigerant can form a flammable gas-air mixture in rooms which are too small.

The room must be at least 1 m<sup>3</sup> per 8 g of refrigerant. The amount of refrigerant in your appliance is indicated on the rating plate inside the appliance.

If the power cord of this appliance is damaged, it must be replaced by the manufacturer, customer service or a similarly qualified person. Improper installations and repairs may put the user at considerable risk.

Repairs may be performed by the manufacturer, customer service or a similarly qualified person only.

Only original parts supplied by the manufacturer may be used. The manufacturer guarantees that only these parts satisfy the safety requirements.

A extension cable may be purchased from customer service only.

### Important information when using the appliance

- Never use electrical appliances inside the appliance (e.g. heater, electric ice maker, etc.). Explosion hazard!
- Never defrost or clean the appliance with a steam cleaner! The steam may penetrate electrical parts and cause a short-circuit. Risk of electric shock!
- Do not use pointed or sharp-edged implements to remove frost or layers of ice. You could damage the refrigerant tubes. Leaking refrigerant may cause eye injuries or ignite.
- Do not store products which contain flammable propellants (e.g. spray cans) or explosive substances in the appliance. Explosion hazard!
- Do not stand on or lean heavily against base of appliance, drawers or doors, etc
- For defrosting and cleaning, pull the mains plug out or switch off the fuse. Do not pull out the mains plug by tugging on the power cord.
- Store high-percentage alcohol tightly closed and standing up.
- Keep plastic parts and the door seal free of oil and grease. Otherwise, parts and door seal will become porous.
- Never cover or block the ventilation openings of the appliance!
- Do not store bottled or canned drinks (especially carbonated drinks) in the freezer compartment. Bottles and cans may burst!
- Never put frozen food straight from the freezer compartment into your mouth. Risk of low-temperature burns!

- **Avoiding placing children and vulnerable people at risk:**  
At risk are children, people who have limited physical, mental or sensory abilities, as well as people who have inadequate knowledge concerning safe operation of the appliance.  
Ensure that children and vulnerable people have understood the hazards. A person responsible for safety must supervise or instruct children and vulnerable people who are using the appliance.  
Only children from 8 years and above may use the appliance.  
Supervise children who are cleaning and maintaining the appliance.  
Never allow children to play with the appliance.
- Avoid prolonged touching of frozen food, ice or the evaporator pipes, etc.  
Risk of low-temperature burns!

## Children in the household

- Keep children away from packaging and its parts.  
Danger of suffocation from folding cartons and plastic film!
- Do not allow children to play with the appliance!
- If the appliance features a lock: keep the key out of the reach of children!

## General regulations

The appliance is suitable

- for refrigerating and freezing food,
- for making ice.

This appliance is intended for use in the home and the home environment.

The appliance is suppressed according to EU Directive 2004/108/EC.

The refrigeration circuit has been checked for leaks.

This product complies with the relevant safety regulations for electrical appliances (EN 60335-2-24).

This appliance is intended for use up to a maximum height of 2000 metres above sea level.

---

## Information concerning disposal

---

### Disposal of packaging

The packaging protects your appliance from damage during transit. All utilised materials are environmentally safe and recyclable. Please help us by disposing of the packaging in an environmentally friendly manner.

Please ask your dealer or inquire at your local authority about current means of disposal.

### Disposal of your old appliance

Old appliances are not worthless rubbish! Valuable raw materials can be reclaimed by recycling old appliances.



This appliance is labelled in accordance with European Directive 2012/19/EU concerning used electrical and electronic appliances (waste electrical and electronic equipment - WEEE). The guideline determines the framework for the return and recycling of used appliances as applicable throughout the EU.

### Warning

Redundant appliances

1. Pull out the mains plug.
2. Cut off the power cord and discard with the mains plug.
3. Do not take out the trays and receptacles: children are therefore prevented from climbing in!
4. Do not allow children to play with the appliance once it has spent its useful life. Danger of suffocation!

Refrigerators contain refrigerant and gases in the insulation. Refrigerant and gases must be disposed of professionally. Ensure that tubing of the refrigerant circuit is not damaged prior to proper disposal.

---

## Scope of delivery

---

After unpacking all parts, check for any damage in transit.

If you have any complaints, please contact the dealer from whom you purchased the appliance or our customer service.

**The delivery consists of the following parts:**

- Built-in appliance
- Interior fittings (depending on model)
- Bag containing installation materials
- Operating instructions

- Installation manual
- Customer service booklet
- Warranty enclosure
- Information on the energy consumption and noises

---

## Observe ambient temperature and ventilation

---

### Ambient temperature

The appliance is designed for a specific climate class. Depending on the climate class, the appliance can be operated at the following room temperatures.

Climate class	Permitted ambient temperature
SN	+10 °C to 32 °C
N	+16 °C to 32 °C
ST	+16 °C to 38 °C
T	+16 °C to 43 °C

The climate class can be found on the rating plate.

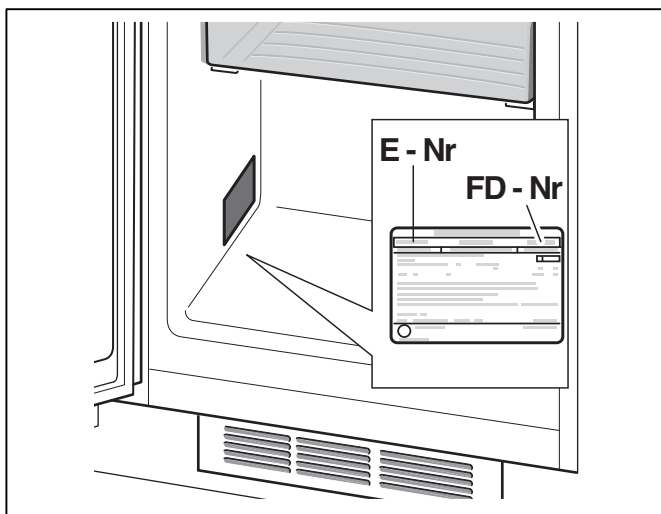

#### Note

The appliance is fully functional within the room temperature limits of the indicated climatic class. If an appliance of climatic class SN is operated at colder room temperatures, the appliance will not be damaged up to a temperature of +5 °C.

### Ventilation

The refrigeration unit is ventilated only via the ventilation grille in the base. Never cover the ventilation grille or place anything in front of it. Otherwise the refrigeration unit must work harder, increasing the power consumption.

---

## Installation location

---

Install the appliance in a dry, well ventilated room. The installation location should neither be exposed to direct sunlight nor near a heat source, e. g. a cooker, radiator, etc. If installation next to a heat source is unavoidable, use a suitable insulating plate or observe the following minimum distances to a heat source:

- 3 cm to electric or gas cookers.
- 30 cm to an oil or coal-fired cooker.

---

## Connecting the appliance

---

After installing the appliance, wait at least 1 hour until the appliance is switched on. During transportation the oil in the compressor may have flowed into the refrigeration system.

Before switching on the appliance for the first time, clean the interior of the appliance (see chapter "Cleaning the appliance").

### Electrical connection

The socket must be near the appliance and also freely accessible following installation of the appliance.

The appliance complies with the protection class I. Connect the appliance to 220–240 V/50 Hz alternating current via a correctly installed socket with protective conductor. The socket must be fused with a 10 to 16 A fuse.

For appliances operated in non-European countries, check whether the stated voltage and current type match the values of your mains supply. These specifications can be found on the rating plate.

#### **⚠ Warning**

Never connect the appliance to electronic energy saver plugs.

Our appliances can be used with mains and sine-controlled inverters. Mains-controlled inverters are used for photovoltaic systems which are connected directly to the national grid. Sine-controlled inverters must be used for isolated applications (e.g. on ships or in mountain lodges) which are not connected directly to the national grid.

## Getting to know your appliance

These operating instructions refer to several models.

The features of the models may vary.

The diagrams may differ.

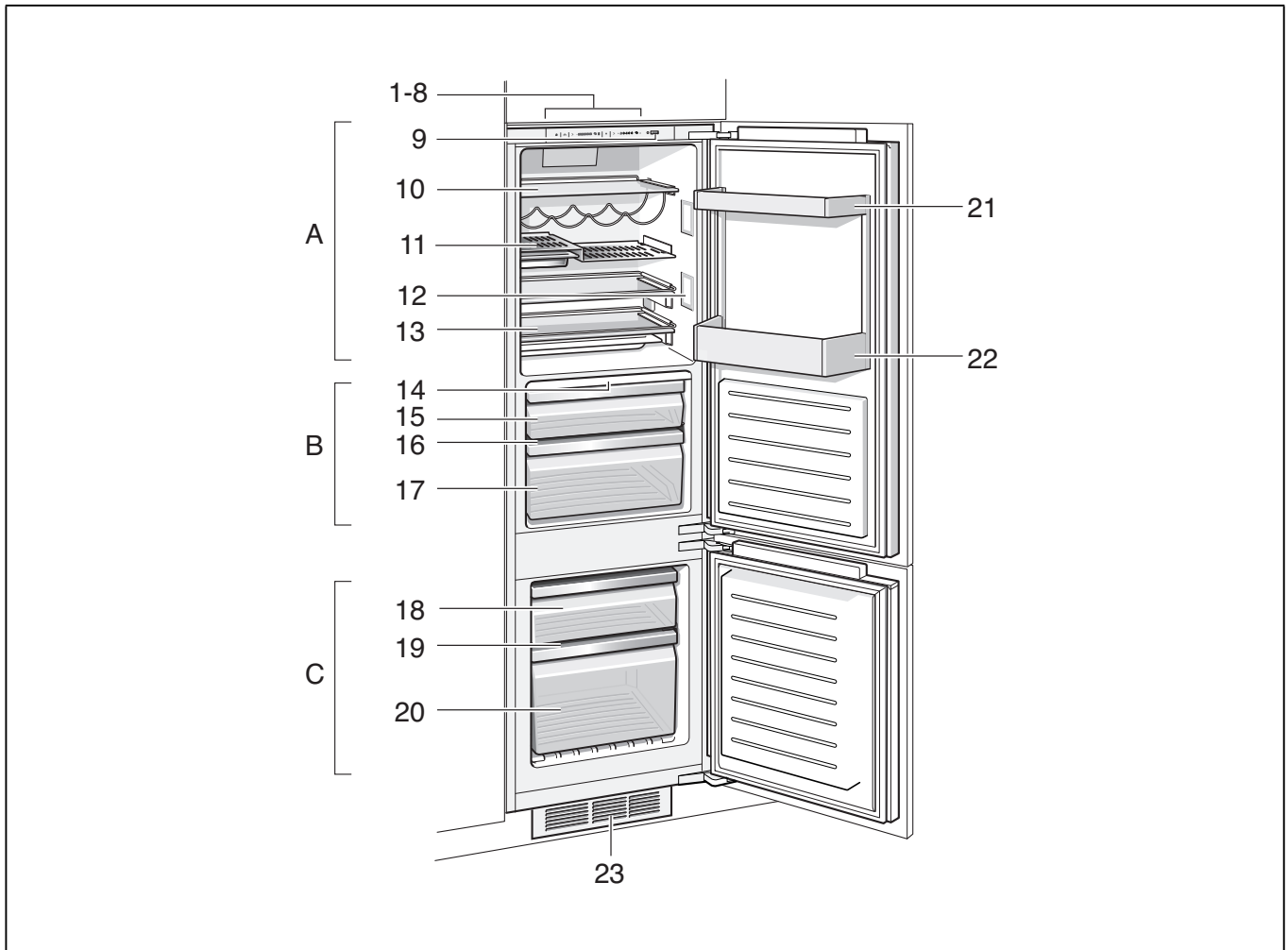

A	Refrigerator compartment	17	Humidity container
B	Cool-fresh compartment	18	Frozen food container (small)
C	Freezer compartment	19	Glass shelf in the freezer compartment
		20	Frozen food container (large)
1-8	Controls	21	Door shelf
9	On/Off button	22	Shelf for large bottles
10	Glass shelf in the refrigerator compartment	23	Ventilation opening
11	Multi-level shelf with Gastronorm drawer		
12	Light, refrigerator compartment		
13	Extendable glass shelf with serving tray		
14	Light, cool-fresh compartment		
15	“Cool-fresh” container		
16	Humidity filter		

## Controls

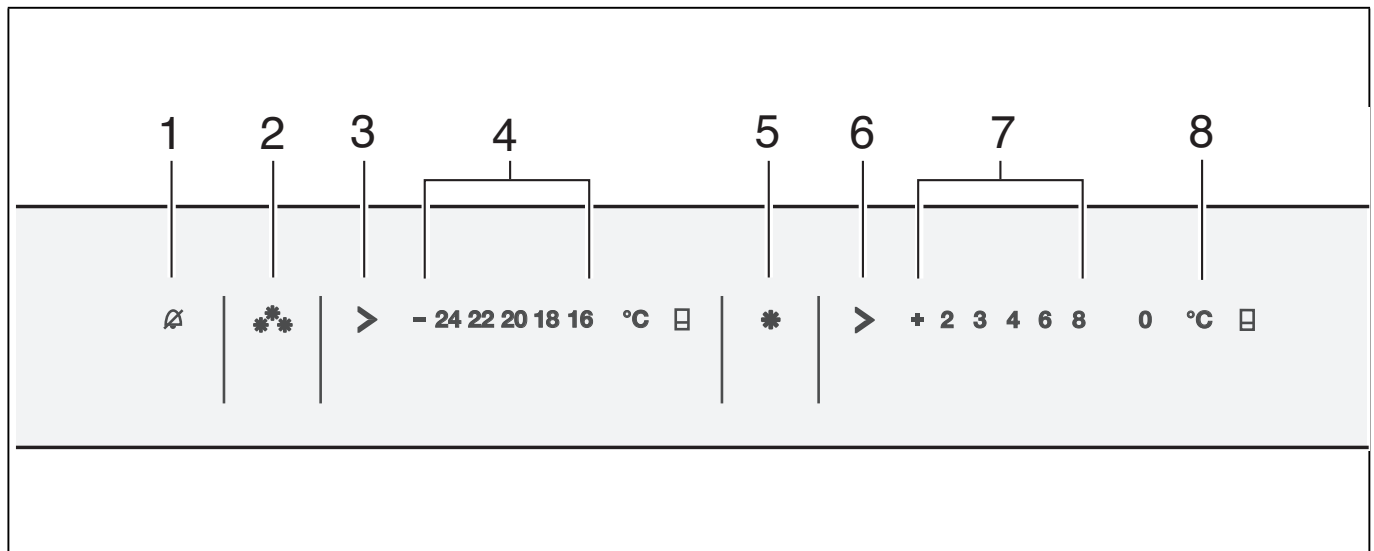

- 1 Alarm button** Used to switch off the warning signal, (see chapter "Alarm function").
- 2 "Fast" button freezer compartment** . Switches fast freezing on and off (see chapter "Fast freezing").
- 3 Temperature setting button freezer compartment** The button sets the temperature in the freezer compartment.
- 4 Temperature display freezer compartment** The numbers correspond to the set freezer compartment temperatures in °C.
- 5 Fast button refrigerator compartment** Switches fast cooling on and off (see chapter "Fast cooling").
- 6 Temperature setting button refrigerator compartment** The button sets the temperature in the refrigerator compartment.
- 7 Temperature display refrigerator compartment** The numbers correspond to the set refrigerator compartment temperatures in °C.
- 8 ON/OFF display** The ON/OFF display is lit when the appliance is in operation.

## Switching the appliance on

- Switch on the appliance with the On/Off button . A warning signal sounds, the temperature display for the freezer compartment flashes and the alarm button is lit.
- The warning signal is switched off by pressing the "alarm" button . The appliance begins to cool. Light is switched on when the door is open.

The factory has recommended the following temperatures:

- Refrigerator compartment: +4 °C
- "Cool-fresh" compartment: at almost 0 °C
- Freezer compartment: -18 °C

## Operating tips

- After the appliance has been switched on, it may take several hours until the set temperatures have been reached. Do not put any food in the appliance beforehand.
- The fully automatic No Frost system ensures that the freezer compartment remains free of ice. Defrosting is not required.
- The front sides of the housing are partly heated slightly. This prevents condensation in the area of the door seal.
- If the freezer compartment door cannot be immediately re-opened after it has been closed, wait until the resulting low pressure has equalised.



---

## Setting the temperature

---

### Refrigerator compartment

The temperature can be set from +2 °C to +8 °C.

Keep pressing refrigerator compartment temperature selection button **>** until the required refrigerator compartment temperature is set.

The value last selected is saved. The set temperature is indicated on temperature display for the refrigerator compartment.

### Cool-fresh compartment

The temperature in the “cool-fresh” compartment has been set to almost 0 °C at the factory and should not be changed if at all possible.

If frost forms on the refrigerated food, the temperature can be increased. (See chapter “Eliminating minor faults yourself”.)

### Freezer compartment

The temperature can be set from -16 °C to -24 °C.

Keep pressing freezer compartment temperature selection button **>** until the required freezer compartment temperature is set.

The value last selected is saved. The set temperature is indicated on temperature display for the freezer compartment.

---

## Alarm functions

---

### Door opening alarm

If the appliance is left open for longer than one minute, the door alarm (continuous sound) switches on. Close the door or press the Alarm button 1 to switch the warning signal off again.

### Temperature alarm

The temperature alarm switches on if the freezer compartment is too warm and the frozen food is at risk of thawing.

- Alarm button **⚡** flashes: Frozen food is or was at risk of thawing.
- Alarm button **⚡** is lit: Frozen food is not at risk of thawing.

### Note

Do not refreeze thawing or thawed food. Only ready meals (boiled or fried) may be refrozen. No longer store the frozen produce for the max. storage period.

The alarm may switch on without any risk to the frozen food:

- when the appliance is switched on,
- when large quantities of fresh food are placed in the appliance,
- if the freezer compartment door is open too long.

### Switching off the alarm

Press the alarm button **⚡** to switch off the warning signal.

---

## Usable capacity

---

Information on the usable capacity can be found inside your appliance on the rating plate (see diagram at chapter “Customer service”).

### Fully utilising the freezer volume

The maximum amount of food can be placed in the freezer by removing all fittings. The food can be stacked directly on the shelves and in the bottom of the freezer compartment.

### Removing the fittings

Pull out the frozen food container all the way, lift at the front and remove.

### Note

To insert the frozen food container with telescopic rails, the rails must be pulled out.

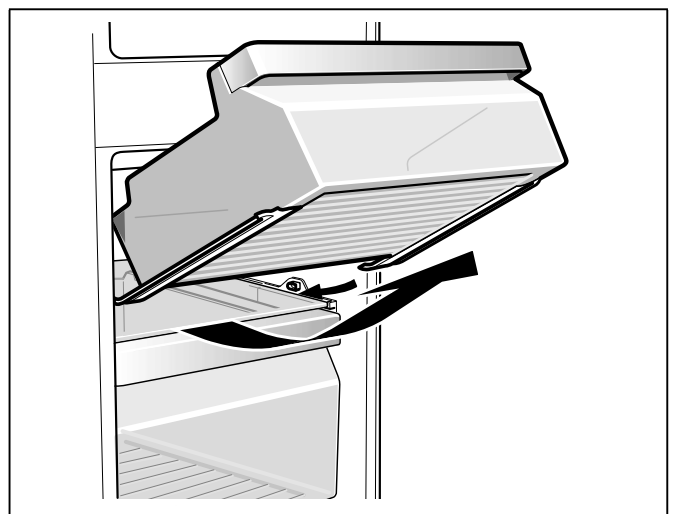

---

## Refrigerator compartment

---

The refrigerator compartment is the ideal storage location for ready meals, cakes and pastries, preserved food, condensed milk and hard cheese.

### Storing food

- Store fresh, undamaged food. The quality and freshness will then be retained for longer.
- In the case of ready-made products and bottled goods, observe the best-before date or use-by date specified by the manufacturer.
- To retain aroma, colour and freshness, pack or cover food well before placing in the appliance. This will prevent the transfer of flavours and the discolouration of plastic parts in the refrigerator compartment.
- Allow warm food and drinks to cool down before placing in the appliance.

#### Note

Avoid contact between food and rear panel. Otherwise the air circulation will be impaired. Food or packaging could freeze to the rear panel.

### Note the chill zones in the refrigerator compartment

The air circulation in the refrigerator compartment creates different chill zones:

- The coldest zones are on the rear panel, on the extendable glass shelves and in the serving tray.

#### Note

Store perishable food (e.g. fish, sausage, meat) in the coldest zones.

- Warmest zone is at the very top of the door.

#### Note

Store e.g. hard cheese and butter in the warmest zone. Cheese can then continue to release its flavour and the butter will still be easy to spread.

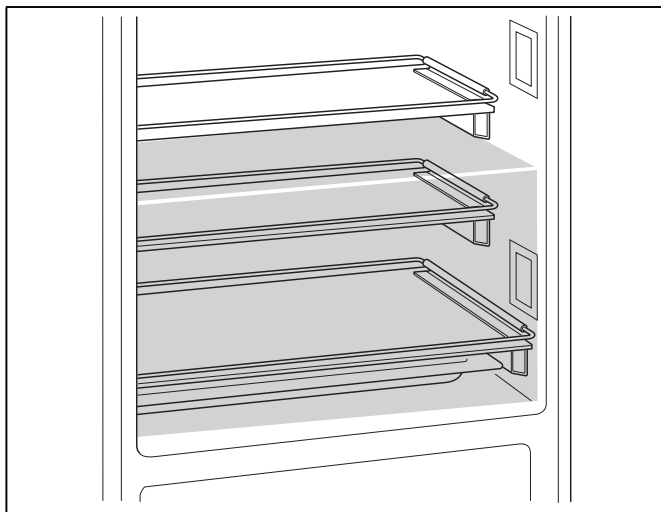

---

## Fast cooling

---

Fast cooling sets the refrigerator temperature to the coldest temperature setting for approx. 6 hours. Then the original temperature set before fast cooling mode is automatically restored.

Switch on fast cooling mode, e.g.:

- before placing large quantities of food in the refrigerator compartment.
- for fast cooling drinks.

#### Note

When fast cooling is switched on, increased operating noises may occur.

### Switching on and off

Press “fast” button refrigerator compartment ✱.

The button is lit when fast cooling is switched on.

---

## The “cool-fresh” compartment

---

The temperature in the fridge is about 0 °C. The low temperature and the optimum moisture provide ideal storage conditions for fresh food.

Food can be kept fresh up to three times longer in the “cool-fresh” compartment than in the normal cooling zone – for even longer freshness, nutrient retention and flavour.

### “Cool-fresh” container

The storage climate in the “cool-fresh” container offers ideal conditions for the storage of fish, meat, sausage, cheese and milk.

## Humidity container

The humidity container is covered with a special filter which optimises retention of the air humidity in the storage compartment. As a result, there is up to 95 % air humidity in the humidity container, depending on the amount of products put in. This storage climate offers ideal conditions for fresh fruit, salad greens, vegetables, herbs and mushrooms.

### Notes

- Fruit sensitive to cold (e.g. pineapple, banana, papaya and citrus fruit) and vegetables sensitive to cold (e.g. aubergines, cucumbers, zucchini, peppers, tomatoes and potatoes) should be stored outside the refrigerator at temperatures of approx. 8 °C to 12 °C for optimum preservation of quality and flavour.
- Condensation may form in the humidity container depending on the type and quantity of products stored. Remove condensation with a dry cloth.

## Foods suitable for “cool-fresh” container:

### In the “cool-fresh” container:

Fish, seafood, meat, sausage, dairy products, ready meals.

### In the humidity container:

- Vegetables (e.g. carrots, asparagus, celery, leeks, beetroot, mushrooms, brassicas such as broccoli, cauliflower, Brussels sprouts, kohlrabi)
- Salad greens (e.g. lamb’s lettuce, iceberg lettuce, chicory, lettuce)
- Herbs (e.g. dill, parsley, chives, basil)
- Fruit (types insensitive to cold, e.g. apples, peaches, berries, grapes)

## Storage times (at 0 °C)

Depending on the initial quality	
Fresh fish, seafood	up to 3 days
Poultry, meat (boiled/fried)	up to 5 days
Beef, pork, lamb, sausage (cold meat)	up to 7 days
Smoked fish, broccoli	up to 14 days
Salad greens, fennel, apricots, plums	up to 21 days
Soft cheese, yoghurt, quark, buttermilk, cauliflower	up to 30 days

---

## Freezer compartment

---

### Use the freezer compartment

- To store deep-frozen food.
- To make ice cubes.
- To freeze food.

### Note

Ensure that the freezer compartment door has been closed properly. If the door is open, the frozen food will thaw. The freezer compartment will become covered in thick ice. Also: waste of energy due to high power consumption!

---

## Max. freezing capacity

---

Information about the max. freezing capacity within 24 hours can be found on the rating plate (see diagram at chapter “Customer service”).

### Prerequisites for max. freezing capacity

- Switch on fast freezing before placing fresh products in the compartment (see chapter “Fast freezing”).
- Removing the fittings
- The food can be stacked directly on the shelves and in the bottom of the freezer compartment.

### Note

Do not cover the ventilation slots on the rear panel with frozen food.

- Freeze large quantities of food preferably in the very top compartment where food freezes particularly quickly and therefore also gently.

---

## Freezing and storing food

---

### Purchasing frozen food

- Packaging must not be damaged.
- Use by the “use by” date.
- Temperature in the supermarket freezer must be  $-18\text{ }^{\circ}\text{C}$  or lower.
- If possible, transport deep-frozen food in an insulated bag and place quickly in the freezer compartment.

### Note when loading products

- Preferably freeze large quantities of food in the top compartment, where food freezes particularly quickly and therefore also gently.
- Place the food over the whole area of the compartments or the frozen food containers.

#### Note

Food which is already frozen must not come into contact with the food which is to be frozen. If required, move the frozen food to other frozen food containers.

### Storing frozen food

Insert frozen food container all the way to ensure unrestricted air circulation.

---

## Freezing fresh food

---

Freeze fresh and undamaged food only.

To retain the best possible nutritional value, flavour and colour, vegetables should be blanched before freezing. Aubergines, peppers, zucchini and asparagus do not require blanching.

Literature on freezing and blanching can be found in bookshops.

#### Note

Keep food which is to be frozen away from food which is already frozen.

- The following foods are suitable for freezing: Cakes and pastries, fish and seafood, meat, game, poultry, vegetables, fruit, herbs, eggs without shells, dairy products such as cheese, butter and quark, ready meals and leftovers such as soups, stews, cooked meat and fish, potato dishes, soufflés and desserts.
- The following foods are not suitable for freezing: Types of vegetables, which are usually consumed raw, such as lettuce or radishes, eggs in shells, grapes, whole apples, pears and peaches, hard-boiled eggs, yoghurt, soured milk, sour cream, crème fraîche and mayonnaise.

### Packing frozen food

To prevent food from losing its flavour or drying out, place in airtight containers.

1. Place food in packaging.
2. Remove air.
3. Seal the wrapping.
4. Label packaging with contents and date of freezing.

#### Suitable packaging:

Plastic film, tubular film made of polyethylene, aluminium foil, freezer containers.

These products are available from specialist outlets.

#### Unsuitable packaging:

Wrapping paper, greaseproof paper, cellophane, bin liners and used shopping bags.

#### Items suitable for sealing packaged food:

Rubber bands, plastic clips, string, cold-resistant adhesive tape, etc.

Bags and tubular film made of polyethylene can be sealed with a film heat sealer.

### Shelf life of frozen food

Storage duration depends on the type of food.

At a temperature of  $-18\text{ }^{\circ}\text{C}$ :

- Fish, sausage, ready meals and cakes and pastries:  
up to 6 months
- Cheese, poultry and meat:  
up to 8 months
- Vegetables and fruit:  
up to 12 months

---

## Fast freezing

---

Food should be frozen solid as quickly as possible in order to retain vitamins, nutritional value, appearance and flavour.

Several hours before placing fresh food in the freezer compartment, switch on fast freezing to prevent an unwanted temperature rise.

As a rule, 4-6 hours is adequate.

This appliance runs constantly and the freezer compartment drops to a very low temperature.

If you would like to use the max. freezing capacity, switch on fast freezing for 24 hours before placing the fresh produce in the freezer compartment.

You can freeze smaller quantities of food (up to 2 kg) without fast freezing.

### Note

When fast freezing is switched on, increased operating noises may occur.

## Switching on and off

Press "fast" button freezer compartment **\*\***.

If the fast freezing has been switched on the button is lit.

Fast freezing automatically switches off after approx. 2½ days.

---

## Thawing frozen food

---

Depending on the type and application, select one of the following options:

- at room temperature
- in the refrigerator
- in an electric oven, with/without fan assisted hot-air
- in the microwave

### **⚠ Caution**

Do not refreeze thawing or thawed food. Only ready meals (boiled or fried) may be refrozen. No longer store the frozen produce for the max. storage period.

---

## Interior fittings

---

(not all models)

### Glass shelf

To store tall items, you can change the position of the glass shelf.

1. To remove the glass shelf, pull up at an angle and take out.

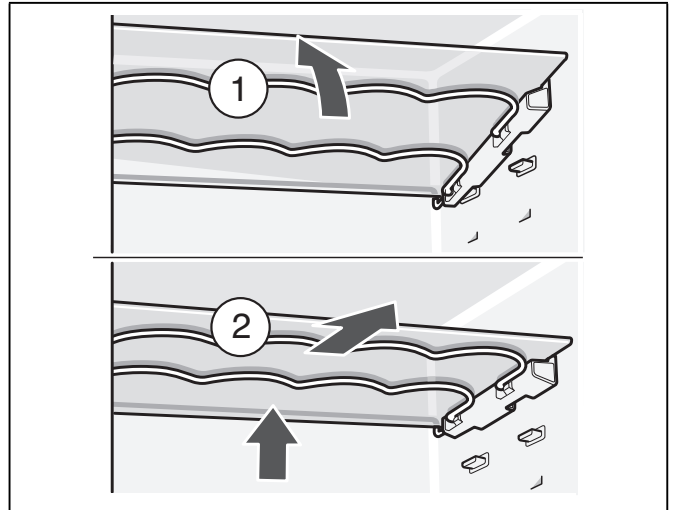

2. Move stoppers.

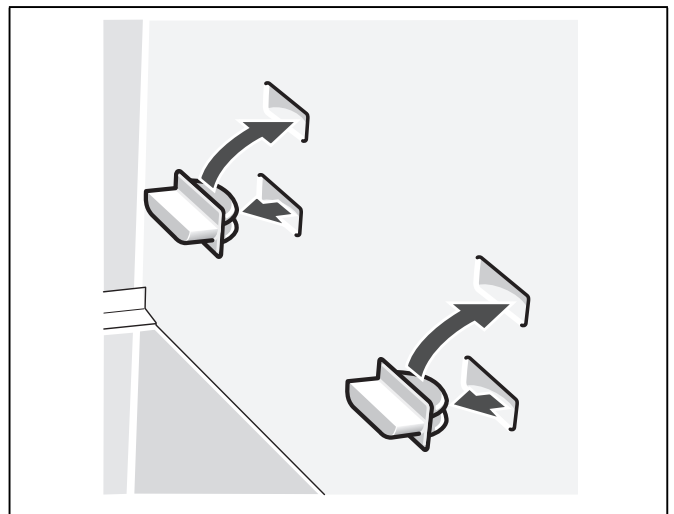

3. To re-insert the glass shelf, first place it on the back stoppers and then engage at the front.

## Extendable glass shelf

The extendable glass shelf can be pulled out for a better overview of the food.

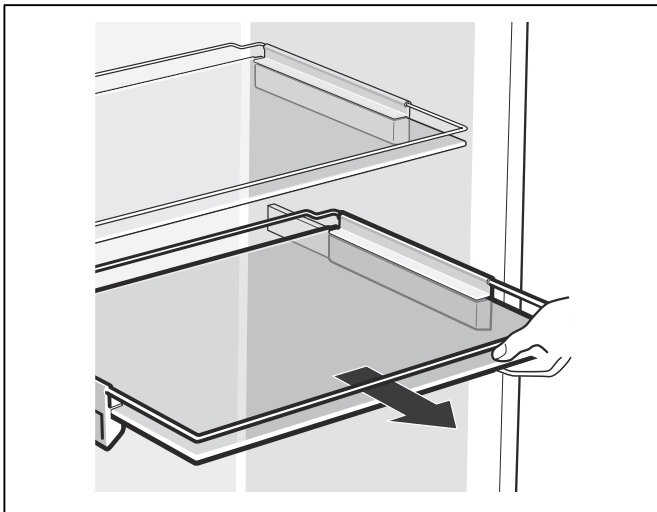

## Wine and champagne rack

You can store bottles securely in the wine and champagne rack. If you require space for other food, you can fold the metal clips upwards.

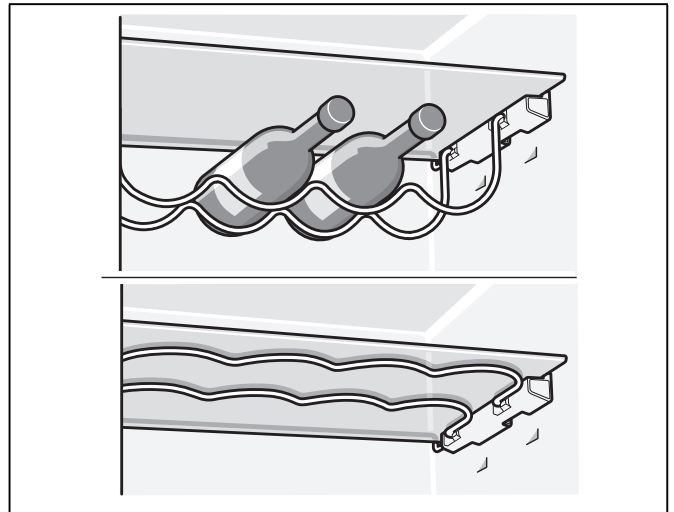

## Serving tray

You can prepare food in the serving tray, e.g. sausage or cheese platters, keep food cool and serve food.

### Note

To prevent the transfer of odours and flavours, cover food with foil.

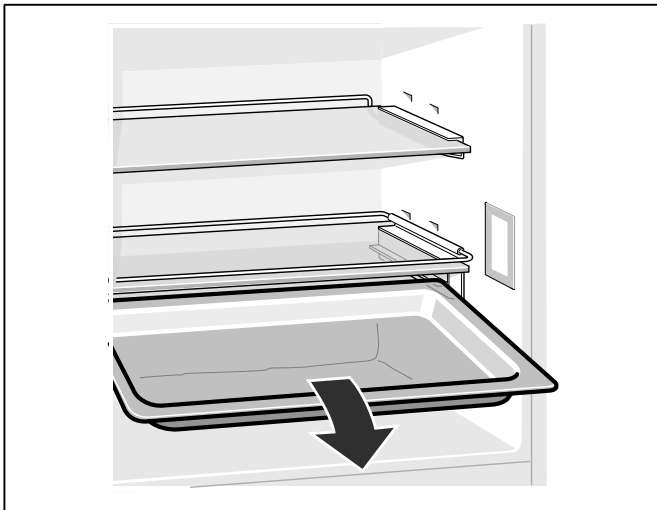

## Bottle holder

The bottle holder prevents bottles from falling over when the door is opened and closed.

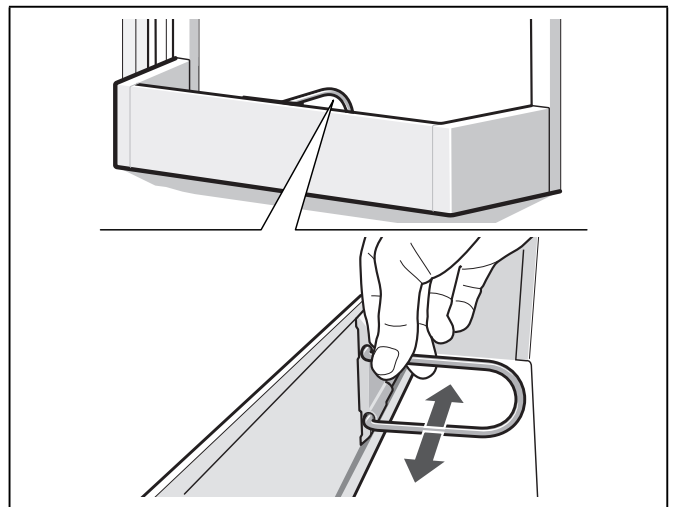

## Gastronorm drawer

Food can be stored in the Gastronorm drawer and placed in the refrigerator compartment with minimum space requirements.

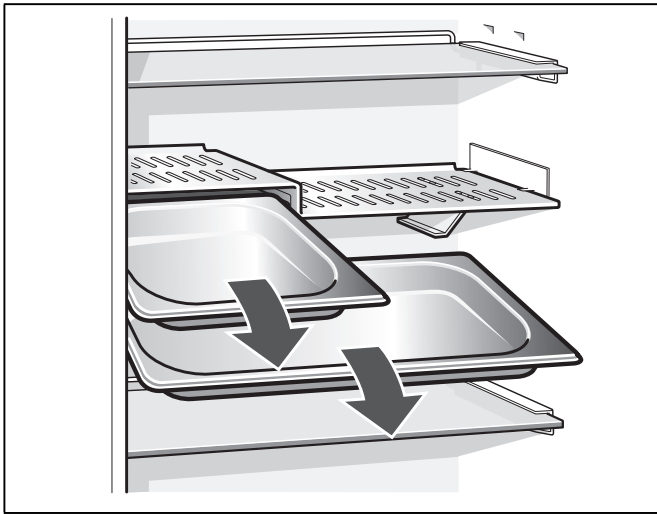

## Changing multi-level shelf

If you would like to use a different size of Gastronorm drawer, you can change the positions of the holders.

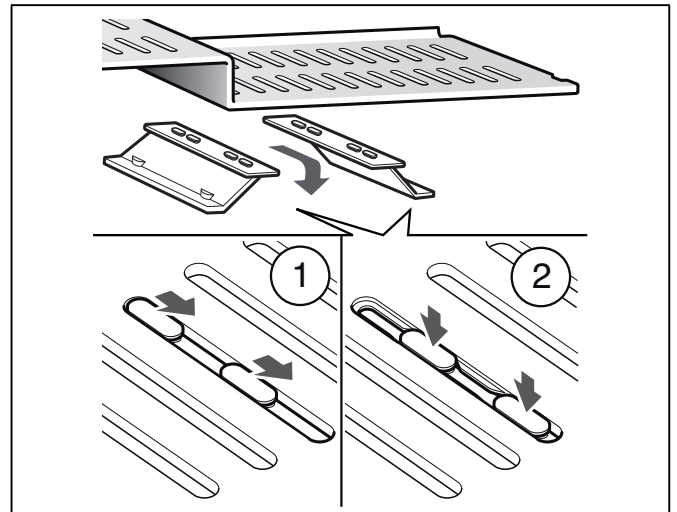

## Multi-level shelf

Before you can take out the multi-level shelf, you must remove the Gastronorm drawers.

Lift multi-level shelf at the front, pull out and swing out to the side.

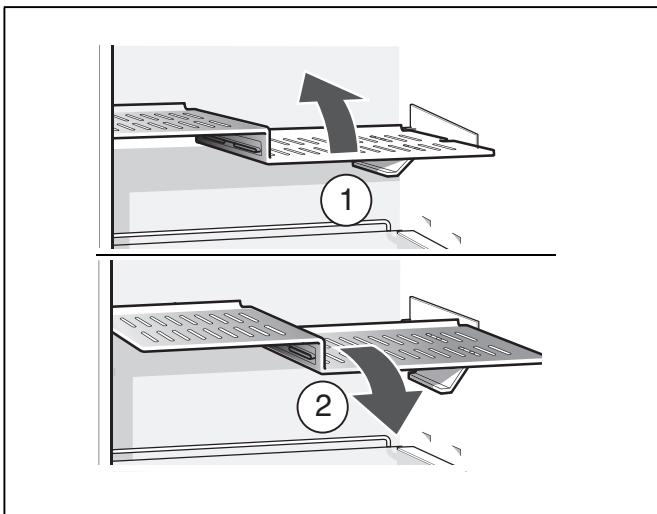

## Ice cube tray

Fill the ice cube tray  $\frac{3}{4}$  full of drinking water and place in the freezer compartment.

If the ice tray is stuck to the freezer compartment, loosen with a blunt implement only (spoon-handle).

To loosen the ice cubes, twist the ice tray slightly or hold briefly under flowing water.

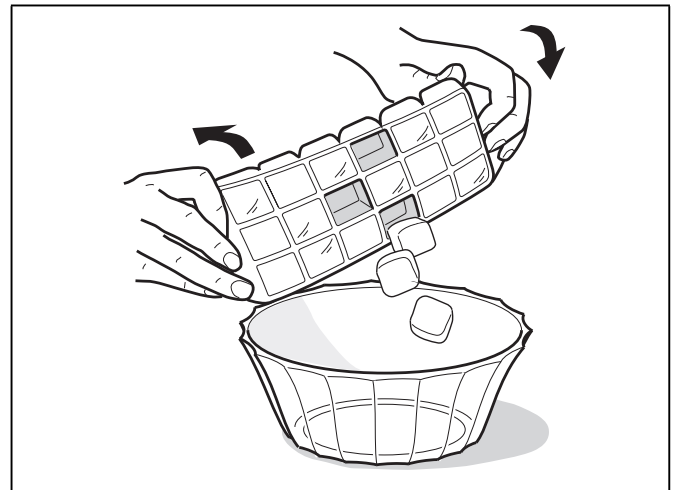

## Ice pack

(if enclosed, quantity varies)

If a power failure or malfunction occurs, the ice packs can be used to slow down the thawing process. The longest storage time is obtained by placing the ice pack directly on the food in the top compartment.

The ice pack can also be used to cool food temporarily, e.g. in a cold bag.

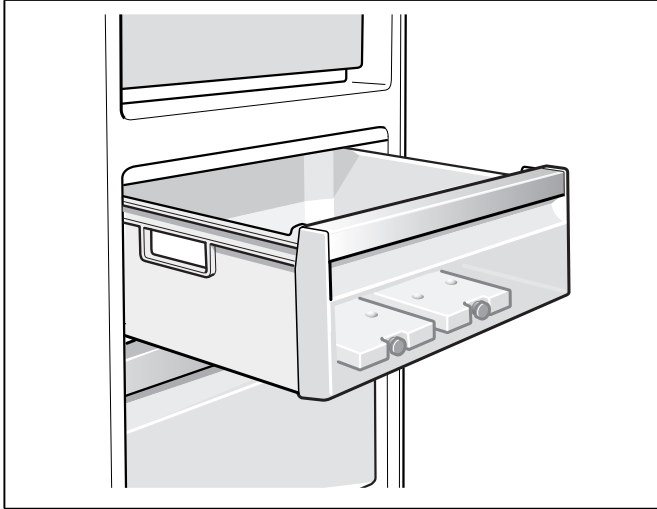

---

## Switching off and disconnecting the appliance

---

### Switching the appliance off

Press the On/Off button (⏻).

Temperature display goes out, refrigeration unit switches off.

### Disconnecting the appliance

If you do not use the appliance for a prolonged period:

1. Switch off the appliance.
2. Pull out mains plug or switch off fuse.
3. Clean the appliance.
4. Leave the appliance door open.

---

## Defrosting

---

### Refrigerator and “cool-fresh” compartments

While the appliance is running, condensation droplets or frost form on the rear panel of the refrigerator compartment. As the rear panel defrosts automatically, it is not necessary to remove the frost or the condensation droplets. The condensation runs through the condensation channel and the drainage hole to the evaporation pan where it evaporates.

#### Note

Keep the condensation channel and drainage hole clean, so the condensation can drain off.

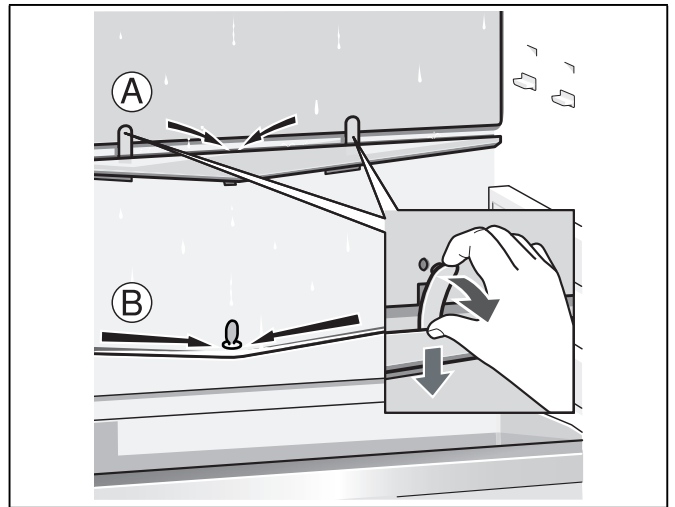

### Freezer compartment

The fully automatic NoFrost system ensures that the freezer compartment remains free of ice. Defrosting is no longer required.



## Cleaning the appliance

### ⚠ Caution

- Do not use abrasive, chloride or acidic cleaning agents or solvents.
- Do not use scouring or abrasive sponges. The metallic surfaces could corrode.
- Never clean the shelves or containers in the dishwasher. The parts may become deformed!

Proceed as follows:

1. Before cleaning: Switch off the appliance.
2. Pull out mains plug or switch off fuse.
3. Take out the food and store in a cool location. Place ice pack (if available) on the food.
4. Wait until the layer of frost has thawed.
5. Clean the appliance with a soft cloth, lukewarm water and a little pH neutral washing-up liquid. The rinsing water must not run into the light or through the drainage hole into the evaporation pan.
6. Wipe the door seal with clear water only and then wipe dry thoroughly.
7. After cleaning reconnect and switch the appliance back on.
8. Put the food back into the appliance.

### Notes

- The water conduction channel A can be taken out for cleaning. Regularly clean the condensation channel and drainage hole B with a cotton bud to ensure that the condensation can drain.

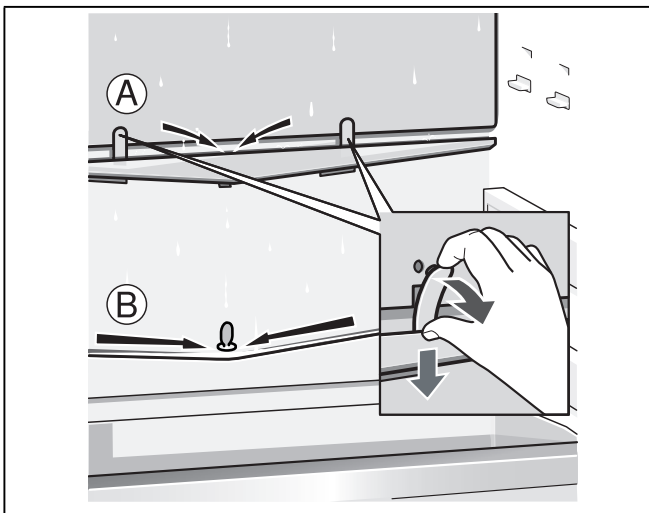

- After cleaning, the stopper must be re-inserted into the drainage hole of the refrigerator compartment for functional reasons.

## Interior fittings

All variable parts of the appliance can be taken out for cleaning.

### Extendable glass shelf

1. Take out serving tray.
2. Detach glass shelf at front by lifting it out of the rails.
3. Lift glass shelf at rear and take out.

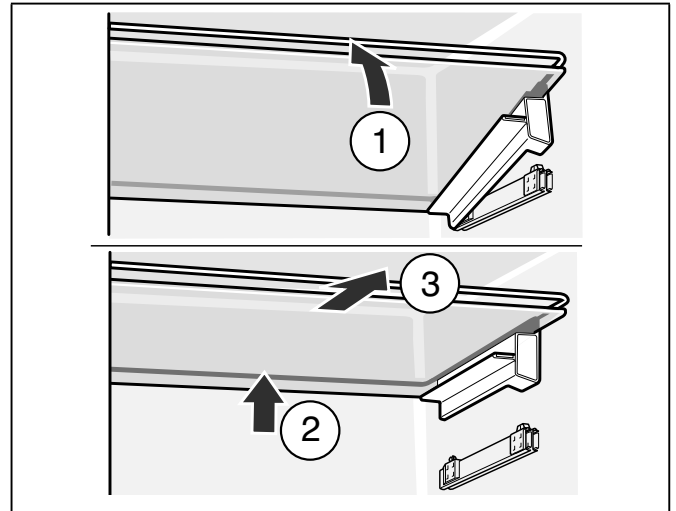

### Note

To insert extendable glass shelf, first place the back of the shelf on the rails, feed it in and then engage at the front.

### Multi-level shelf

To remove the multi-level shelf, lift at the front, pull forwards, lower and swing out to the side.

To insert multi-level shelf, first push into the rear holders and then press down.

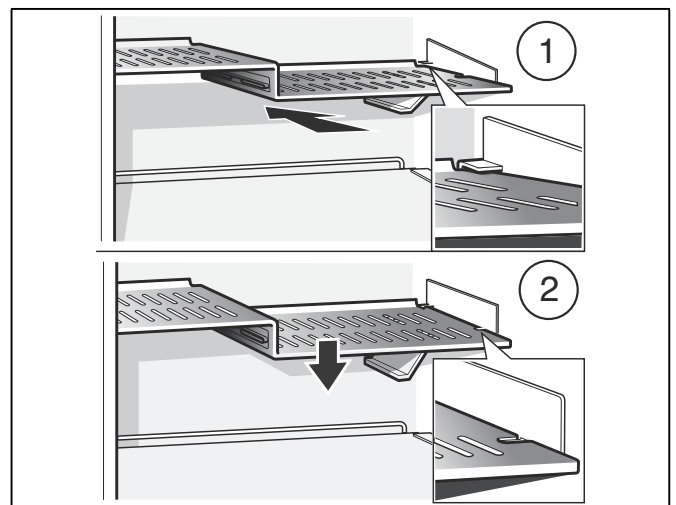

### “Cool-fresh” and humidity container

To remove the container, pull out, tilt forwards and lift.

To insert the container, place the front of the container on the telescopic rails and push into the appliance. The container engages when it is pushed into the appliance.

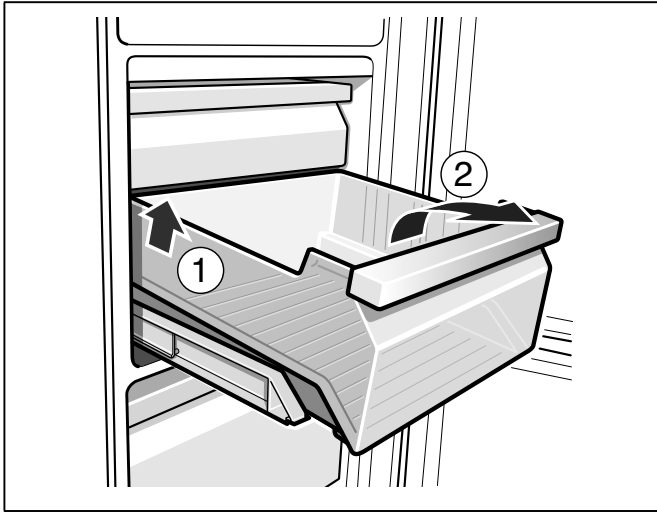

### Remove telescopic rails

1. Pull out extension rail.
2. Push lock in the direction of the arrow.
3. Detach telescopic rail from the rear pin.
4. Push telescopic rail together, push backwards above the rear pin and disengage.

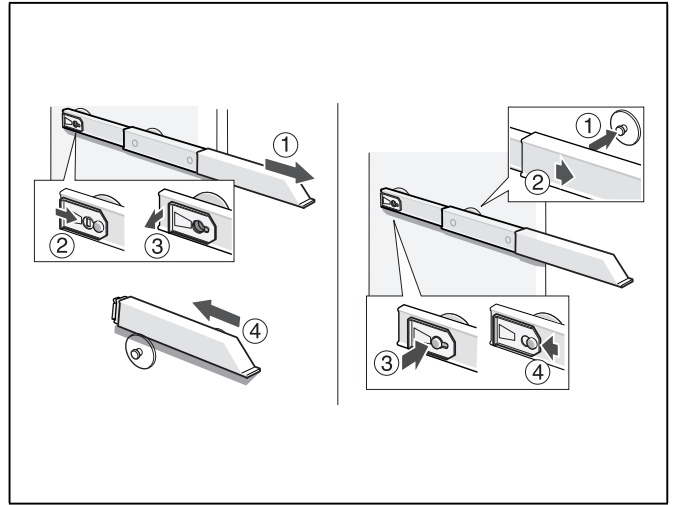

### Taking out the humidity filter

The humidity filter over the humidity container can be taken out for cleaning. To do this, first take out the humidity container and pull out the humidity filter. Lift off the filter cover and take out the filter. Clean in lukewarm water, leave to dry and re-assemble.

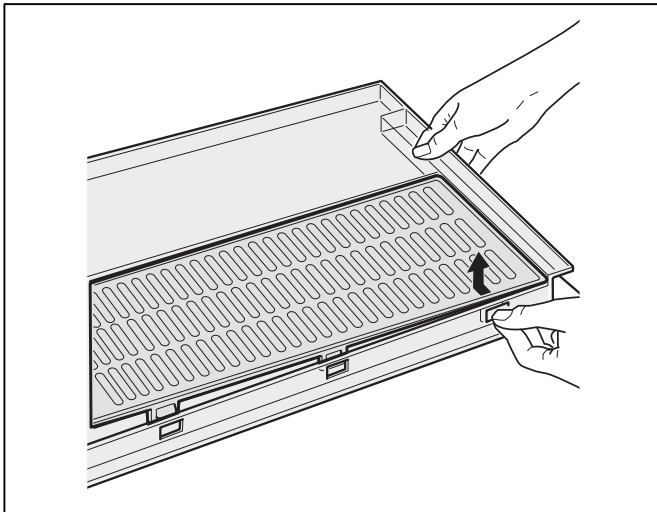

### Installing telescopic rails

1. Place the extended telescopic rail on the front pin.
2. Pull the telescopic rail forwards slightly until it engages.
3. Place telescopic rail on the rear pin.
4. Push lock backwards.

### Taking out the frozen food container

Pull out the frozen food container all the way, lift at the front and remove.

#### Note

To insert the frozen food container with telescopic rails, the rails must be pulled out.

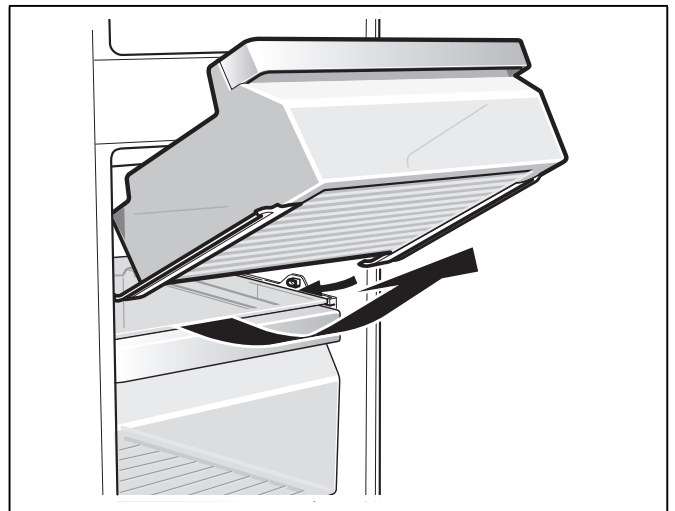

## Door shelf

Raise the door shelf and remove.

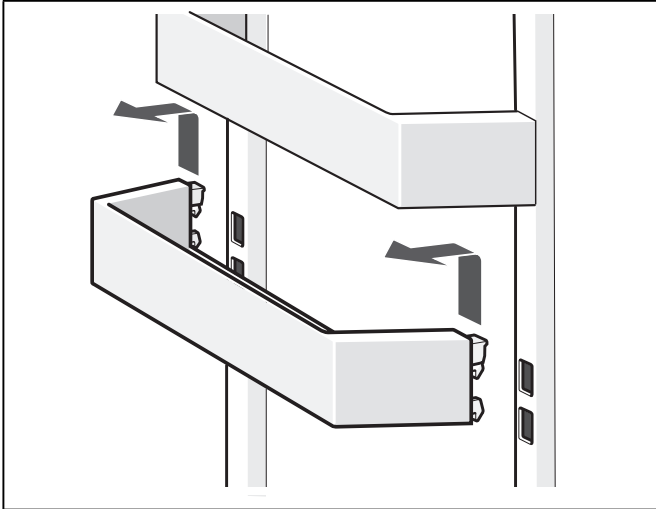

## Odours

If you experience unpleasant odours:

1. Switch off the appliance with the On/Off button ①.
2. Take all food out of the appliance.
3. Clean interior (see chapter "Cleaning the appliance").
4. Clean all packages.
5. Seal strong smelling food in order to avoid odours from forming.
6. Switch on appliance again.
7. Store food in the appliance.
8. Check whether the formation of odours is still occurring after 24hours.
9. Exchange the odour filter.  
The odour filter is located behind the "cool-fresh" container. Replacement filters are available from your customer service.

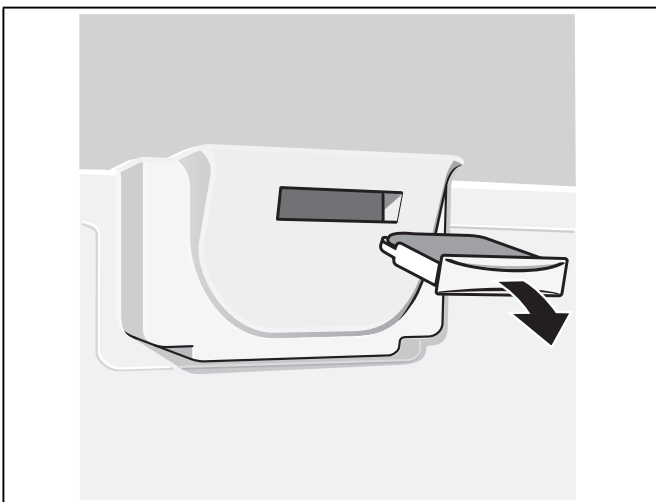

## Light (LED)

Your appliance features a maintenance-free LED light.

These lights may be repaired by customer service or authorised technicians only.

## Tips for saving energy

- Install the appliance in a dry, well ventilated room! The appliance should not be installed in direct sunlight or near a heat source (e.g. radiator, cooker).  
If required, use an insulating plate.
- Allow warm food and drinks to cool down before placing in the appliance.
- Thaw frozen food in the refrigerator compartment and use the low temperature of the frozen food to cool refrigerated food.
- Open the appliance as briefly as possible.
- The ice packs slow down the thawing process of the frozen food in the event of a power failure or malfunction. Place the ice packs directly on the food in the top compartment.
- Ensure that the freezer compartment door is always closed properly.
- The arrangement of the fittings does not affect the energy rating of the appliance.
- To prevent increased power consumption, occasionally clean the ventilation opening with a paint brush or vacuum cleaner.

## Operating noises

### Quite normal noises

#### Droning

Motors are running (e.g. refrigerating units, fan).

#### Bubbling, humming or gurgling noises

Refrigerant is flowing through the tubing.

#### Clicking

Motor, switches or solenoid valves are switching on/off.

#### Cracking

Automatic defrosting is running.

## Preventing noises

### The appliance is not level

Please align the installation cavity with a spirit level. To do this, use the height-adjustable feet of the cavity or place something underneath.

### Containers or storage areas wobble or stick

Please check the removable parts and re-insert them correctly if required.

### Receptacles are touching each other



Move the receptacles slightly away from each other.

## Eliminating minor faults yourself

Before you call customer service:

Please check whether you can eliminate the fault yourself based on the following information.

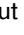
Customer service will charge you for advice – even if the appliance is still under guarantee!

Fault	Possible cause	Remedial action
Temperature differs greatly from the set value.		In some cases it is adequate to switch off the appliance for 5 minutes.  If the temperature is too high wait a few hours and check whether the temperature has approached the set value.  If the temperature is too low check the temperature again the next day.
Floor of the refrigerator compartment is wet.	The condensation channel or drainage hole are blocked.	Clean the condensation channel and the drainage hole. See chapter Cleaning the appliance.
The temperature in the refrigerator compartment is too cold.	Temperature has been set too low.	Increase the temperature.
The refrigerating unit is switching on more frequently and for longer.	Appliance opened frequently.	Do not open the appliance unnecessarily.
	The ventilation openings have been covered.	Remove obstacles.
There is no cooling output from the appliance.	Appliance is switched off.	Press the On/Off button  .
	Power failure	Check whether the power is on.
The lighting does not work.	The fuse has been switched off.	Check mains fuse.
The display does not illuminate.	The mains plug has not been inserted properly.	Check whether the mains plug is secure.
Appliance is not cooling, temperature display and light are lit.	Showroom mode is switched on.	Hold down alarm button  for 10 seconds until an acknowledgement signal sounds.  After a short time check whether your appliance is cooling.
	The LED light is defective.	See chapter "Light (LED)" section.
The light does not function.	Appliance was open too long.	When the appliance is closed and opened, the light is on again.
	Light is switched off after approx. 10 min.	
Temperature display for the refrigerator compartment flashes.	Appliance opened frequently.	Do not open the appliance unnecessarily.
	Too much food was placed in the compartment.	Before placing food in the compartment, press the Fast button  .
	The airing and ventilation openings are blocked.	Remove obstacles.

Fault	Possible cause	Remedial action
The "cool-fresh" compartment is too warm or too cold.	The standard setting has been set too high or too low (e.g. if there is frost in the "cool-fresh" compartment).	The temperature in the "cool-fresh" compartment can be set to be 2 steps warmer and/or colder. If the refrigerator compartment temperature is set to 4, the "cool-fresh" compartment has a temperature of almost 0 °C.  1. Press Fast button on refrigerator compartment * for 3 seconds until a signal sounds. Temperature display on refrigerator compartment flickers. 2. Change the setting using the temperature setting buttons <>. Setting 2 – coldest setting Setting 8 – warmest setting The set temperature is saved after one minute.
Warning signal sounds and the temperature display flashes.  The freezer compartment is too warm! Frozen food is at risk.	Freezer compartment door is open.  Too much food was placed in the freezer compartment at once.	See chapter entitled "Alarm functions".

## Customer service

Your local customer service can be found in the telephone directory or in the customer-service index. Please provide customer service with the appliance product number (E-Nr.) and production number (FD-Nr.).

These specifications can be found on the rating plate.

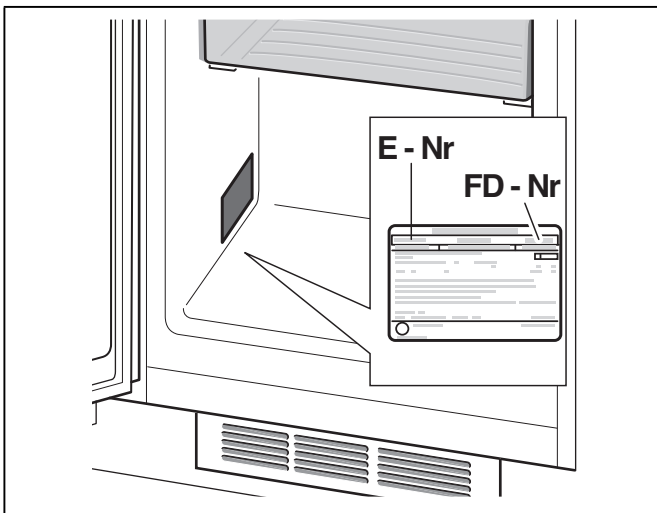

To prevent unnecessary call-outs, please assist customer service by quoting the product and production numbers. This will save you additional costs.

## Repair order and advice on faults

Contact information for all countries can be found on the enclosed customer service list.

GB	0344 892 8988	Calls charged at local or mobile rate.
IE	01450 2655	0.03 € per minute at peak. Off peak 0.0088 € per minute.
US	877 442 4436	toll-free

**Gaggenau Hausgeräte GmbH**  
Carl-Wery-Straße 34  
D-81739 München  
[www.gaggenau.com](http://www.gaggenau.com)

en (9508) 9000910867



**GAGGENAU**