

Gaggenau  
hk 使用說明書  
en User manual

# RB280

組合式冷凍冷藏冰箱  
Fridge-freezer

## hk 目錄

<b>重要安全須知</b>	<b>3</b>	<b>冷凍室</b>	<b>15</b>
請您務必	3	最大冷凍能力	15
爆炸危險	3	請充分利用冷凍容量	15
電擊危險	3	購買冷凍食品	15
凍傷危險	3	請注意食品分類	15
受傷危險	3	將新鮮食物冷凍	15
火災危險 / 冷媒造成的危險	3	將冷凍食品解凍	16
避免造成兒童和身心障礙人士危害的風險	3		
財物損失	4	<b>除霜</b>	<b>16</b>
重量	4	冷藏室	16
		冷凍室	16
<b>使用範圍</b>	<b>4</b>		
		<b>清潔</b>	<b>17</b>
<b>環境保護</b>	<b>4</b>	清潔配件	17
包裝處理	4		
舊機器處理	4	<b>異味</b>	<b>18</b>
<b>安裝與連接</b>	<b>4</b>	<b>照明</b>	<b>18</b>
產品清單	4		
技術資料	5	<b>噪音</b>	<b>18</b>
安裝機器	5	正常噪音	18
夾室尺寸	5	避免噪音	18
並排安裝	5		
節能	5	<b>如何處理故障？</b>	<b>18</b>
第一次使用前	6		
連接電源	6	<b>客戶服務</b>	<b>19</b>
		機器自檢	19
<b>了解本機</b>	<b>7</b>	故障時的送修與服務諮詢	19
機器	7	保修卡	19
控制面板	8		
配件	8		
<b>操作機器</b>	<b>10</b>		
開機	10		
關機並停用	10		
設定溫度	10		
急速冷藏	11		
急速冷凍	11		
假期模式	11		
<b>警報</b>	<b>11</b>		
箱門警報	11		
溫度警報	11		
<b>Home Connect</b>	<b>12</b>		
建立 Home Connect	12		
安裝 Home Connect 軟體更新	13		
資料保護的提示說明	13		
符合性聲明	13		
<b>冷藏室</b>	<b>14</b>		
貯存時請注意	14		
請注意冷藏室的冷卻區	14		
配有濕度調節器的蔬果盒	14		

## ⚠ 重要安全須知

本機符合電器相關的安全規定，並採取有效措施抑制無線電干擾。

製冷迴路已經過洩漏測試。

### 請您務必

- 詳閱並遵循使用暨安裝說明書。說明書中有關於機器重要的安裝、使用以及保養等資訊。
- 對於因忽略使用暨安裝說明書中的提示說明和警告而不當使用機器，製造商概不承擔任何責任。
- 請保留這些說明文件以便日後參考，若冰箱所有權變更，說明文件請一併轉讓。

### 爆炸危險

- 請勿在裝置內使用電氣設備（比如加熱器或電子製冷器）。
- 請勿在裝置內存放含可燃推進氣體（比如噴罐）的產品以及易爆物質。
- 請務必密封、豎立放置高濃度酒精。
- 根據生產商的說明，請勿進行加速除霜的額外措施。

### 電擊危險

不當安裝和維修可能造成用戶相當大的危險。

- 安裝本機時，請確保電源線未受到擠壓或損壞。
- 若電源線損壞：請立即切斷機器的電源。
- 請勿使用複式插座、延長線或轉接器。
- 機器僅能由製造商、客戶服務或受過類似資格的人員進行維修。
- 僅限使用製造商所提供的原廠零件。

這些零件皆由製造商保證符合安全要求之規定。

### 凍傷危險

- 請勿立即食用從冷凍室取出的冷凍食品。
- 避免皮膚接觸冷凍室的冷凍食品、冰塊以及配管時間過長。

### 受傷危險

罐裝的碳酸飲料可能有爆裂的危險。請勿將罐裝的碳酸飲料貯存在冷凍室。



### 火災危險 / 冷媒造成的危險

製冷迴路的配管內流有少量、環保但可燃的冷媒（R600a）。它不會破壞大氣的臭氧層，也不會提高溫室效應。若冷媒外洩，可能造成眼睛受傷或燃燒的危險。

- 請勿損壞冷媒配管。

若冷媒配管損壞：

- 請將機器週遭的明火或火源移除。
- 請保持空間通風順暢。
- 關機並拔掉電源插頭。
- 請聯絡客戶服務。

### 避免造成兒童和身心障礙人士危害的風險

危害對象包括：

- 兒童、
- 有身心或感官障礙的人士、
- 對機器安全操作無足夠知識的人士。

措施：

- 確保兒童和身心障礙的人士能了解危險。
- 兒童及身心障礙人士只能在對其安全負責的人員監督或指導下操作本機。
- 僅限 8 歲以上的兒童使用本機。
- 請監督兒童清潔及保養本機。
- 請勿讓兒童玩弄本機。

## 窒息的危險

- 若機器配有門鎖：請將鑰匙放在兒童無法取得的位置。
- 請勿讓兒童接近包裝材料及其零件。

## 財物損失

為避免財物損失：

- 請勿倚靠或踏在底座、貯藏室或箱門上。
- 請保持塑膠零件及箱門封條處無油脂。
- 拔插頭時，請勿直接拉電源線。

## 重量

請注意機器的安裝和運輸，機器重量非常重。

→ "安裝地點" 第 5 頁

---

## 使用範圍

---

使用本機

- 僅限於食物的冷藏和冷凍及製冰。
- 僅限家庭及非商業環境使用。
- 僅按照本說明書之規定使用。

本機適合在海拔最高 2,000 公尺以下使用。

---

## 環境保護

---

### 包裝處理

所有的包裝材料均為可回收的環保材質：

- 請以環保的方式處理廢棄包裝材料。
- 請向經銷商或環保管理單位洽詢適當處理的方式。

### 舊機器處理

藉由環保處理可回收有利用價值的原物料。

**⚠ 警告 – 兒童可能會將自己鎖在機器內，並有窒息的危險！**

- 請勿讓兒童攀爬機器，否則造成層板和貯藏盒無法取出。
- 請勿讓兒童靠近舊機器。

**注意！**

**冷媒和有害氣體可能會外洩。**

請勿損壞冷媒迴路的配管及絕緣體。

- 1 拔下電源插頭。
- 2 切斷電源線。
- 3 請將廢棄機器進行專業回收。

 本機器已根據歐盟法令 2012/19/EU 關於電氣和電子設備之規定（報廢電子電氣設備，WEEE）進行了標記。

此歐盟指令內容為歐洲地區舊機回收再利用的規定。

---

## 安裝與連接

---

### 產品清單

開箱後，請檢查所有零件是否在運輸途中發生損壞。

若您發現問題，請聯絡您購買機器的經銷商或者聯絡本公司客戶服務。

→ "客戶服務" 第 19 頁

產品清單應包含下列部分：

- 嵌入式機器
- 配件（依機型而定）
- 安裝零件
- 使用說明書
- 安裝說明書
- 客戶服務手冊
- 保修卡
- 關於耗電量和噪音的資訊

## 技術資料

有關冷媒、淨容量以及其他技術信息，請查看規格銘板的說明。

→ "了解本機" 第 7 頁

## 安裝機器

### 安裝地點

機器的冷媒越多，安裝機器的空間也要越大。若安裝空間過小，冷媒外洩時便會產生可燃的混合氣體。

每 8 公克的冷媒，安裝空間至少就要多出 1 立方公尺。您機器上的冷媒量顯示在位於機器內部的規格銘牌上。

→ "了解本機" 第 7 頁

機器的重量將視機型而定，最重可達 75 kg。

### 允許的室內溫度

允許的室內溫度取決於機器的氣候類別。

請參考規格銘牌上對於氣候類別的說明。

→ "了解本機" 第 7 頁

氣候類別	允許的室內溫度
SN	+10 °C ... 32 °C
N	+16 °C ... 32 °C
ST	+16 °C ... 38 °C
T	+16 °C ... 43 °C

本機在所允許的室內溫度下，運轉功能才會齊全。

若機器屬於氣候類別 SN，卻安裝在較低的室內溫度下，可能造成機器損壞，除非將室內溫度提高 5 °C 才能排除危害。

## 夾室尺寸

### 室角深度

建議機器需要 56 公分的室角深度。若室角深度較淺，至少 55 公分時，將使能源消耗略有增加。

### 夾室寬度

對於該裝置，傢俱夾室的內部寬度至少為 56 釐米。在出現偏差的情況下可能會在裝置安裝時出現問題。

## 並排安裝

並排安裝機器時，間隔應至少維持 15 公分。

## 節能

若您遵循以下提示說明，您的機器將節省更多能源。

**提示：** 配件安裝位置不得影響機器的能源消耗。

### 安裝機器

機器應避免陽光直射。

安裝機器儘可能遠離加熱器、爐灶以及其他熱源：

與電磁爐或瓦斯爐需保持 3 公分的距離

與油爐或煤爐需保持 30 公分的距離

**提示：**

若無法達到該要求，請在機器和熱源之間安裝絕緣板。

選擇安裝地點的室溫約 20 °C。

請利用室角深度 56 公分的地點。

**注意！**

**燙傷的危險！**

各個零件在機器運轉時會發熱。觸摸這些零件會導致燙傷。

請勿將通風口覆蓋或堵塞。

平常請保持空間通風。

本機在環境溫度較低的地方啟動製冷才比較不頻繁，並藉此減少耗電量。

位在機器背板的空氣會稍微發熱。若吸去該處的熱空氣，機器的耗電量更低。

## 使用機器

箱門開啟時間盡量縮短。

請從保冷袋中取出購買的食物，並迅速放入冰箱內。

請先讓熱食和熱飲冷卻，然後再放入冰箱內。

放入冷藏室解凍的冷凍食品，可利用冷凍食品本身的低溫幫助冷藏室保持溫度。

請在食物和冰箱後壁之間留有一定的空間。

將食物密封包裝。

請勿將通風口覆蓋或堵塞。

機器內的空氣升溫緩慢。機器啟動製冷運轉較少，耗電量也會減少。

空氣循環和濕度皆保持恆定。機器啟動製冷運轉較少，耗電量也會減少。

位在機器背板的空氣會稍微發熱。若吸去該處的熱空氣，機器的耗電量更低。

## 第一次使用前

- 1 請拿出相關資料，並將膠帶以及保護膜移除。
- 2 清潔機器。  
→ "清潔" 第 17 頁

## 連接電源

### 注意!

請勿將機器連接至電力節能插座。

**提示：**可將機器與有源逆變器和正弦換向逆變器連接。使用有源逆變器可在光伏系統上與公共供電系統直接連接。單獨使用時，必須使用正弦換向逆變器。可在船舶或山間小屋等地方單獨使用，因為無法直接連接到公共供電系統上。

- 1 機器安裝後，請等待約 1 小時再進行電源連接，以避免損害壓縮機。
- 2 請將機器電源連接至正確安裝的插座上。插座必須符合下列數據：

插座類型 220 V ... 240 V

接地保護裝置 50 Hz

保險絲 10 A ... 16 A

歐洲以外的地區：檢查機器所提供的額定電流類型是否匹配當地的供電系統。規格銘牌上提供關於本機的相關資料。

→ "了解本機" 第 7 頁

- 3 電源插座必須安裝在本機附近。安裝本機後也須易於接近插座。

### 警告 – 觸電危險!

若電源線長度不足，切勿使用複式插座或延長線。請聯絡客戶服務，諮詢合適的替代方案。

## 了解本機

本機使用說明書適用於多種機型。圖示可能會有偏差。

## 機器

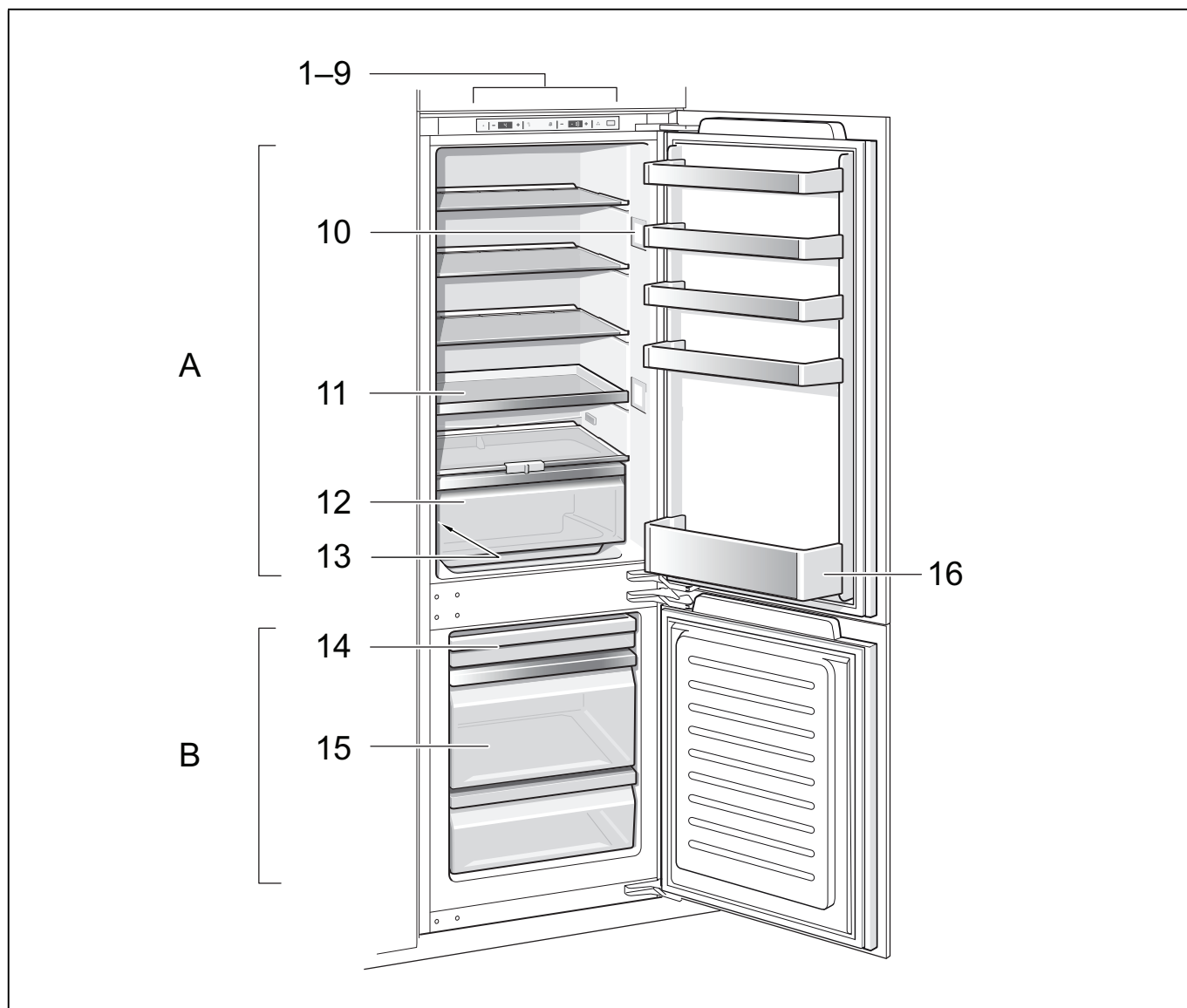

\* 並非所有機型。

A	冷藏室	14*	冷凍抽屜
B	冷凍室	15	冷凍貯藏盒
1-9	控制面板	16	高瓶層架
10	照明		
11	抽取式層板		
12	配有濕度調節器的蔬果盒		
13	規格銘牌		

## 控制面板

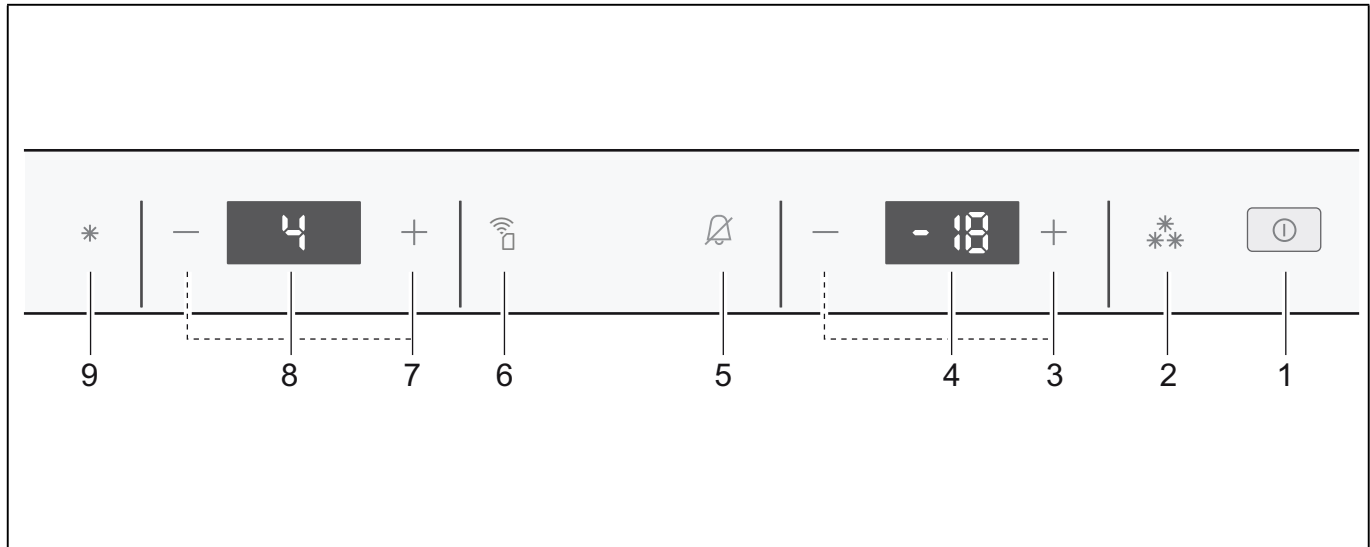

- 1 按鍵 ① (警報)  
開啟或關閉機器。
- 2 按鍵 \*\*\* (急速冷凍)  
開啟或關閉急速冷凍。
- 3 按鍵 - / + (急速冷凍)  
設定冷凍室的溫度。
- 4 冷凍室溫度顯示  
將以 °C 顯示設定的溫度。
- 5 按鍵 🔔 (警報)  
關閉警示音。
- 6 按鈕 📶  
開啟或關閉 Home Connect。
- 7 按鍵 - / + (急速冷藏)  
請設定冷藏室的溫度。
- 8 冷藏室溫度顯示  
將以 °C 顯示設定的溫度。
- 9 按鍵 \* (急速冷藏)  
關閉或開啟急速冷藏。

## 配件

(並非所有的機型)

### 層板

您可變換層板：

- 向外拉出並取下層板。

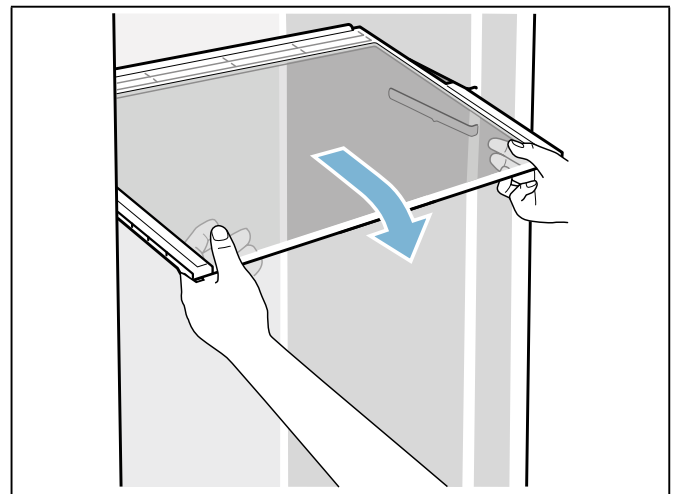



### 抽取式層板

您可查看一覽表：

- 向外拉出層板。

您可將層板完全取下：

- 1 請按住層板下方兩個按鈕。
- 2 向外拉出層板，向下放低，然後晃動兩側即可拉出。

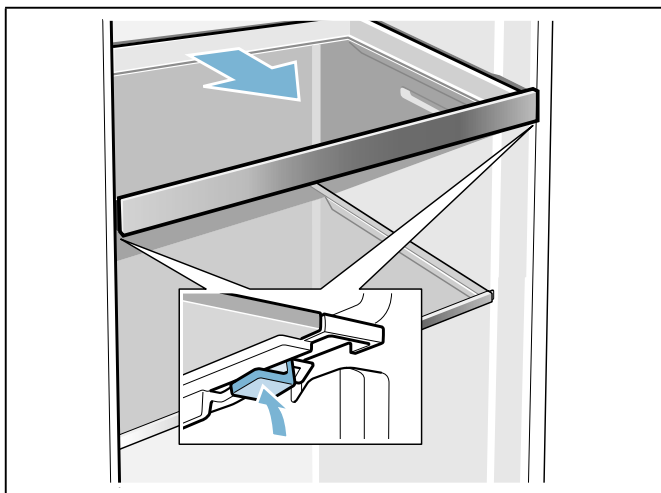

### 葡萄酒和香檳瓶架

可將酒瓶放置在瓶架上固定：

- 向下折疊金屬托架。

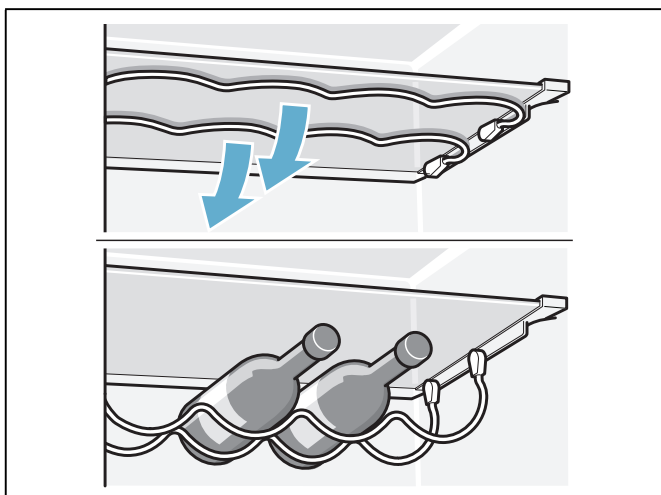

### 貯藏盒

您可取出貯藏盒：

- 拉出貯藏盒直到其停止，往前提起，然後取出。

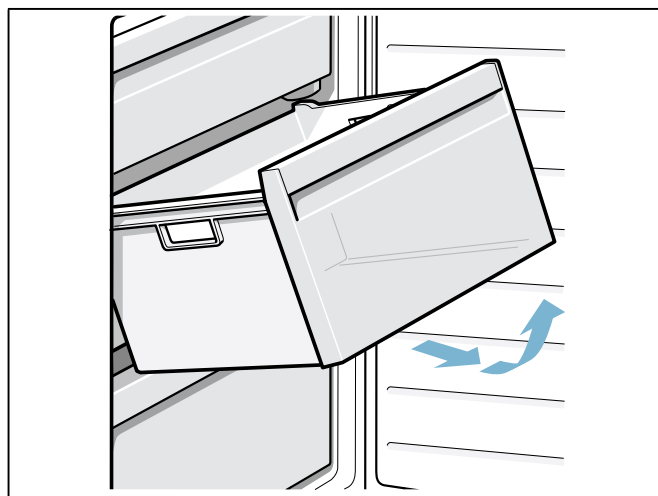

### 層架

您可以取出層架：

- 將層架往上提高，然後取出。

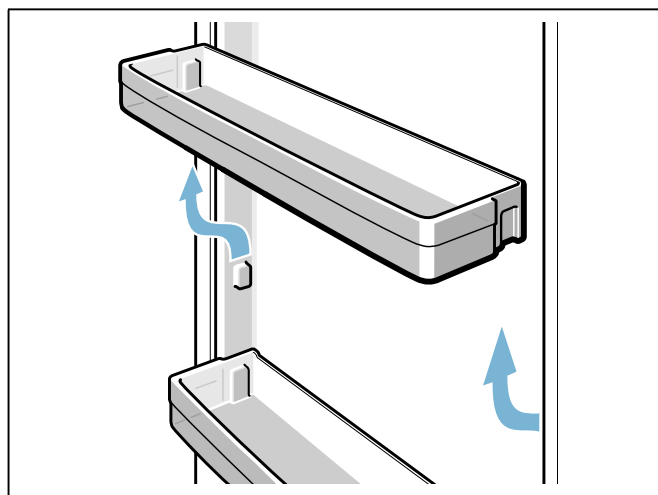

## 瓶罐夾

開關箱門時：

- 瓶罐夾可防止瓶罐傾斜。

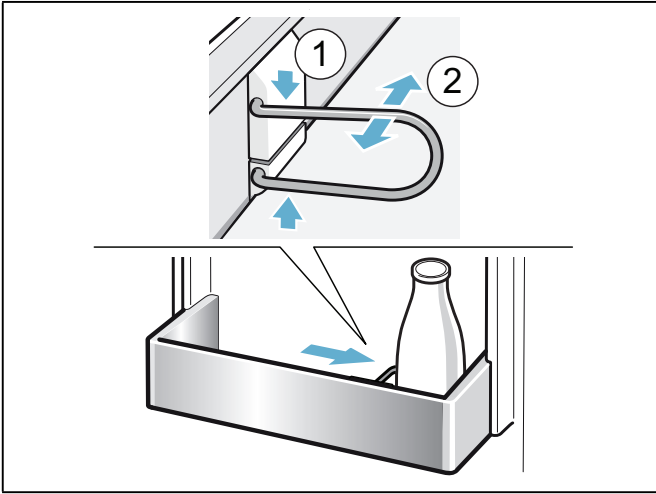

## 製冰盒

準備製冰：

- 1 請將製冰盒裝滿 3/4 的水，然後放入冷凍室。  
提示：凍硬的製冰盒僅能使用鈍器處理（例如湯瓢）。
- 2 只要將製冰盒沖一下水或稍微扭動，即可取出冰塊。

## 蓄冷器

若電源中斷或故障：

- 蓄冷器將延緩已貯存的冷凍食品溫度升高。

提示：若您將蓄冷器放入上層隔室，食物將達到最長的保存期限。

您可取出蓄冷器，暫時將食物保持低溫，例如可放入保冷袋中。

## 操作機器

### 開機

- 1 觸按按鍵 ①（警報）。  
機器開始啟動製冷。警示音、冷凍室的溫度顯示閃爍以及按鍵 ⚠（警報）亮起，顯示冷凍室的溫度仍不冷。
- 2 觸按按鍵 ⚠（警報）。  
關閉警示音。
- 3 設定所需的溫度。  
→ "設定溫度" 第 10 頁

### 操作提示說明

- 開機後，可能需要數小時，才能達到所設定的溫度。達到所設定的溫度前，請勿將食物放入。
- 全自動 NoFrost 系統讓冷凍室保持無冰。無需除霜。
- 箱體正面會部分稍微發熱。這可防止門封條上出現凝結的水珠。
- 若冷凍室的門在關閉後，不能重新立即打開：請稍等片刻，直到所產生的真空抵銷為止。

## 關機並停用

### 關機

- 觸按按鍵 ①（警報）。  
機器不再製冷。

### 停用機器

若長時間不使用機器：

- 1 觸按按鍵 ①（警報）。  
機器不再製冷。
- 2 將電源插頭拔出或關閉保險絲。
- 3 清潔機器。
- 4 敞開機器。

## 設定溫度

### 建議溫度

冷藏室： +4 °C

冷凍室： -18 °C

## 冷藏室

- 連續按下按鍵 - / +，直到顯示面板顯示所需的溫度。

## 冷凍室

- 連續按下按鍵 - / +，直到顯示面板顯示所需的溫度。

## 標籤 OK (確定)

(並非所有的機型)

利用標籤 OK (確定)，可檢查冷藏室是否達到所建議的食品安全溫度範圍 +4 °C 以下。

若標籤無顯示 OK (確定)，應將溫度逐步調低。

首次啟動機器後，需至少持續運行 12 個小時，直到設定的溫度達到為止。

## 正確設定



## 急速冷藏

急速冷藏一旦被啟動，冷藏室會儘可能地降到低溫。

何時可開啟急速冷藏，例如：

- 放入大量食物之前
- 飲料需要快速冰鎮時

**提示：**若將急速冷藏開啟，噪音會因此增加。

經過約 15 小時後，急速冷藏將自動關閉，機器繼續以正常模式運轉。

開啟 / 關閉急速冷藏：

- 觸按按鍵 \*。
- 若將急速冷藏開啟，按鍵將亮起。

## 急速冷凍

急速冷凍一旦被啟動，冷凍室會儘可能地降到低溫。

何時可開啟急速冷凍，例如：

- 為了讓食物能夠快速結凍
- 啟動急速冷凍 4 ... 6 小時後，才能放入 2 公斤以上的食物量
- 發揮最大冷凍能力

**提示：**若將急速冷凍開啟，噪音會因此增加。

經過 2 ½ 天以後，機器將繼續以正常模式運轉。

開啟 / 關閉急速冷凍：

- 觸按按鍵 \*\*。
- 若將急速冷凍開啟，按鍵將亮起。

## 假期模式

若外出時間較長，可將機器切換至節能的假期模式。

冷藏室的溫度將自動切換到 +14 °C。

請勿在此期間將食物貯存於冷藏室中。

冷凍室的溫度不變。

開啟假期模式：

- 連續觸按保鮮格按鈕 +，直到顯示面板顯示 8 Ho。
- 若開啟假期模式，冰格溫度顯示面板則不再顯示溫度。

關閉假期模式：

- 連續觸按保鮮格按鈕 -，直到顯示面板 8 顯示所需的溫度。

## 警報

### 箱門警報

若箱門打開時間過長，箱門警報會自動發出警報聲。

- 請將箱門關上或觸按按鍵 ⚡ (警報)。
- 將警示音關閉。

### 溫度警報

若冷凍室溫度偏高，將發出溫度警報。

**注意！**

解凍時會產生細菌，冷凍食品可能變質

請勿將半解凍或已解凍的冷凍食品重新冷凍。

只有將食物烹煮或油炸後才能重新冷凍。食物的最長貯存時間則完全無法再適用。

**提示：**警報會在冷凍食品未變質的下列情況下自動開啟：

- 啟用本機。
- 貯存大量新鮮食物。
- 冷凍室門打開時間過長。

顯示冰箱最高溫度並關閉警示音：

- 觸按按鍵 ⚡ (警報)。

顯示面板將短暫顯示冷凍室的最高溫度。之後再顯示設定的溫度。

從這時起，將重新偵測最高溫度並儲存。

**提示：**按鍵 ⚡ (警報) 亮起，直到溫度重新達到設定的溫度為止。

## Home Connect

本機具有無線 Wi-Fi 功能，可用行動終端裝置進行遙控。

**提示：**無線 Wi-Fi 是 Wi-Fi Alliance 的品牌。

本機在下列情況下如同一台沒有網路連線功能的冷藏電器，仍然可以透過控制面板手動操作：

- 本機未與家用網路連線。
- 在機器安裝的國家沒有提供 Home Connect 的服務。有關提供 Home Connect 的國家一覽，請至 [www.home-connect.com](http://www.home-connect.com) 查詢。

**提示：**請仔細閱讀本使用說明書中的重要安全須知。請確保，當您透過 Home Connect APP 操作本機以及出門在外進行同樣操作時，也應遵守使用說明書的安全注意事項。→ "重要安全須知" 第 3 頁  
同時，請您也注意在 Home Connect APP 的提示說明。

## 建立 Home Connect

### 提示

- 請注意 Home Connect 的補充說明，您可以從 [www.gaggenau.com](http://www.gaggenau.com) 的使用手冊中將其下載。請在該處將您的機器型號 (E-Number) 輸入搜尋欄位內。
- 開機後請至少等待兩分鐘，直到內部機器初始化完成。如此才能建立 Home Connect。
- 為了進行具有 Home Connect 的設定，必須將 Home Connect APP 安裝在您的流動終端裝置上。請注意隨附的 Home Connect 文件。請按照 APP 所提供的步驟進行設定。
- 若長時間未操作本機，Home Connect 選單會自動關閉。有關打開 Home Connect 選單的提示說明，請參閱相應章節的開頭處。

### 自動連結至家用網路 (WLAN)

若 WLAN 路由器具有 WPS 功能，本台雪櫃可以自動連結至家用網路。

- 1 觸按按鈕 。  
保鮮格溫度顯示面板將顯示 **Cn**。
- 2 連續觸按保鮮格按鈕 - / +，直到保鮮格溫度顯示面板顯示 **AC** 且冰格溫度顯示面板顯示 **OF**。
- 3 觸按冰格按鈕 - / +。  
本機已準備進行自動連結。  
冰格溫度顯示面板將顯示持續 2 分鐘的動畫。  
一旦出現動畫，本機已準備進行自動連結。
- 4 請在接下來的 2 分鐘內，啟動家用網路路由器上的 WPS 功能 (例如透過 WPS/WLAN 按鈕，有關詳細信息，請注意路由器的文件)。  
連結成功時，在冰格溫度顯示面板上將閃爍 **On**。  
本台雪櫃已準備連結至 APP。

**提示：**若冰格溫度顯示面板顯示 **OF**，則連結未建立。

- 1 請檢查本台雪櫃是否在家用網路的覆蓋範圍內 (WLAN)。
- 2 重複該步驟或進行手動連結。

### 手動連結至家用網路 (WLAN)

若現有的 WLAN 路由器沒有 WPS 功能或您對此一無所知，您可以將本台雪櫃手動連結至家用網路。

- 1 觸按按鈕 。  
保鮮格溫度顯示面板將顯示 **Cn**。
- 2 連續觸按保鮮格按鈕 - / +，直到保鮮格溫度顯示面板顯示 **SA** 且冰格溫度顯示面板顯示 **OF**。
- 3 觸按冰格按鈕 - / +。  
本機已準備進行手動連結。  
冰格溫度顯示面板將顯示動畫。  
一旦出現動畫，本機已準備進行手動連結。
- 4 本台雪櫃現在已建立一個擁有網路名稱 HomeConnect 的自有 WLAN 網路。  
您現在可以透過流動終端裝置存取該網路。
- 5 在流動終端裝置的設定選單中可以檢索 WLAN 設定。
- 6 流動終端裝置連結至 WLAN 網路 HomeConnect。  
密碼: HomeConnect  
連結過程可能長達 60 秒。
- 7 連結成功後，開啟流動裝置上的 Home Connect APP。  
APP 將搜索本台雪櫃。
- 8 一旦搜索到本台雪櫃，請在相應的欄位輸入自有家用網路 (WLAN) 的網路名稱 (SSID) 和密碼 (Key)。
- 9 觸按按鈕確認 **傳輸至家用電器**。
  - 連結成功時，在冰格溫度顯示面板上將閃爍 **On**。  
您現在可以將本台雪櫃連結至 APP。
  - 若冰格溫度顯示面板顯示 **OF**，則未建立連結。  
請檢查本台雪櫃是否在家用網路的覆蓋範圍內 (WLAN)。  
重複該步驟。

### 雪櫃連結至 Home Connect APP

- 1 觸按按鈕 。  
保鮮格溫度顯示面板將顯示 **Cn**。
- 2 連續觸按保鮮格按鈕 - / +，直到保鮮格溫度顯示面板顯示 **PA** 且冰格溫度顯示面板顯示 **OF**。
- 3 觸按冰格按鈕 - / +，將本機連結至 APP。  
冰格溫度顯示面板將顯示動畫。  
一旦雪櫃連結至 APP，冰格溫度顯示面板將顯示 **On**。
- 4 打開 APP 並等候直到本台雪櫃顯示為止。  
透過 **增添** 確認 APP 和雪櫃之間的連結。  
若本台雪櫃未自動顯示，請在 APP 點擊 **增添電器** 並遵守指示說明進行操作。一旦您的雪櫃顯示，請透過 **+** 進行增添。

- 5 遵守 APP 的指示說明，直到程序結束為止。  
保鮮格溫度顯示面板將顯示 **PA** 且冰格溫度顯示面板將顯示 **On**。  
本台雪櫃已連結至 APP。  
若連結失敗，請檢查流動終端裝置是否連結至家用網路 (WLAN)。  
然後重複連結過程。  
若在冰格溫度顯示面板顯示 **Er**，請重設 Home Connect 設定。

**提示：**重設時，所有 Home Connect 設定將重設。

### 檢查信號強度

若連結未起作用，您應該檢查信號強度。

- 1 觸按按鈕 。  
保鮮格溫度顯示面板將顯示 **Cn**。
- 2 連續觸按保鮮格按鈕 **- / +**，直到保鮮格溫度顯示面板顯示 **SI**。在冰格溫度顯示面板中將顯示介於 0 (無接收) 和 3 (全接收) 的數值。  
信號強度應至少為 2。若信號強度太弱，連結可能被中斷。
  - 請您將路由器與雪櫃的距離靠近一些。
  - 確保不因牆壁的屏蔽，而使連結受到干擾。
  - 或安裝一個中繼器來放大信號。

### 重設 Home Connect 設定

若在試圖建立連結時出現問題，或您希望將本機登入另一個家用網路 (WLAN)，您可以重設 Home Connect 設定。

- 1 觸按按鈕 。  
保鮮格溫度顯示面板將顯示 **Cn**。
- 2 連續觸按保鮮格按鈕 **- / +**，直到保鮮格溫度顯示面板顯示 **rE** 且冰格溫度顯示面板顯示 **OF**。
- 3 觸按冰格按鈕 **- / +**。  
冰格溫度顯示面板將顯示持續 15 秒的動畫。  
然後冰格溫度顯示面板將顯示 **OF**。  
該 Home Connect 設定已重設。

## 安裝 Home Connect 軟體更新

請定期檢查雪櫃，是否有用於 Home Connect 的軟體更新。

若有可使用的更新，保鮮格溫度顯示面板將顯示 **UP**。

觸按任一按鈕，顯示面板將恢復到設定的溫度。

安裝更新：

- 1 觸按按鈕 。  
保鮮格溫度顯示面板將顯示 **Cn**。
- 2 連續觸按保鮮格按鈕 **- / +**，直到保鮮格溫度顯示面板顯示 **UP** 且冰格溫度顯示面板顯示 **OF**。

- 3 觸按冰格按鈕 **- / +**。  
冰格溫度顯示面板將顯示動畫。  
軟體更新正在安裝。  
安裝過程中，所有按鈕均被鎖定。
  - 若安裝成功完成，冰格溫度顯示面板將顯示 **On**。
  - 若安裝未成功完成，冰格溫度顯示面板將顯示 **Er**。  
稍後將重新啟動更新。  
若多次嘗試後都無法完成安裝，請聯絡客戶服務。

## 資料保護的提示說明

您的 Home Connect 機器將在第一次利用與網際網路連線的 WLAN 無線網路時，將傳輸下列各類資料至 Home Connect 伺服器 (首次註冊)：

- 唯一機器標識符 (包括機器密鑰和已安裝的無線 Wi-Fi 通信模組的 MAC 地址)。
- 無線 Wi-Fi 通信模組的安全證書 (資訊技術的連線保障)。
- 您家電目前的軟體和硬體版本。
- 將之前任何的狀態恢復至出廠設定值。

此首次註冊是準備提供給 Home Connect 功能使用，並在您第一次使用 Home Connect 功能時才會被啟用。

**提示：**請注意，Home Connect 功能只有在連線至 Home Connect APP 時才能使用。您可在 Home Connect APP 中調出資料保護的相關資訊。

## 符合性聲明

嘉格納家用電器有限公司 (Gaggenau Hausgeräte GmbH) 在此嚴正聲明，配有 Home Connect 功能的家電符合指令 2014/53/EU 的基本要求以及其他相關的規定。

有關詳細的 RED 符合性聲明，您可以上網在 [www.gaggenau.com](http://www.gaggenau.com) 您的家電產品頁面中的其他文件查看相關資訊。



2.4 吉赫茲頻段：最大 100 兆瓦。

## 冷藏室

冷藏室適合貯存肉、香腸、魚、乳製品、蛋、熟食以及烘焙食品。

溫度可以設定在 +2 °C ... +8 °C 之間。

冷藏室的貯存可使非常容易變質的食物保存一段時間。所設定的溫度越低，透過微生物的酶、化學物以及變質的作用越慢。+4 °C 以下的溫度能維持食物的最佳新鮮度和貯存安全。

### 貯存時請注意

- 請貯存新鮮的、完整的食物。  
使新鮮度和品質保留更長的時間。
- 在即食食品和瓶裝食品方面，請勿超過製造商所規定的保存期限或使用期限。
- 為了保持風味、色澤和新鮮度，請將食物妥善包裝或覆蓋貯存。  
此外，請避免使用會殘留食物味道和變色的塑膠件。
- 請先將熟食和熱飲冷卻，然後才放入冷凍室。

### 請注意冷藏室的冷卻區

冷藏室的空氣循環系統會產生不同的冷卻區。

#### 最冷的區域

最冷的區域是在側邊有浮雕箭頭和位於其下的層板之間。

提示：請將容易變質的食物，例如魚、香腸和肉貯存在最冷的區域。

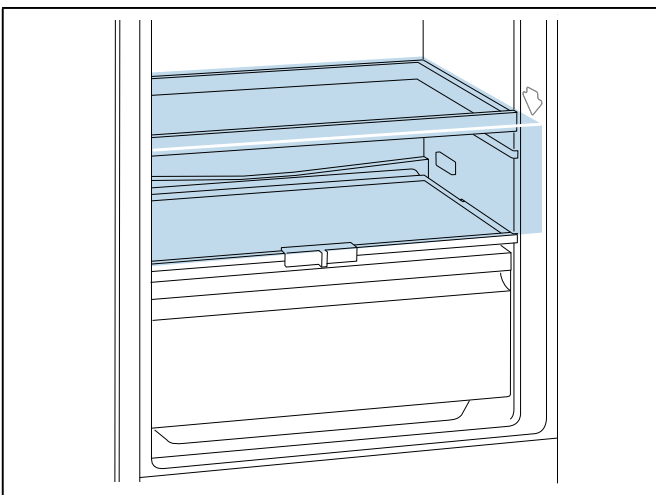

#### 最不冷的區域

最不冷的區域是在箱門整個上部。

提示：請您將硬質乳酪和奶油貯存在最不冷的地區。乳酪放在這裡可讓其風味更佳，奶油則更易塗抹。

### 配有濕度調節器的蔬果盒

蔬果盒是新鮮水果和蔬菜的最佳貯存地點。透過濕度調節器和特殊的密封即可調節蔬果盒的濕度。這將使新鮮水果和蔬菜比起傳統的貯存延長一倍的保存時間。

蔬果盒的濕度可根據食品的種類及數量進行調整：

- 貯存若以水果為主以及貯存量高時，請將濕度調低
- 貯存若以蔬菜為主以及混合貯存或貯存量低時，請將濕度調高

#### 提示

- 為使易凍傷的水果（例如鳳梨、香蕉、木瓜以及柑橘類水果）和蔬菜（例如茄子、黃瓜、美洲南瓜、辣椒、蕃茄以及馬鈴薯）保持最佳品質和風味，冰箱外的貯存溫度應保持在約 +8 °C ... +12 °C 之間。
- 根據貯存量及貯存食物，蔬果盒可能形成冷凝水。可用乾布擦去冷凝水，並以濕度調節器調節蔬果盒的濕度。

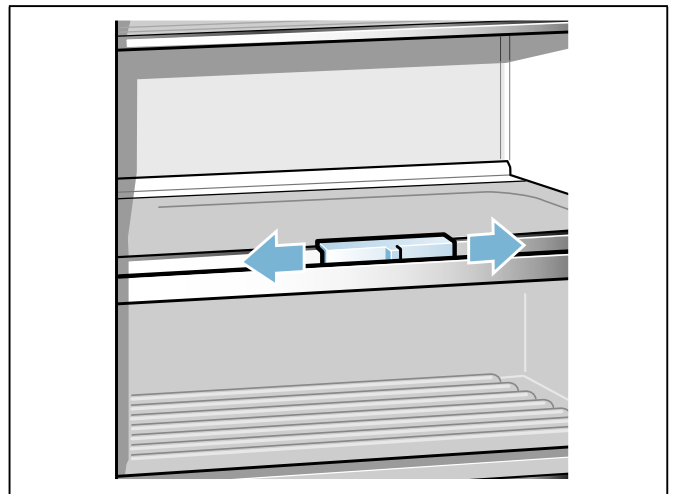

## 冷凍室

冷凍室適合：

- 貯存冷凍食品
- 製冰
- 結凍食物

溫度可以設定在  $-16^{\circ}\text{C}$  ...  $-24^{\circ}\text{C}$  之間。

冷凍室的貯存可使易變質的食物長時間保存，不影響品質的流失，因為低溫會使食物變質放慢或停止。食物外觀、風味以及所有有營養的成分大部分皆得以保留。

食物進行長期貯存溫度應在  $-18^{\circ}\text{C}$  以下。

新鮮食物從貯存到完全結凍之間所花的時間取決於以下因素：

- 設定溫度
- 食物種類
- 冷凍室貯存物
- 貯存量 and 貯存種類

### 最大冷凍能力

最大冷凍能力代表新鮮食物可以在 24 小時所冷凍的最大量。

有關最大冷凍能力，請查看規格銘牌上的說明。

→ "了解本機" 第 7 頁

放入新鮮食物前，可開啟急速冷凍 24 小時，以達到最大冷凍能力。

→ "急速冷凍" 第 11 頁

### 最大冷凍容量的條件

- 1 貯存新鮮食物前約 24 小時：開啟急速冷凍。  
→ "急速冷凍" 第 11 頁
- 2 從冷凍室拉出貯藏盒，並將食物直接貯存層板上，以及冷凍室的底層。
- 3 首先先將食物貯存在上層冷凍室。此處食物可最快結凍。
- 4 若上層冷凍室空間不足，剩餘的食物可存放於下層冷凍室，由右前方開始進行貯存。
- 5 新鮮食物儘量靠近側壁冷凍。

### 請充分利用冷凍容量

達到冷凍食品最大貯存量的方法：

- 取出所有配件。
- 請將食物直接貯存在層板上及冷凍室底層。

## 購買冷凍食品

- 請注意包裝是否損壞。
- 請注意保存期限。
- 超市冷凍櫃的溫度應在  $-18^{\circ}\text{C}$  以下。
- 請勿中斷冷鏈：冷凍食品應儘可能地裝入隔熱袋中攜帶，並迅速地放入冷凍室。

### 請注意食品分類

- 請將份量多的食物放入上層冷凍室。  
此處可讓食物快速結凍。
- 將食物平均放入冷凍室或冷凍貯藏盒中。
- 請勿將已結凍的食物彼此靠在一起。  
必要時，請將貯存在冷凍貯藏盒中已結凍食物重新擺放。
- 注意保持機器通風良好：  
將冷凍貯藏盒推入直到停止。

### 將新鮮食物冷凍

僅將新鮮和無損壞的食物冷凍。

生食經過烹煮、油炸或烘烤後是非常適合冷凍的食物。

冷凍食物前，可根據食物進行備用處理，以獲得最佳的營養價值、風味和色澤：

- 蔬菜類：洗淨、切菜、川燙。
- 水果類：洗淨、去核、去皮，最後可添加糖或抗壞血酸劑。

關於提示說明可查看相關說明書的內容。

### 適合冷凍的食物包括

- 烘焙食品
- 魚類和海鮮
- 肉類
- 野味及家禽食品
- 蔬菜、水果和香草植物
- 去殼雞蛋
- 奶製品，例如乳酪、奶油和凝乳
- 即食食品和剩菜，例如湯、燉菜、熟肉製品、熟魚、馬鈴薯料理、砂鍋菜以及甜點

### 不適合冷凍的食物

- 平時生吃的蔬菜，例如生菜沙拉或小蘿蔔
- 未剝殼的雞蛋或水煮蛋
- 葡萄
- 整顆蘋果、梨子以及桃子
- 優格、酸乳、酸奶油、鮮奶油和蛋黃醬

### 包裝冷凍食品

請選擇合適的包裝和材料，以確保產品的品質，避免食品凍傷的情形產生。

- 1 請將食物放入包裝袋內。
- 2 將袋中的空氣擠壓出去。
- 3 將包裝封口密閉，使食物味道或水分不流失。
- 4 包裝上最好有註明冷凍內容和日期的冷凍標籤。

適合的包裝：

- 塑膠保鮮膜
- 聚乙烯材質的管狀薄膜（PE）
- 鋁箔
- 冷凍保鮮盒

適合的緊固件：

- 橡皮筋
- 塑膠夾
- 耐寒膠帶

不適合的包裝：

- 包裝紙
- 油紙
- 玻璃紙
- 垃圾袋和使用過的購物袋

### 冷凍食品的溫度應保持在 $-18^{\circ}\text{C}$

魚、香腸、即食食品、烘焙食品：	長達 6 個月
家禽、肉類：	長達 8 個月
蔬菜、水果：	長達 12 個月

### 冷凍日曆

打印的冷凍日曆會提供近幾個月來食物持續在  $-18^{\circ}\text{C}$  的溫度下最長的保存期限。

## 將冷凍食品解凍

解凍方法必須配合食物本身和使用目的，才能獲得最佳的產品品質。

解凍方法：

- 放入冷藏室（特別適合肉類食品如魚、肉、乳酪、凝乳）
- 放在室溫下（麵包）
- 微波爐（可即食或立即備用的食品）
- 烤箱／爐灶（可即食或立即備用的食品）

### 注意！

請勿將半解凍或已解凍的冷凍食品重新冷凍。只有經過再處理的熟食（烹煮或煎炸過）才能重新冷凍。

請勿將食物貯存至保存期限為止。

## 除霜

### 冷藏室

冰箱運轉時，將在背板上形成冷凝水或結霜。這是受到功能影響。冷凝水或結霜無需擦拭。後壁將自動除霜。冷凝水將流到冷凝水排放管道。

冷凝水從冷凝水排出通道流到蒸發盤中蒸發。

提示：保持冷凝水排放通道和排水孔的清潔，使冷凝水可以排出，並避免食物產生氣味。

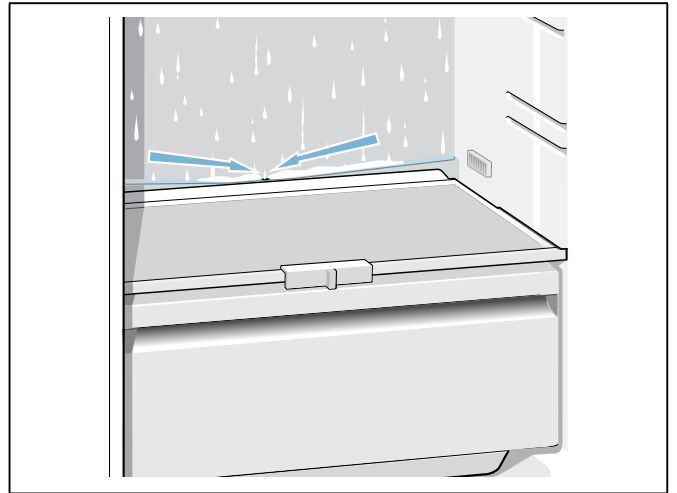

### 冷凍室

全自動 NoFrost 系統讓冷凍室保持無冰。無需除霜。



## 清潔

### 注意!

請勿損壞機器和配件。

- 請勿使用含有砂、氯化物或酸性物質的清潔劑和溶劑。
- 請勿使用磨蝕型或摩擦型的海綿。金屬表面可能產生腐蝕。
- 請勿將層板和貯藏盒放入洗碗機洗滌。零件可能變形!

請依下列步驟進行:

- 1 關機。
- 2 將電源插頭拔出或關閉保險絲。
- 3 將食物取出並放在陰涼的地方。  
若有：請將蓄冷器放在食物上。
- 4 若有：請等到霜層解凍。
- 5 請用乾淨的軟布、溫水和中性 PH 值的清洗劑清潔機器。

### 注意!

洗滌水不得碰到照明或流過蒸發區的排水孔。

- 6 請以冷水擦拭箱門封條，並徹底擦乾。
- 7 將機器重新啟動，打開箱門並將食物放入。

## 清潔配件

請取出機器內可變換的配件清潔。

→ "配件" 第 8 頁

## 冷凝水排放通道

冷凝水排放通道和排水孔應定期用棉花棒或類似的物品清潔，保持冷凝水流出暢通。

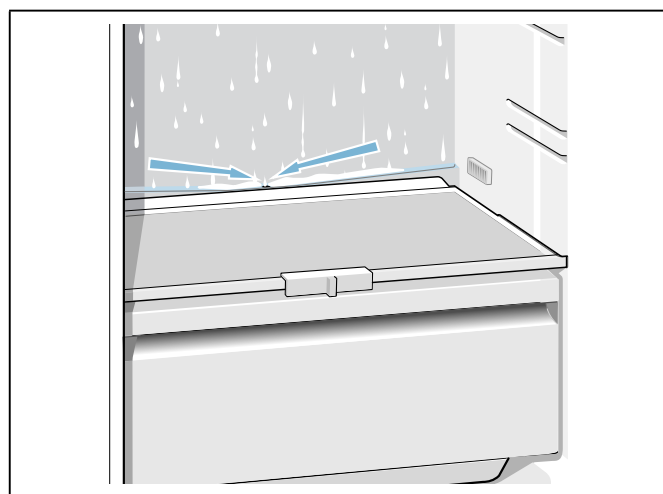

## 蔬果盒上的層板

- 1 請拉出蔬果盒。
- 2 拉出層板，並分開清潔。

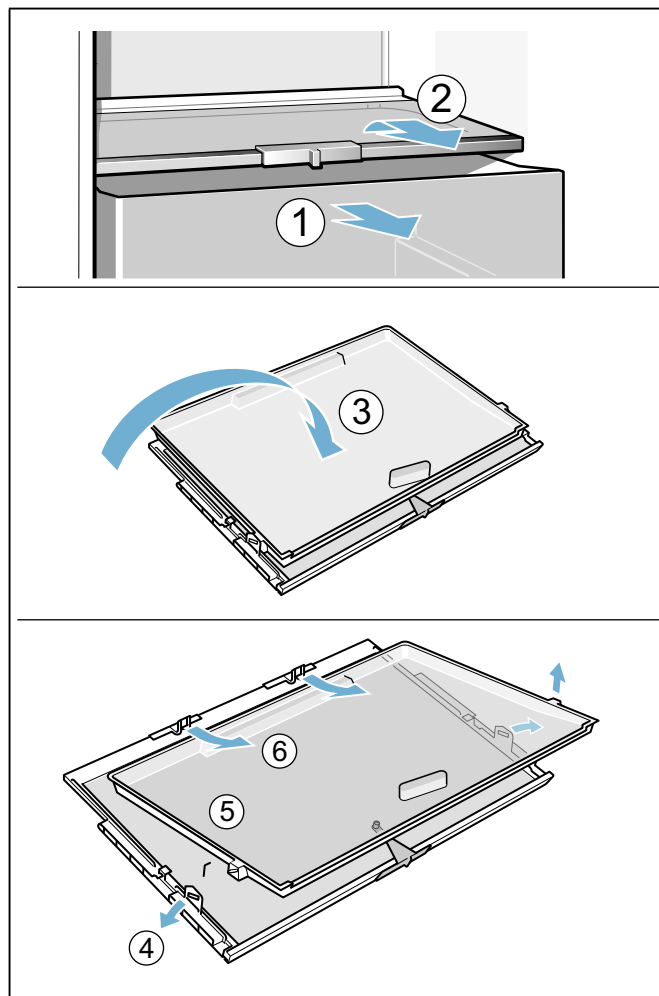

---

## 異味

---

若您發現到難聞的異味：

- 1 請以開／關按鍵  將機器關機。
- 2 將所有食物從機器中取出。
- 3 清潔冰箱內部。→ " 清潔 " 第 17 頁
- 4 清潔所有包裝袋。
- 5 請將味道較重的食物密封包裝好，以防止異味產生。
- 6 重新開機。
- 7 食物分類。
- 8 24 小時後檢查是否又有異味產生。

---

## 照明

---

您的機器安裝有一個免維護的 LED 照明燈。

僅限客戶服務或合格的專業人員對照明進行維修。

---

## 如何處理故障？

---

在您致電客戶服務之前，請先查看本表並判斷，您是否可以自行解決問題。

---

### 溫度偏離設定太多。

請關機 5 分鐘。  
→ " 關機並停用 " 第 10 頁  
若溫度太高，請在數小時後重新檢查。  
若溫度太低，請在隔天重新檢查。

---

### 顯示面板未亮起。

電源插頭未插緊。	插上電源插頭。
保險絲燒斷。	請檢查保險絲。
電力中斷。	請檢查是否有電。

---

### 顯示面板顯示 E...

電器有偵測到錯誤。	請聯絡客戶服務。 → " 客戶服務 " 第 19 頁
-----------	-------------------------------

---

### 警示音響起，且按鍵 (警報) 亮起。

箱門已打開。	觸按按鍵  (警報)。警報已關閉。
進氣口和通風口被堵塞。	關上箱門。
已貯存大量食物。	請保持進氣口和通風口的暢通。 請勿超過最大冷凍容量。

---

## 噪音

---

### 正常噪音

嗡嗡聲：壓縮機運轉，例如冷凍機組、風扇。

冒泡聲、流動水聲、咯咯聲：冷媒流過冷媒配管的聲音。

微弱喀嚓聲：開啟或關閉壓縮機、開關或電磁閥時，該噪音就會出現。

發出咔嚓聲：自動完成除霜。

### 避免噪音

機器擺放不平：請使用水平儀校準機器水平。必要時，請加墊增高。



貯藏盒、層板或層架發生晃動或卡住：檢查抽取式配件，必要時請更換。

瓶罐相互對碰：將瓶罐分開。

顯示面板閃動，警示音響起，並且按鍵  (警報) 亮起。

箱門已打開。	觸按按鍵  (警報)。警報已關閉。
進氣口和通風口被堵塞。	關上箱門。
已貯存大量食物。	請保持進氣口和通風口的暢通。 請勿超過最大冷凍容量。

顯示面板閃爍。

冷凍室的溫度太高。	觸按按鍵  (警報) 後，將顯示冷凍室最高溫度長達 5 秒。 觸按按鍵  (警報)。顯示面板不再閃爍。
-----------	--

機器不製冷，顯示面板和照明亮起。

示範模式已開啟。	啟動機器自檢。 → " 機器自檢 " 第 19 頁 該程序完成後，機器回到正常模式運轉。
----------	--

## 客戶服務

若您無法自行排除故障，請聯絡客戶服務。我們將竭盡所能地為您找到一個合適的解決方案，也可避免不必要的到府維修。

如需最近的客戶服務聯絡資料，請參閱隨附之客服索引。

致電客戶服務時，請告知型號 (E-Nr.) 和序號 (FD)，您可以在規格銘牌上查看相關資訊。  
→ " 了解本機 " 第 7 頁

請您信賴本公司身為冰箱製造商的專業能力。讓受過完整訓練的技術人員為您提供維修服務，以及為您的家電安裝適用的原廠備用零件。

## 機器自檢

您的機器具有自檢程序，客戶服務可以排除所顯示的錯誤。

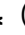
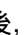
- 1 關機，並等待 5 分鐘。
  - 2 開機。
  - 3 10 秒內按住按鍵  (急速冷凍) 3 ... 5 秒不放，直到響音響起。  
自檢程序開始。在自檢程序運行的過程中，會響起一聲較長的響音。
- 若在自檢程序完成後，將響起 2 聲響音，且設置溫度顯示：您的機器運轉正常。
  - 若在自檢程序完成後，響起 5 聲響音，且按鍵  冷凍室閃爍 10 秒：請通知客戶服務。

該程序完成後，機器回到正常模式運轉。

## 故障時的送修與服務諮詢

有關各國當地的聯絡資料，請參閱隨附之客服索引。

## 保修卡

有關您所在國家的保修期及保修條件的詳細資訊，請您聯絡客戶服務、經銷商以及本公司的網站。

---

## en Table of contents

---

<b>Safety instructions</b>	<b>21</b>	<b>Freezer compartment</b>	<b>35</b>
About these instructions	21	Maximum freezing capacity	35
Risk of explosion	21	Fully utilising the freezer volume	35
Risk of electric shock	21	Purchasing frozen food	35
Risk of cold burns	21	Note when loading products	36
Risk of injury	21	Freezing fresh food	36
Fire hazard/Danger due to refrigerants	22	Thawing frozen food	37
Avoiding placing children and vulnerable people at risk	22		
Damage	22	<b>Defrosting</b>	<b>37</b>
Weight	22	Refrigerator compartment	37
		Freezer compartment	37
<b>Intended use</b>	<b>23</b>		
		<b>Cleaning</b>	<b>37</b>
<b>Environmental protection</b>	<b>23</b>	Cleaning the equipment	38
Packaging	23		
Old appliances	23	<b>Odours</b>	<b>38</b>
<b>Installation and connection</b>	<b>23</b>	<b>Lighting</b>	<b>39</b>
Scope of supply	23		
Technical specifications	23	<b>Noises</b>	<b>39</b>
Installing the appliance	23	Normal noises	39
Recess dimensions	24	Preventing noises	39
Side by-side installation	24		
Tips for saving energy	24	<b>Faults – what to do?</b>	<b>39</b>
Before using your appliance for the first time	25		
Electrical connection	25	<b>Customer service</b>	<b>40</b>
		Appliance self-test	40
<b>Getting to know your appliance</b>	<b>26</b>	Repair order and advice on faults	40
Appliance	26	Guarantee	40
Controls	27		
Interior fittings	27		
<b>Operating the appliance</b>	<b>29</b>		
Switching on the appliance	29		
Switching off and disconnecting the appliance	29		
Setting the temperature	30		
Fast cooling	30		
Fast freezing	30		
Holiday mode	30		
<b>Alarm</b>	<b>31</b>		
Door alarm	31		
Temperature alarm	31		
<b>Home Connect</b>	<b>31</b>		
Setting up Home Connect	31		
Installing updates for the Home Connect software	33		
Information on data protection	33		
Declaration of conformity	34		
<b>Refrigerator compartment</b>	<b>34</b>		
Note when storing food	34		
Note the chill zones in the refrigerator compartment	34		
Vegetable container with humidity control	34		

## **⚠ Safety instructions**

This appliance complies with the relevant safety regulations for electrical appliances and is fitted with noise suppression.

The refrigeration circuit has been checked for leaks.

### **About these instructions**

- Read and follow the operating and installation instructions. They contain important information on how to install, use and maintain the appliance.
- The manufacturer is not liable if you disregard the instructions and warnings in the operating and installation instructions.
- Retain all documents for subsequent use or for the next owner.

### **Risk of explosion**

- Never use electric appliances inside the appliance (e.g. heaters or electric ice makers).
- Do not store products which contain flammable propellant (e.g. spray cans) or explosive substances in the appliance.
- Store high-percentage alcohol tightly sealed and in an upright position.
- Do not use additional means to accelerate the defrosting process other than those recommended by the manufacturer.

### **Risk of electric shock**

Improper installations and repairs may put the user at considerable risk.

- When installing the appliance, ensure that the mains cable is not trapped or damaged.
- If the mains cable is damaged: immediately disconnect the appliance from the electricity supply.
- Do not use multiple sockets, extension leads or adapters.
- Have the appliance repaired by the manufacturer, Customer Service or a similarly qualified person only.
- Use original parts supplied by the manufacturer only.

The manufacturer guarantees that these parts satisfy the safety requirements.

### **Risk of cold burns**

- Never put frozen food straight from the freezer compartment into your mouth.
- Avoid prolonged contact of skin with frozen food, ice and the tubes in the freezer compartment.

### **Risk of injury**

Containers which contain carbonated drinks may burst.

Do not store containers which contain carbonated drinks in the freezer compartment.



### **Fire hazard/Danger due to refrigerants**

The tubes of the refrigeration circuit convey a small quantity of an environmentally friendly but flammable refrigerant (R600a). It does not damage the ozone layer and does not contribute to the greenhouse effect. If refrigerant escapes, it may injure your eyes or ignite.

- Do not damage the tubes.

If the tubes are damaged:

- Keep naked flames and ignition sources away from the appliance.
- Ventilate the room.
- Switch off the appliance and pull out the mains plug.
- Please contact Customer Service.

### **Avoiding placing children and vulnerable people at risk**

At risk are:

- Children,
- People who have limited physical, mental or sensory abilities,
- People who have inadequate knowledge concerning safe operation of the appliance.

Measures:

- Ensure that children and vulnerable people have understood the hazards.
- Children or vulnerable people must be supervised by a responsible person when using the appliance.
- Only children from 8 years and above may use the appliance.
- Supervise children while the appliance is being cleaned or maintained.
- Never allow children to play with the appliance.

### **Risk of suffocation**

- If the appliance features a lock: keep the key out of the reach of children.
- Keep children away from the packaging and its parts.

### **Damage**

To prevent damage:

- Do not stand or support yourself on the base, runners or doors.
- Keep plastic parts and door seals free of oil and grease.
- Pull the mains plug – not the power cord.

### **Weight**

When installing and transporting the appliance, note that it may be very heavy.

→ "Installation location" on page 23

---

## Intended use

---

Use this appliance

- only for the cooling and freezing of food and for making ice.
- only in the home and in the home environment.
- only according to these operating instructions.

This appliance is intended for use up to a maximum height of 2000 metres above sea level.

---

## Environmental protection

---

### Packaging

All materials are environmentally safe and recyclable:

- Dispose of packaging in an environmentally friendly manner.
- Please ask your dealer or inquire at your local authority about current means of disposal.

### Old appliances

Valuable raw materials can be reclaimed by recycling old appliances.

**⚠ Warning – Children may become locked in the appliance and suffocate!**

- To prevent children from climbing in, leave shelves and containers in the appliance.
- Keep children away from the redundant appliance.

### Caution!

**Refrigerant and harmful gases may escape.**

Do not damage the tubes of the refrigerant circuit and insulation.

- 1 Remove the mains plug.
- 2 Sever the power cord.
- 3 Have the appliance disposed of professionally.



This appliance is labelled in accordance with European Directive 2012/19/EU concerning used electrical and electronic appliances (waste electrical and electronic equipment - WEEE). The guideline determines the framework for the return and recycling of used appliances as applicable throughout the EU.

---

## Installation and connection

---

### Scope of supply

After unpacking all parts, check for any damage in transit.

If you have any complaints, contact the dealer from whom you purchased the appliance or our customer service.

→ "Customer service" on page 40

The delivery consists of the following parts:

- Built-in appliance
- Interior fittings (depending on model)
- Installation material
- User manual
- Installation instructions
- Customer service booklet
- Warranty enclosure
- Information on the energy consumption and noises

### Technical specifications

Refrigerant, cubic capacity and further technical specifications can be found on the rating plate.

→ "Getting to know your appliance" on page 26

### Installing the appliance

#### Installation location

The more refrigerant an appliance contains, the larger the room must be in which the appliance is situated. In rooms which are too small leaking refrigerant can form a flammable gas-air mixture.

Per 8 g of refrigerant the room must be at least 1 m<sup>3</sup> in size. The amount of refrigerant in your appliance is indicated on the rating plate inside the appliance.

→ "Getting to know your appliance" on page 26

The weight of the appliance may be up to 75 kg depending on the model.

### Permitted room temperature

The permitted room temperature depends on the climatic class of the appliance.

Information on the climatic class can be found on the rating plate.

→ "Getting to know your appliance" on page 26

Climatic category	Permitted room temperature
SN	+10 °C ... 32 °C
N	+16 °C ... 32 °C
ST	+16 °C ... 38 °C
T	+16 °C ... 43 °C

The appliance is fully functional within the permitted room temperature.

If an appliance of climatic class SN is operated at colder room temperatures, the appliance will not be damaged up to a room temperature of +5 °C.

### Tips for saving energy

If you follow the instructions below, your appliance will use less power.

**Note:** The arrangement of the features does not affect the energy consumption of the appliance.

#### Installing the appliance

---

Keep the appliance out of direct sunlight.

Install the appliance as far away as possible from heating elements, cooker and other heat sources:

3 cm to electric or gas cookers.

30 cm to an oil or solid-fuel cooker.

**Note:**

If this is not possible, attach an insulating plate between the appliance and heat source.

---

Select an installation location at a room temperature of approx. 20 °C.

---

Use a cavity depth of 56 cm.

**Caution!**

**Risk of burns!**

Individual parts of the appliance become hot during operation. Touching these parts may result in burns.

---

Do not cover or block the ventilation openings.

---

Ventilate the room daily.

### Recess dimensions

#### Cavity depth

A cavity depth of 56 cm is recommended for the appliance. If the cavity depth is smaller – at least 55 cm – the energy consumption increases slightly.

#### Cavity width

An inside cavity width of at least 56 cm is required for the appliance. If this is not the case, problems may occur when installing the appliance.

### Side by-side installation

It is only possible to install appliances side by side with a gap of at least 15 cm.

---

The appliance must cool less frequently at low ambient temperatures and therefore consumes less power.

---

The air on the rear panel of the appliance does not warm up so intensely. The appliance consumes less power if the warm air can escape.



## Using the appliance

Open the appliance door only briefly.	The air in the appliance does not warm up so intensely.
Transport purchased food in a cool bag and place quickly in the appliance.	The appliance must cool less frequently and therefore consumes less power.
Allow warm food and drinks to cool down before placing in the appliance.	
Thaw frozen food in the refrigerator compartment in order to utilise the low temperature of the frozen food.	
Always leave a space between the food and the rear panel.	The air can circulate and the air humidity will remain constant. The appliance must cool less frequently and therefore consumes less power.
Pack food airtight.	
Do not cover or block the ventilation openings.	The air on the rear panel of the appliance does not warm up so intensely. The appliance consumes less power if the warm air can escape.

## Before using your appliance for the first time

- 1 Remove information material, adhesive tape and protective film.
- 2 Clean the appliance.  
→ "Cleaning" on page 37

- 1 After installing the appliance, wait at least 1 hour before connecting it to prevent damaging the compressor.
- 2 Connect the appliance via a correctly installed socket.  
The socket must comply with the following data:

Socket with	220 V ... 240 V
Conductor	50 Hz
Fuse	10 A ... 16 A

Outside Europe: Check whether the indicated current type of the appliance corresponds with the values of your power supply. Appliance specifications are on the rating plate.

→ "Getting to know your appliance" on page 26

- 3 Connect the appliance to a socket near the appliance.  
The socket must also be freely accessible following installation of the appliance.

### **Warning – Risk of electric shock!**

If the length of the mains cable is inadequate, never use multiple sockets or extension leads. Instead, please contact Customer Service for alternatives.

## Electrical connection

### Caution!

Do not connect the appliance to electronic energy saver plugs.

**Note:** You can connect the appliance to mains-controlled and sine-controlled inverters.

Mains-controlled inverters are used for photovoltaic systems which are connected directly to the national grid. Sine-controlled inverters must be used for isolated applications. Isolated applications, e.g. on ships or in mountain lodges, which are not connected directly to the national grid.

## Getting to know your appliance

These operating instructions refer to several models. The diagrams may differ.

### Appliance

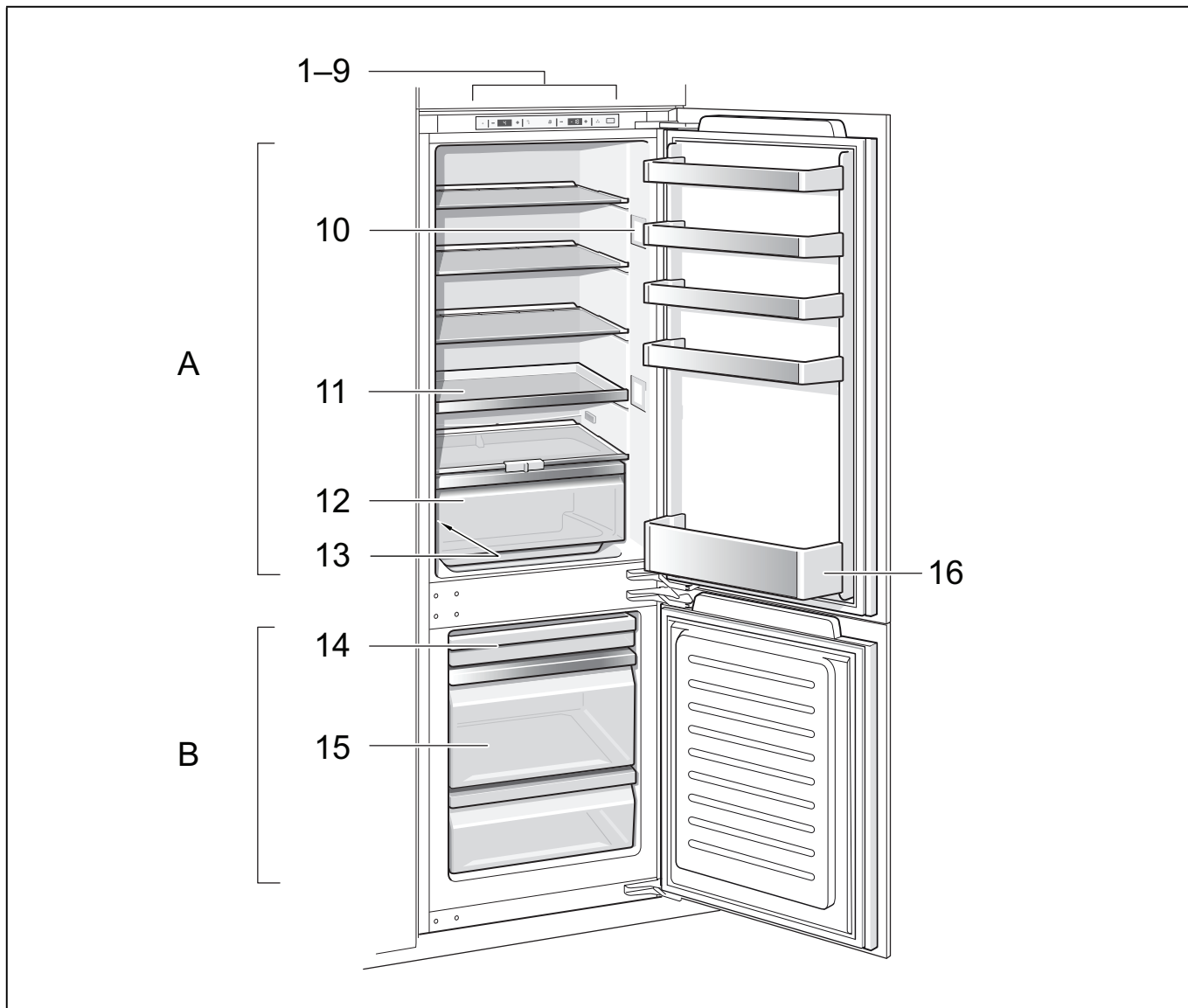

\* Not all models.

A	Refrigerator compartment	14*	Freezer drawer
B	Freezer compartment	15	Frozen food container
1-9	Controls	16	Tray for large bottles
10	Lighting		
11	Extendable shelf		
12	Vegetable container with humidity control		
13	Rating plate		

## Controls

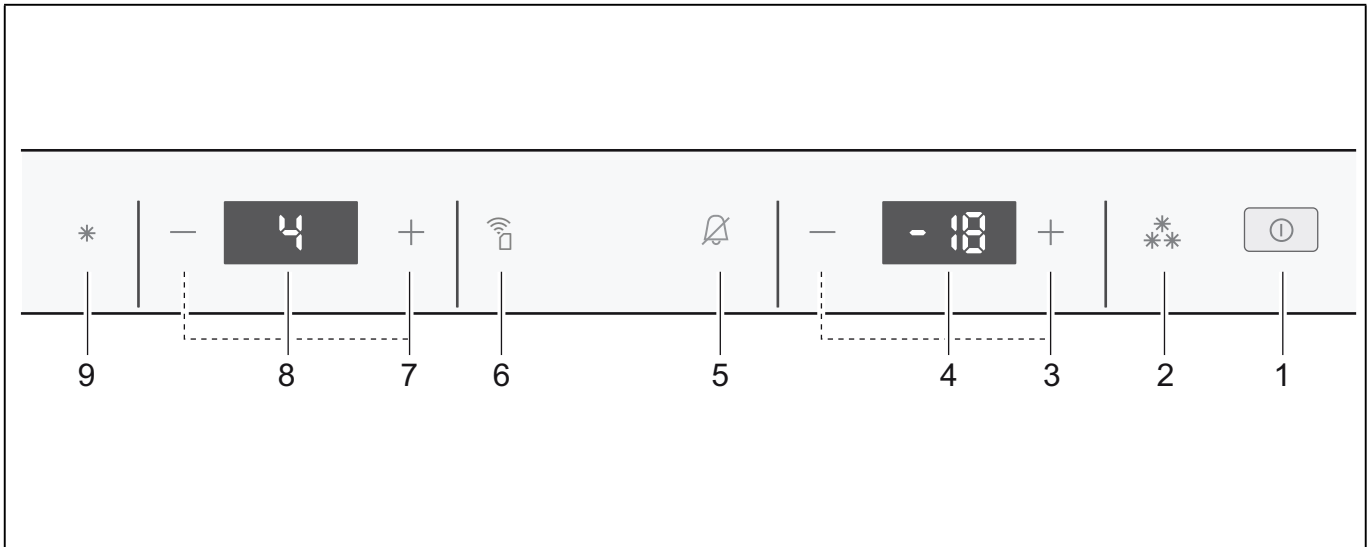

- 1 Button ①  
Switches the appliance on or off.
- 2 Button \*\*\* freezer compartment  
Switches fast freezing on or off.
- 3 Button - / + freezer compartment  
Sets the temperature of the freezer compartment.
- 4 Freezer compartment temperature display  
Indicates the set temperature in °C.
- 5 Button 🔔  
Switches the warning signal off.
- 6 📶 button  
Switches Home Connect on or off.
- 7 Button - / + refrigerator compartment  
Sets the temperature of the refrigerator compartment.
- 8 Refrigerator compartment temperature display  
Indicates the set temperature in °C.
- 9 \* button refrigerator compartment  
Switches fast cooling on or off.

## Interior fittings

(not all models)

### Shelf

You can vary the shelf:

- Pull out and remove the shelf.

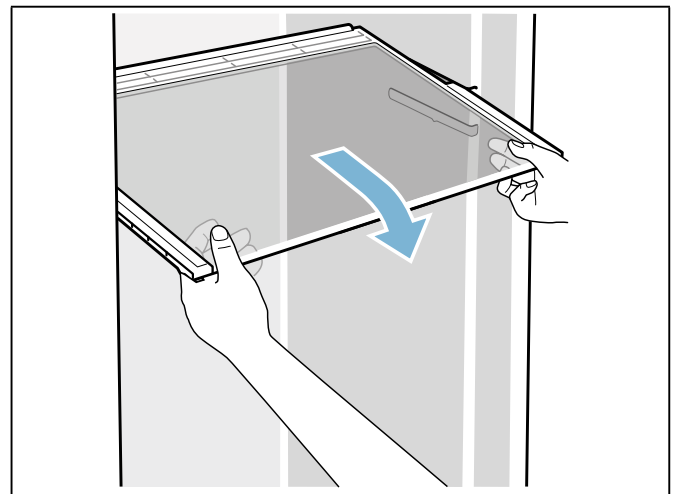

### Extendable shelf

You can give yourself a better overview:

- Pull out a shelf.

You can completely remove the shelf:

- 1 Press and hold down both buttons under the shelf.
- 2 Pull out the shelf, lower and swing out to the side.

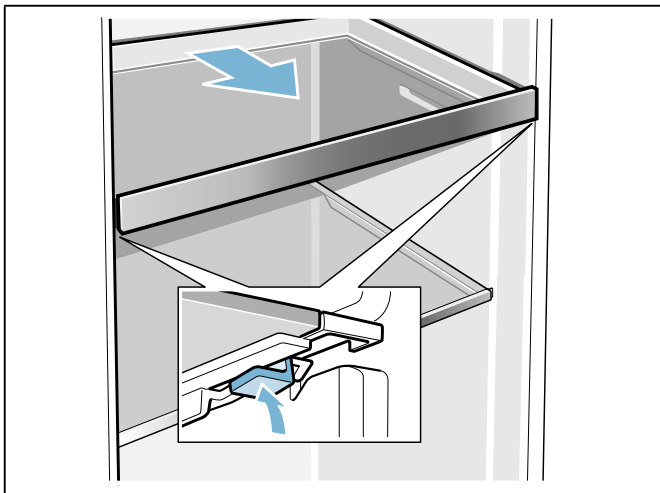

### Wine and champagne rack

Bottles can be stored securely:

- Move metal bracket down.

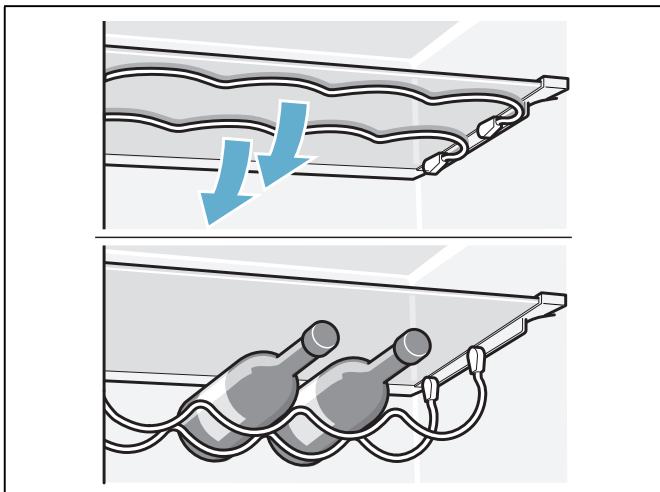

### Container

You can remove the container:

- Pull out the container all the way, lift at the front and remove.

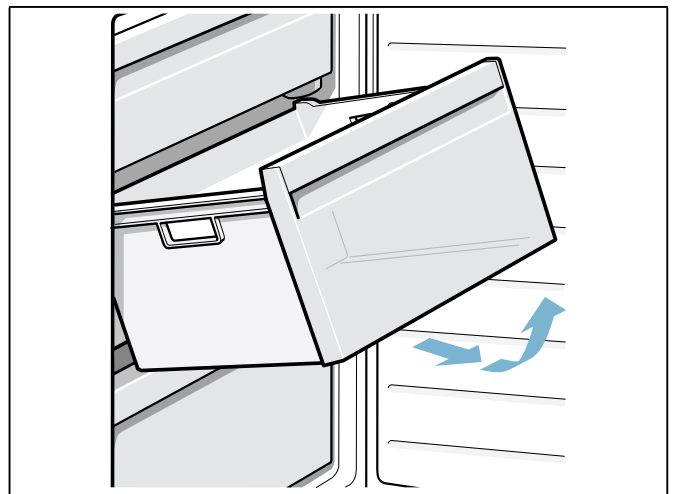

### Storage compartment

You can remove the storage compartment:

- Lift up storage compartment and remove.

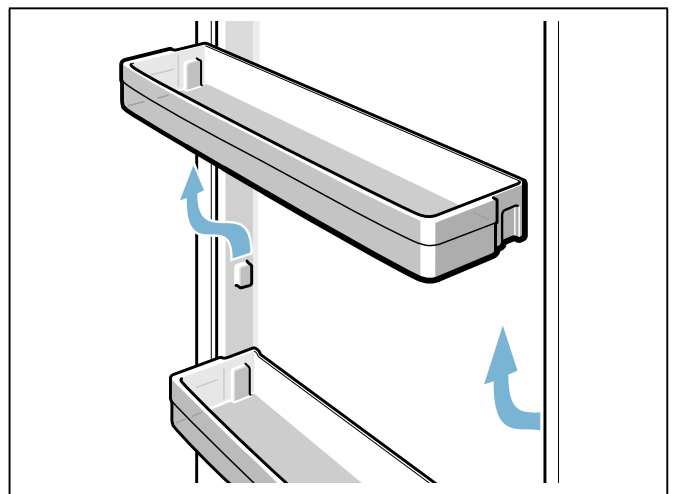

### Bottle holder

When you open and close the door:

- The bottle holder prevents the bottles from overturning.

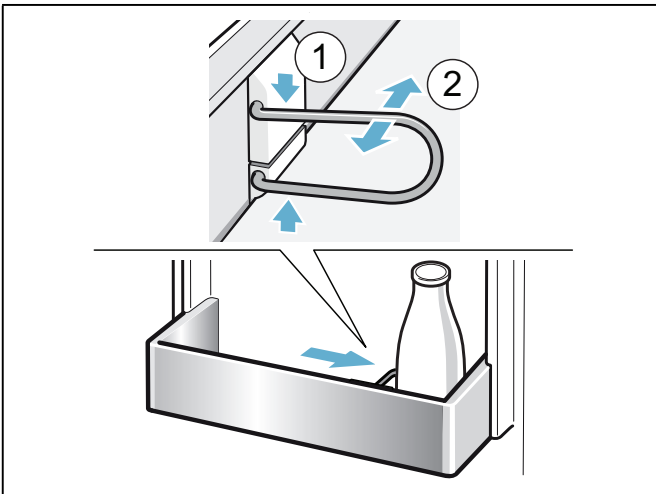

### Ice cube tray

You can make ice cubes:

- 1 Fill the ice cube tray 3/4 full with water and place in the freezer compartment.

**Note:** If the ice cube tray is stuck to the freezer compartment, loosen with a blunt implement only (e.g. spoon handle).

- 2 To loosen the ice cubes, twist the ice cube tray slightly or hold briefly under flowing water.

### Ice pack

In the event of a power failure or a fault:

- The ice pack delays the warming of the stored frozen food.

**Note:** The longest storage time is obtained by placing the ice pack on the food in the top compartment.

You can take out the ice pack for temporarily keeping food cool, e.g. in a cool bag.

## Operating the appliance

### Switching on the appliance

- 1 Press the  $\text{\textcircled{1}}$  button.  
The appliance begins to cool. Warning signal, flashing temperature display on the freezer compartment and lit button  $\text{\textcircled{A}}$  indicate that the freezer compartment is still too warm.
- 2 Press the  $\text{\textcircled{A}}$  button.  
The warning signal switches off.
- 3 Setting the required temperature.  
→ "Setting the temperature" on page 30

### Operating tips

- After the appliance has been switched on, it may take several hours until the set temperatures have been reached. Do not put in any food until the selected temperature has been reached.
- The fully automatic NoFrost system ensures that the freezer compartment remains free of ice. Defrosting is not required.
- The sides of the housing are partly heated slightly. This prevents condensation in the area of the door seal.
- If the freezer compartment door cannot be immediately re-opened after it has been closed, wait until the resulting low pressure has equalised.

## Switching off and disconnecting the appliance

### Switching off the appliance

- Press the  $\text{\textcircled{1}}$  button.  
The appliance no longer cools.

### Disconnecting the appliance

If you do not use the appliance for a prolonged period:

- 1 Press the  $\text{\textcircled{1}}$  button.  
The appliance no longer cools.
- 2 Pull out the mains plug or switch off the fuse.
- 3 Clean the appliance.
- 4 Leave the appliance open.

## Setting the temperature

### Recommended temperature

Refrigerator compartment: +4 °C

Freezer compartment: -18 °C

### Refrigerator compartment

- Keep pressing the button – / + until the display indicates the required temperature.

### Freezer compartment

- Keep pressing the button – / + until the display indicates the required temperature.

### Sticker OK

(not all models)

The sticker **OK** lets you check whether the refrigerator compartment achieves the safe temperature ranges of +4 °C or colder recommended for food.

If the sticker does not indicate **OK**, gradually reduce the temperature.

When the appliance is switched on, it may take up to 12 hours until the set temperature is reached.

### Correct setting



## Fast cooling

Fast cooling cools the refrigerator compartment as cold as possible.

Switch on fast cooling e.g.:

- before placing large quantities of food in the compartment
- for cooling drinks quickly

**Note:** When fast cooling is switched on, increased operating noises may occur.

After 15 hours the appliance switches to normal operation.

Switch fast cooling on/off:

- Press \* button.

The button lights up when fast cooling is switched on.

## Fast freezing

Fast freezing cools the freezer compartment as cold as possible.

Switch on fast freezing e.g.:

- to freeze food solid as quickly as possible
- 4 ... 6 hours before freezing food weighing 2 kg or more
- to use the max. freezing capacity

**Note:** When fast freezing is switched on, increased operating noise may occur.

After approx. 2 ½ days the appliance switches to normal operation.

Switching fast freezing on/off:

- Press the ❄ button.

If the fast freezing has been switched on, the button is lit.

## Holiday mode

If leaving the appliance for a long period of time, you can switch the appliance over to the energy-saving holiday mode.

The temperature in the refrigerator compartment is automatically switched to +14 °C.

Do not store any food in the refrigerator compartment during this time.

The temperature in the freezer compartment remains unchanged.

Switch on holiday mode:

- Press button + refrigerator compartment until the display 8 shows **Ho**.

When holiday mode is switched on, the refrigerator compartment temperature display no longer indicates a temperature.

Switch off holiday mode:

- Press button – refrigerator compartment until the display 8 shows the required temperature.

---

## Alarm

---

### Door alarm

If the appliance door is open for a while, the door alarm switches on.

- Close the door or press  button.  
The warning signal is switched off.

### Temperature alarm

If the freezer compartment becomes too warm, the temperature alarm is switched on.

#### Caution!

#### Bacteria may develop during the thawing process and spoil the frozen food



Do not refreeze thawing or thawed food.

Refreeze food only after cooking. Do not store the frozen food for the maximum storage period.

**Note:** The alarm may be actuated without risk to the frozen food in the following cases:

- The appliance is switching on.
- Large quantities of fresh food are put in.
- The freezer compartment door has been open too long.

Indicating warmest temperature and switching off warning signal:

- Press the  button.  
The display briefly indicates the warmest temperature reached in the freezer compartment. Then the display indicates the set temperature again.  
From this time on the warmest temperature is recalculated and saved.  
**Note:** The button  remains lit until the set temperature has been reached again.

---

## Home Connect

---

This appliance is Wi-Fi-capable and can be remotely controlled using a mobile device.

**Note:** Wi-Fi is a registered trademark of the Wi-Fi Alliance.

In the following cases, the appliance functions like a refrigerator without a network connection and can still be manually operated via the controls:

- The appliance is not connected to a home network.
- Home Connect service is not available in the country in which the appliance is set up. For an overview of the countries in which Home Connect is available, see [www.home-connect.com](http://www.home-connect.com).

**Note:** Please observe the safety information in this instruction manual. Ensure that this is also observed if you operate the appliance via the Home Connect app and are not at home when doing so.

→ "Safety instructions" on page 21

Follow the instructions in the Home Connect app as well.

### Setting up Home Connect

#### Notes

- Observe the Home Connect supplementary sheet, which is available for download under [www.gaggenau.com](http://www.gaggenau.com) with the instructions. To do so, enter the E-number of your appliance in the search field.
- After switching on the appliance, wait at least two minutes until internal device initialisation is complete. Only then start setting up Home Connect.
- To implement settings with Home Connect, the Home Connect app must be installed on your mobile device. Observe the supplied Home Connect documents for this.  
Follow the steps specified by the app to implement the settings.
- The Home Connect menu will close automatically when the appliance is not operated for a lengthy period of time. You can find information on how to open the Home Connect menu at the start of the appropriate sections.

### Automatic connection with the home network (WLAN)

If a WLAN router with WPS function is available, the refrigerator can automatically connect to the home network.

- 1 Press the  button.  
The refrigerator compartment temperature display shows **Cn**.
- 2 Press button **- / +** refrigerator compartment until the refrigerator compartment temperature display shows **AC** and the freezer compartment temperature display shows **OF**.
- 3 Press button **- / +** freezer compartment.  
The appliance is ready for the automatic connection. Freezer compartment temperature display shows an animation for 2 minutes.  
The appliance is ready for the automatic connection for as long as the animation is displayed.
- 4 Within those 2 minutes, activate the WPS function on the home network router (e.g. using the WPS/WLAN button; observe information on this topic in the router documentation).  
If the connection is successful, **On** flashes up in the freezer compartment temperature display.  
The refrigerator is ready to connect with the app.

**Note:** If the freezer compartment temperature display shows **OF**, no connection could be established.

- 1 Check whether the refrigerator is located within the range of the home network (WLAN).
- 2 Repeat the process or establish the connection manually.

### Manual connection with the home network (WLAN)

If the WLAN router present does not have a WPS function, or if this is unknown, you can manually connect the refrigerator with the home network.

- 1 Press the  button.  
The refrigerator compartment temperature display shows **Cn**.
- 2 Press button **- / +** refrigerator compartment until the refrigerator compartment temperature display shows **SA** and the freezer compartment temperature display shows **OF**.
- 3 Press button **- / +** freezer compartment.  
The appliance is ready for the manual connection. The freezer compartment temperature display shows an animation.  
The appliance is ready for the manual connection for as long as the animation is displayed.
- 4 The refrigerator has now set up its own WLAN network with the network name HomeConnect. You can now access this network with your mobile device.

- 5 Call up the WLAN settings in the settings menu of the mobile device.
- 6 Connect the mobile device with the WLAN network HomeConnect.  
Password: HomeConnect  
It can take up to 60 seconds to establish the connection.
- 7 After successfully connecting, open the Home Connect app on the mobile device.  
The app will search for the refrigerator.
- 8 As soon as the refrigerator has been found, enter the network name (SSID) and the password (Key) of your own home network (WLAN) into the corresponding fields.
- 9 Confirm with the button **Transmit to domestic appliances**.
  - If the connection is successful, **On** flashes up in the freezer compartment temperature display. You can now connect the refrigerator with the app.
  - If the freezer compartment temperature display shows **OF**, no connection could be established. Check whether the refrigerator is located within the range of the home network (WLAN). Repeat the process.

### Connecting the refrigerator to the Home Connect app

- 1 Press  button.  
The refrigerator compartment temperature display shows **Cn**.
- 2 Keep pressing **- / +** button refrigerator compartment until the refrigerator compartment temperature display shows **PA** and the freezer compartment temperature display shows **OF**.
- 3 Press **- / +** button freezer compartment to connect the appliance to the app.  
The freezer compartment temperature display shows an animation.  
As soon as the refrigerator and the app are connected, the freezer compartment temperature display shows **On**.
- 4 Open the app and wait until the refrigerator is displayed.  
Use **Add** to confirm the connection between the app and the refrigerator.  
If the refrigerator is not automatically displayed, click on **Add appliance** in the app and follow the instructions. As soon as your refrigerator is displayed, add it with **+**.



- 5 Follow the instructions in the app until the process is complete.  
The refrigerator compartment temperature display shows **PA** and the freezer compartment temperature display shows **On**.  
The refrigerator has been connected to the app.  
If the connection fails, check whether the mobile device is connected to the home network (WLAN).  
Then try to establish the connection again.  
If **Er** appears in the freezer compartment temperature display, reset the Home Connect settings.  
**Note:** On resetting, all Home Connect settings are reset.

### Verify signal strength

You should verify the signal strength if no connection can be established.

- 1 Press the  button.  
The refrigerator compartment temperature display shows **Cn**.
- 2 Press button **- / +** refrigerator compartment until the refrigerator compartment temperature display shows **SI**. In the freezer compartment temperature display a value appears between 0 (no signal) and 3 (full signal).  
The signal strength should be at least 2. If the signal strength is too weak, the connection may be interrupted.
  - Place the router and refrigerator closer together.
  - Ensure that the connection is not interfered with by screening walls.
  - Alternatively, install a repeater to make the signal stronger.

### Resetting Home Connect settings

If there is a problem when trying to establish a connection or if you would like to register the appliance in a different home network (WLAN), the Home Connect settings can be reset:

- 1 Press the  button.  
The refrigerator compartment temperature display shows **Cn**.
- 2 Press button **- / +** refrigerator compartment until the refrigerator compartment temperature display shows **rE** and the freezer compartment temperature display shows **OF**.
- 3 Press button **- / +** freezer compartment.  
Freezer compartment temperature display shows an animation for 15 seconds.  
Then the freezer compartment temperature display shows **OF**.  
The Home Connect settings have been reset.

## Installing updates for the Home Connect software

The refrigerator checks at regular intervals whether updates are available for the Home Connect software.

If an update is available, the refrigerator compartment temperature display shows **UP**.

Pressing any button will reset the display to the set temperature.

Installing the update:

- 1 Press the  button.  
The refrigerator compartment temperature display shows **Cn**.
- 2 Press button **- / +** refrigerator compartment until the refrigerator compartment temperature display shows **UP** and the freezer compartment temperature display shows **OF**.
- 3 Press button **- / +** freezer compartment.  
The freezer compartment temperature display shows an animation.  
The update will be installed.  
During the installation, all buttons are locked.
  - If the installation was successfully completed, the freezer compartment temperature display will show **On**.
  - If the installation was not successfully completed, the freezer compartment temperature display will show **Er**.  
Start the update again at a later time.  
Inform the Customer Service if the installation has still not been successfully completed after several attempts.

## Information on data protection

The first time your Home Connect appliance is registered on the WLAN network connected to the Internet, your appliance will transmit the following types of data to the Home Connect server (initial registration):

- Unique appliance identification (consisting of appliance codes as well as the MAC address of the installed Wi-Fi communication module).
- Security certificate of the Wi-Fi communication module (to ensure a secure IT connection).
- The current software and hardware version of your domestic appliance.
- Status of any previous resetting to factory settings.

This initial registration prepares the Home Connect functions for use and is only required when you want to use these Home Connect functions for the first time.

**Note:** Be aware that the Home Connect functions can only be utilised with the Home Connect app. Information on data protection can be called up in the Home Connect app.

## Declaration of conformity

Gaggenau Hausgeräte GmbH hereby declares that the appliance with Home Connect functionality meets the essential requirements and other relevant provisions of Directive 2014/53/EU.

A detailed RED Declaration of Conformity can be found online at [www.gaggenau.com](http://www.gaggenau.com) among the additional documents on the product page for your appliance.



2.4 GHz band: 100 mW max.

---

## Refrigerator compartment

---

The refrigerator compartment is suitable for storing meat, sausages, fish, dairy products, eggs, ready meals and pastries.

The temperature can be set from +2 °C ... +8 °C.

The refrigerator compartment can also be used to store highly perishable foods in the short to medium term. The lower the selected temperature, the slower the enzymatic and chemical processes and deterioration by microorganisms. A temperature of +4 °C or lower ensures optimum freshness and safety of the stored foods.

## Note when storing food

- Store fresh, undamaged food.  
The quality and freshness will then be retained for longer.
- In the case of ready products and bottled goods do not exceed the minimum sell-by date or use-by-date indicated by the manufacturer.
- To retain aroma, colour and freshness, pack or cover food well before placing it in the appliance.  
This avoids transference of flavours and discolouration of the plastic parts.
- Leave warm food and drinks to cool down before placing them in the refrigerator compartment.

## Note the chill zones in the refrigerator compartment

The air circulation in the refrigerator compartment creates different chill zones.

### Coldest zone

The coldest zone is between the arrow stamped on the side and the shelf underneath.

**Note:** Store perishable food (e.g. fish, sausages and meat) in the coldest zone.

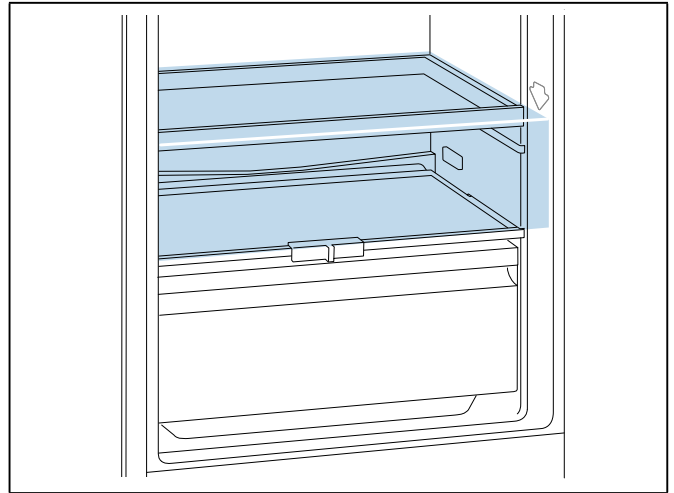

### Warmest zone

The warmest zone is at the very top of the door.

**Note:** Store e.g. hard cheese and butter in the warmest zone. Cheese can continue to release its flavour and the butter will still be easy to spread.

## Vegetable container with humidity control

The vegetable container is the best storage location for fresh fruit and vegetables. You can adjust the humidity in the vegetable container via the humidity controller and a special seal. This allows fresh fruit and vegetables to be stored up to twice as long as with conventional storage.

The air humidity in the vegetable container can be set according to the type and amount of products to be stored:

- Mainly fruit as well as for a large load – set lower air humidity
- Mainly vegetables as well as for a mixed or small load – set higher air humidity

## Notes

- Fruit sensitive to cold (e.g. pineapple, banana, papaya and citrus fruit) and vegetables sensitive to cold (e.g. aubergines, cucumbers, courgettes, peppers, tomatoes and potatoes) should be stored outside the appliance at temperatures of approx. +8 °C ... +12 °C for optimum preservation of quality and flavour.
- Condensation may form in the vegetable container depending on the food and quantity stored. Remove condensation with a dry cloth and adjust the humidity in the vegetable container with the humidity controller.

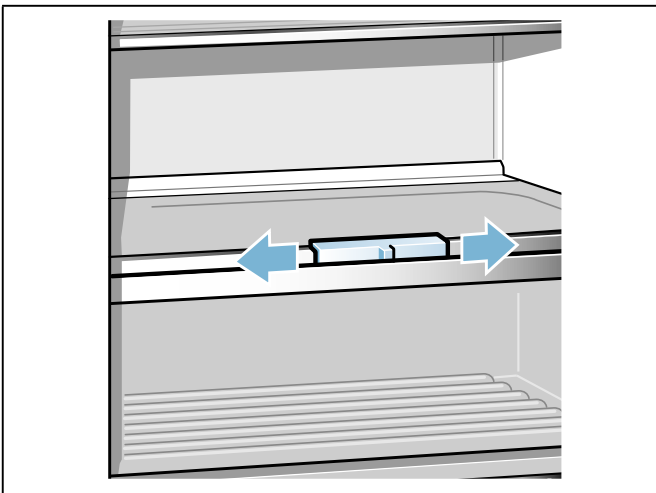

## Freezer compartment

The freezer compartment is suitable for:

- storing frozen food
- making ice cubes
- freezing food

The temperature can be set from  $-16\text{ °C}$  ...  $-24\text{ °C}$ .

The freezer compartment can be used to store perishable foods long-term almost without any noticeable reduction in quality, as the low temperatures considerably slow down or stop deterioration. Appearance, flavour and all valuable ingredients are largely retained.

Long-term storage of food should be at  $-18\text{ °C}$  or lower.

The time between putting fresh food in the freezer compartment and it freezing solid depends on the following factors:

- set temperature
- type of food
- amount of food in the freezer compartment
- quantity and type of storage

## Maximum freezing capacity

The maximum freezing capacity indicates the quantity of food that can be frozen solid within 24 hours.

Information on the maximum freezing capacity can be found on the rating plate.

→ "Getting to know your appliance" on page 26

To use the maximum freezing capacity, switch on fast freezing 24 hours before placing the fresh food in the freezer compartment.

→ "Fast freezing" on page 30

### Prerequisites for max. freezing capacity

- 1 Approx. 24 hours before inserting fresh produce: switch on fast freezing.  
→ "Fast freezing" on page 30
- 2 Take the container out of the freezer compartment and stack the food directly on the shelves and on the floor of the freezer compartment.
- 3 First fill the upper compartment with food. This is where the food will freeze most quickly.
- 4 If the top compartment is inadequate, store the remaining quantity in the compartment underneath starting at the front right side.
- 5 Freeze fresh food as close as possible to the side panels.

## Fully utilising the freezer volume

To place the maximum quantity of frozen food in the freezer compartment:

- remove all fittings.
- Store food directly on the shelves and on the floor of the freezer compartment.

## Purchasing frozen food

- Check the packaging is not damaged.
- Check there is a sell-by date.
- The temperature in the supermarket freezer must be  $-18\text{ °C}$  or lower.
- Do not interrupt the freezing chain. If possible, transport frozen food in a cool bag and place in the freezer compartment quickly.

## Note when loading products

- Freeze large quantities of food in the top compartment.  
This is where the food will freeze especially quickly and gently.
- Distribute food in the compartments or frozen food containers.
- Do not bring food which is to be frozen into contact with frozen food.  
If required, restack frozen food in the frozen food containers.
- Important for unrestricted air circulation in the appliance:  
push in frozen food container all the way.

## Freezing fresh food

Freeze only fresh and undamaged food.

Food which is boiled, fried or baked is more suitable for freezing than food which is raw.

Before freezing food, make preparations appropriate to the food in order to retain the best possible nutritional value, flavour and colour:

- Vegetables: wash, chop, blanch.
- Fruit: wash, pit and perhaps peel, possibly add sugar or ascorbic acid solution.

Information on how to do this can be found in the relevant literature.

### Suitable for freezing

- Baked goods
- Fish and seafood
- Meat
- Poultry and game
- Vegetables, fruit and herbs
- Eggs without shells
- Dairy products, e.g. cheese, butter and quark
- Ready meals and leftovers, e.g. soups, stews, cooked meat and fish, potato dishes, soufflés and desserts

### Not suitable for freezing

- Types of vegetables which are usually eaten raw, e.g. lettuce or radishes
- Unpeeled or hard boiled eggs
- Grapes
- Whole apples, pears and peaches
- Yoghurt, soured milk, sour cream, creme fraiche and mayonnaise

### Packing frozen food

The correct type of packaging and material selection are decisive factors in the retention of the product quality and prevent the development of freezer burn.

- 1 Place food in packaging.
- 2 Remove air.
- 3 Pack food airtight to prevent it from losing flavour and drying out.
- 4 Label packaging with contents and date of freezing.

Suitable packaging:

- Plastic film
- Tubular film made of polyethylene (PE)
- Aluminium foil
- Freezer containers

Suitable locks:

- Rubber bands
- Plastic clips
- Cold-resistant adhesive tape

Not suitable packaging:

- Wrapping paper
- Greaseproof paper
- Cellophane
- Refuse bags and used shopping bags

### Shelf life of frozen food at $-18\text{ }^{\circ}\text{C}$

Fish, sausage, ready meals and cakes up to 6 months and pastries:

Meat, poultry:	up to 8 months
Fruit, vegetables:	up to 12 months

### Freezer calendar

The imprinted freezer calendar indicates the maximum storage duration in months at a constant temperature of  $-18\text{ }^{\circ}\text{C}$ .

## Thawing frozen food

The thawing method must be adjusted to the food and application in order to retain the best possible product quality.

Thawing methods:

- in the refrigerator compartment (especially suitable for animal-based foods such as fish, meat, cheese, quark)
- at room temperature (bread)
- in the microwave (food for immediate consumption or immediate preparation)
- in the oven/cooker (food for immediate consumption or immediate preparation)

### Caution!

Do not refreeze thawing or thawed food. You can only refreeze the food when it has been used for a ready-to-eat meal (boiled or fried).

The frozen food can no longer be stored for the maximum duration.

---

## Defrosting

---

### Refrigerator compartment

While the refrigerating unit is running, condensation droplets or frost form on the rear panel. This is due to functional reasons. It is not necessary to wipe off the condensation droplets or frost. The rear panel defrosts automatically. The condensation drains off into the condensation channel.

The condensation runs from the condensation channel to the evaporation pan where it evaporates.

**Note:** Keep the condensation channel and drainage hole clean so that the condensation can drain and odours do not form.

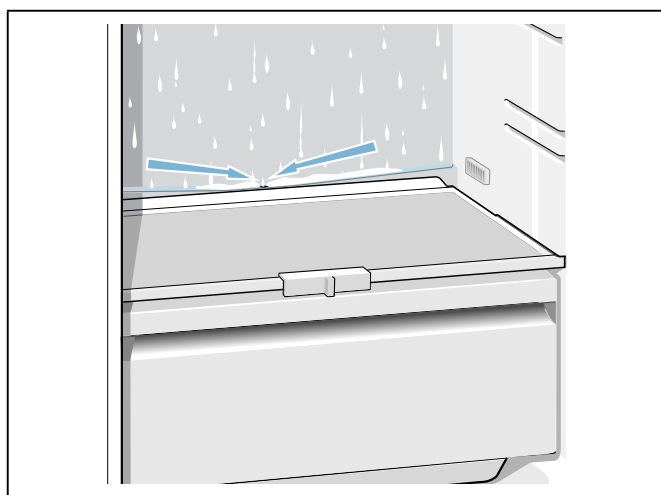

## Freezer compartment

The fully automatic NoFrost system ensures that the freezer compartment remains free of ice. Defrosting is no longer required.

---

## Cleaning

---

### Caution!

**Avoid damaging the appliance and the fittings.**

- Do not use abrasive, chloride or acidic cleaning agents or solvents.
- Do not use scouring or abrasive sponges. The metallic surfaces may corrode.
- Never clean the shelves or containers in the dishwasher. The parts may become deformed.

Proceed as follows:

- 1 Switch off the appliance.
- 2 Pull out the mains plug or switch off the fuse.
- 3 Take out the food and store in a cool location. If present: place ice pack on the food.
- 4 If present: wait until the layer of frost has thawed.
- 5 Clean the appliance with a soft cloth, lukewarm water and a little pH-neutral washing-up liquid.

### Caution!

The rinsing water must not run into the light or through the drainage hole into the evaporation area.

- 6 Wipe door seal with clear water and dry thoroughly with a cloth.
- 7 Reconnect and switch on appliance and put in food.

## Cleaning the equipment

To clean, take the variable parts out of the appliance.  
 → "Interior fittings" on page 27

### Condensation channel

Regularly clean the condensation channel and drainage hole with a cotton bud or similar implement to ensure that the condensation can drain.

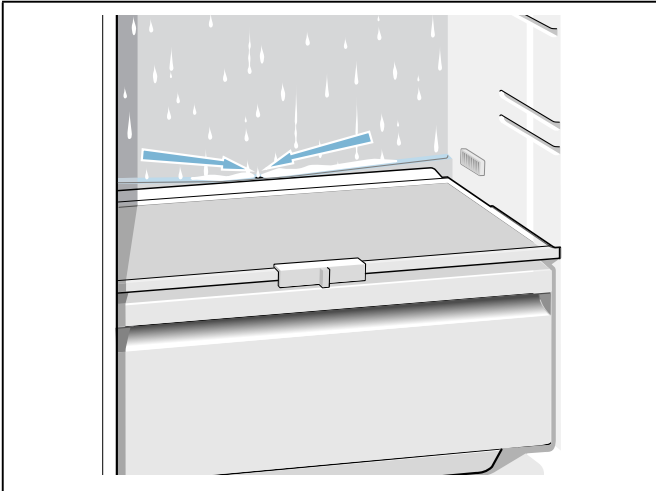

### Shelf above the vegetable container

- 1 Pull out vegetable container.
- 2 Take out shelf and dismantle to clean.

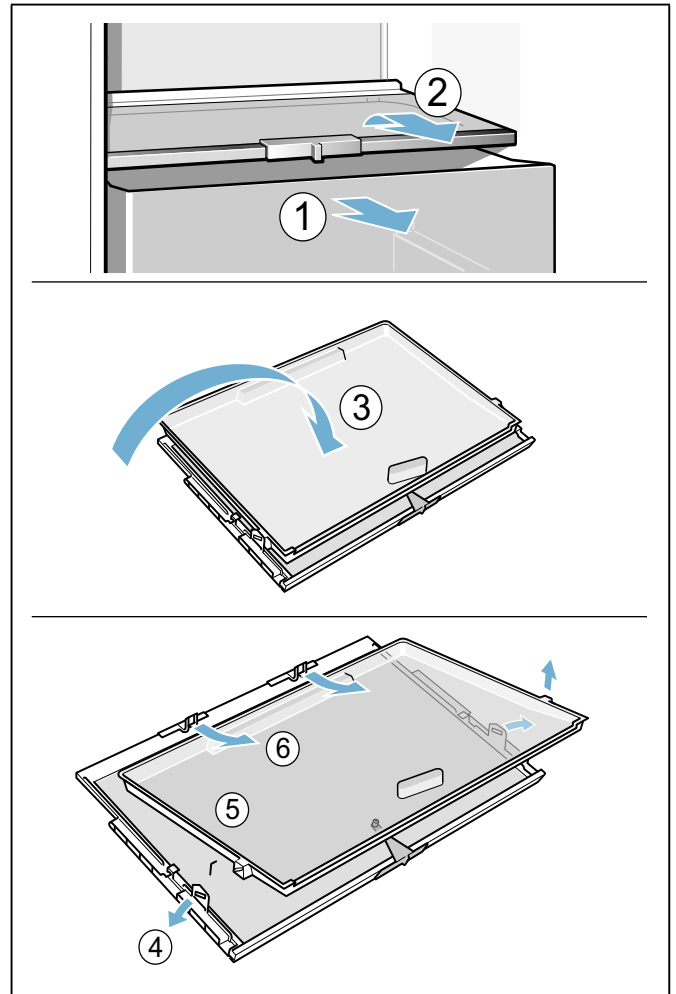

## Odours

If you experience unpleasant odours:

- 1 Switch off the appliance with the On/Off button ①.
- 2 Take all food out of the appliance.
- 3 Clean the inside. → "Cleaning" on page 37
- 4 Clean all packages.
- 5 Seal strong smelling food in order to avoid odours from forming.
- 6 Switch the appliance on again.
- 7 Store food in the appliance.
- 8 Check whether the formation of odours is still occurring after 24 hours.

---

## Lighting

---

Your appliance features a maintenance-free LED light.

Only customer service or authorised technicians may repair the light.

---

## Noises

---

### Normal noises

**Droning:** A motor is running, e.g. refrigerating unit, fan.

**Bubbling, buzzing or gurgling:** Refrigerant is flowing through the tubes.

**Clicking:** Motor, switches or solenoid valves are switching on and off.

**Cracking:** Automatic thawing successful.

### Preventing noises

**Appliance is not level:** Align appliance using a spirit level. If required, place a little packing underneath.

**Containers, shelves or storage compartments wobble or stick:** Check the removable fittings and re-insert if required.

**Bottles or receptacles are touching each other:** Move bottles or receptacles away from each other.

---

## Faults – what to do?

---

Before you call customer service, use this table to check whether you can rectify the fault yourself.

### Temperature differs greatly from the set value.

---

Switch off appliance for 5 minutes.  
→ "Switching off and disconnecting the appliance" on page 29

If the temperature is too warm, check temperature again after a couple of hours.

If the temperature is too cold, check temperature again on the following day.

### Displays do not illuminate.

---

The mains plug has not been inserted properly.

Connect the mains plug.

The fuse has tripped.

Check the fuses.

The power has failed.

Check whether the power is on.

### Display indicates "E...".

---

Electronics have detected a fault.

Call the after-sales service.  
→ "Customer service" on page 40

### A warning signal sounds and the button is lit.

---

Press the  button. Alarm is switched off.

Appliance door is open.

Close the appliance door.

Ventilation openings have been covered.

Clear ventilation openings.

Large quantities of fresh food were placed in the appliance.

Do not exceed max. freezing capacity.

### Display flashes, warning signal sounds and button is lit.

---

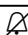
Press the  button. Alarm is switched off.



Appliance door is open.

Close the appliance door.

**Display flashes, warning signal sounds and button  is lit.**

Ventilation openings have been covered.	Clear ventilation openings.
Large quantities of fresh food were placed in the appliance.	Do not exceed max. freezing capacity.

**Display flashes.**

The temperature in the freezer compartment was too warm.	When button  has been pressed, the warmest temperature reached in the freezer compartment is displayed for 5 seconds. Press the  button. The display stops flashing.
--	--

**Appliance is not cooling, display and lighting are lit.**

Showroom mode switched on.	Start the appliance self-test. → "Appliance self-test" on page 40  When the programme has ended, the appliance switches over to normal operation.
----------------------------	--

**Customer service**

If you are unable to rectify the fault, please contact our customer service. We will always find an appropriate solution in order to avoid unnecessary visits by engineers.

The contact information for your nearest customer service can be found here or on the enclosed customer service list.

When calling, please state the product number (E-Nr.) and the production number (FD) which can be found on the rating plate.  
→ "Getting to know your appliance" on page 26

**Trust the expertise of the manufacturer.** You can therefore be sure that the repair is carried out by trained service technicians who carry original spare parts for your domestic appliances.

**Appliance self-test**

Your appliance features a self-test programme which displays the fault which your customer service can rectify.

- 1 Switch off the appliance and wait 5 minutes.
- 2 Switch on the appliance.
- 3 Within the first 10 seconds, press and hold the freezer compartment  button for 3 ... 5 seconds until an audible signal sounds. The self-test programme starts. While the self-test is running, a long audible signal sounds in the meantime.

- If 2 audible signals sound after the end of the self-test and the set temperature is displayed, your appliance is OK.
- If, at the end of the self-test, 5 audible signals sound and the freezer compartment  button flashes for 10 seconds, inform customer service.

When the programme has ended, the appliance switches over to normal operation.

**Repair order and advice on faults**

Contact information for all countries can be found on the enclosed customer service list.

GB	0344 892 8988	Calls charged at local or mobile rate.
IE	01450 2655	0.03 € per minute at peak. Off peak 0.0088 € per minute.
US	877 442 4436	toll-free

**Guarantee**

Detailed information on the warranty period and warranty conditions in your country are available from your customer service, your dealer and on our website.r



**Gaggenau Hausgeräte GmbH**  
Carl-Wery-Straße 34  
D-81739 München  
[www.gaggenau.com](http://www.gaggenau.com)

8001129652 (9808)  
zh-hk, en



**GAGGENAU**