

Your dryer

Congratulations – you have chosen to buy a modern, high-quality Gaggenau domestic appliance.
A distinctive feature of the condensation dryer with heat pump and automatic cleaning of the heat exchanger is its low energy consumption.
Every dryer which leaves our factory is carefully checked to ensure that it functions correctly and is in perfect condition.
Should you have any questions, our after-sales service will be pleased to help.

Environmentally-responsible disposal
Dispose of packaging in an environmentally-responsible manner. Keep children away from the packaging materials and packaging materials are not toys.
Reprocessing and reuse of packaging material saves raw materials, reducing waste.
All packaging materials used are in line with environmental protection requirements and reusable.

For further information about our products, accessories, spare parts and services, please visit: www.gaggenau.com

Contents

| | |
|---|-------|
| ■ Preparation | 2 |
| ■ Control panel | 2 |
| ■ Drying | 3/4 |
| ■ Display panel and buttons | 5 |
| ■ Notes on laundry | 6 |
| ■ Overview of programmes | 7 |
| ■ Important Information | 8 |
| ■ Consumption rates | 9 |
| ■ Normal noises | 10 |
| ■ What to do if ... / After-sales service | 11/12 |
| ■ Safety instructions | 13 |

Intended use

- For domestic use only.
- Only to be used for drying fabrics that have been washed with water.

Keep children younger than 3 years old away from the dryer.
Do not let children make the cleaning and maintenance work on the dryer without supervision. Do not leave children unsupervised near the dryer. Keep pets away from the dryer.
The dryer can be operated by children 8 years old and older, by persons with reduced physical, sensory or mental abilities and by persons with insufficient experience or knowledge if they are supervised or have been instructed in its use by a responsible adult.
This appliance is intended for use up to a maximum height of 4000 metres above sea level.

Preparation

Installation → Installation and maintenance instructions, Page 1

Never start the dryer if it is damaged. Inform your after-sales service.

Make sure your hands are dry. Hold the plug only.

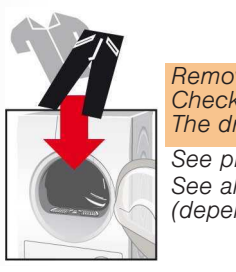

Remove all items from pockets. Check for cigarette lighters. The drum must be empty prior to loading. See programme overview on page 7. See also separate instructions for "basket for woollens" (depending on the model)

Inspect the dryer

Connect the mains plug

Sort the laundry

The dryer is switched on and off by pressing the **ⓘ** button in the centre of the programme selector. Select the programme by turning the outer ring on the programme selector (the selector can be turned in both directions). The selected programme is displayed.

Open the door/load the laundry/press the programme selector/set the programme

Close the door

Select the (START/PAUSE) button

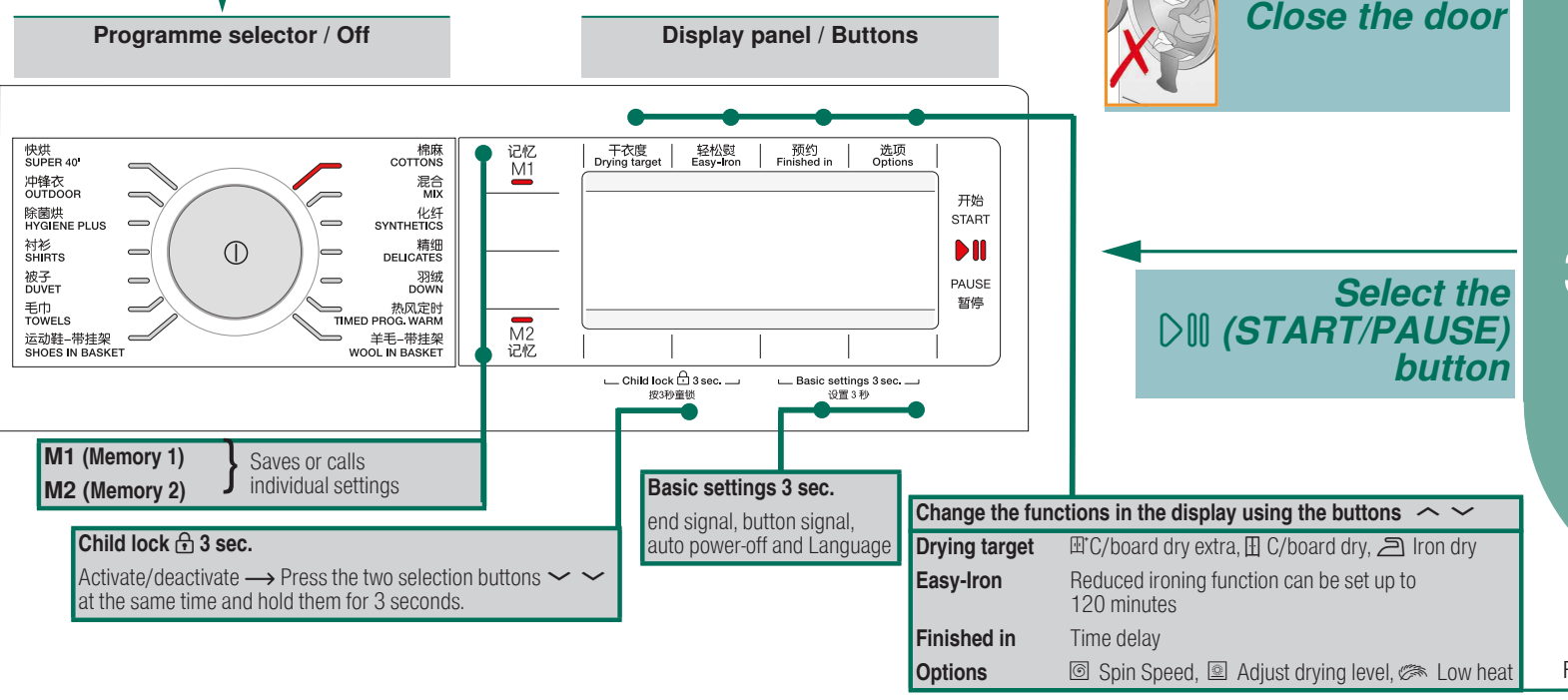

Drying

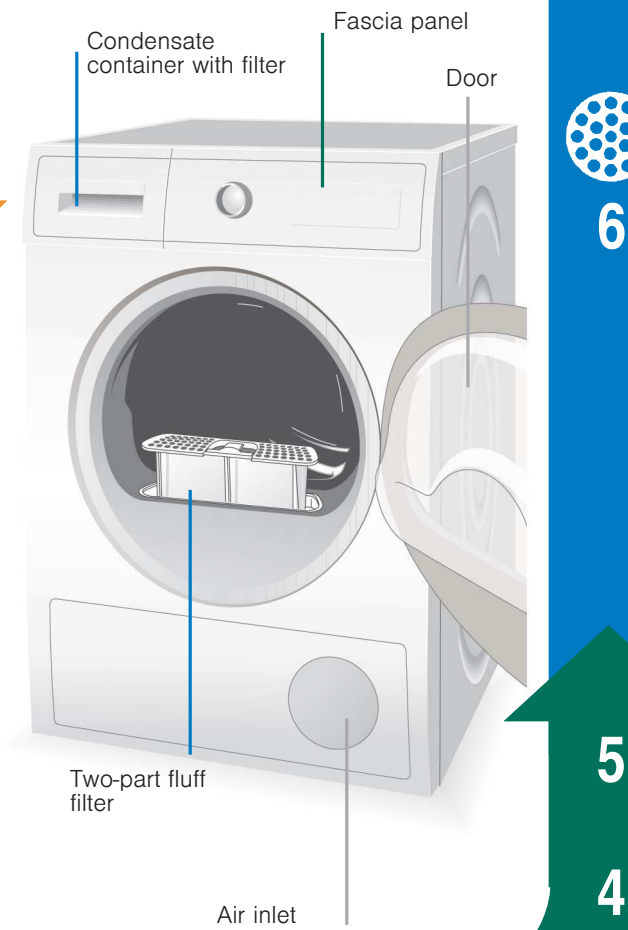

Condensate container with filter
Fascia panel
Door
Two-part fluff filter
Air inlet

Empty the condensate container
Condensation will form in the appliance as it dries the laundry. If there is no drain hose connected to the appliance, the condensation water from the appliance will run into the condensation container. In this case, you will need to empty the condensation container each time the dryer finishes drying the laundry, and also if it becomes full before drying is complete.
1. Remove the container, holding it level.
2. Pour out the condensation. Push the container back in until it clicks into place.
You must also observe the → Installation and maintenance instructions, Page 3.

Clean the fluff filters
Clean fluff filters reduce energy consumption.
The fluff filter consists of two parts. Clean the inner and outer fluff filter **after every** drying cycle.
1. Open the door. Remove fluff from the door/drum area.
2. Pull out the inner and outer fluff filter and open them out.
3. Remove any fluff, rinse both fluff filters under running water and dry thoroughly.
4. Fold the fluff filters closed, put them back together and reinsert into the appliance.

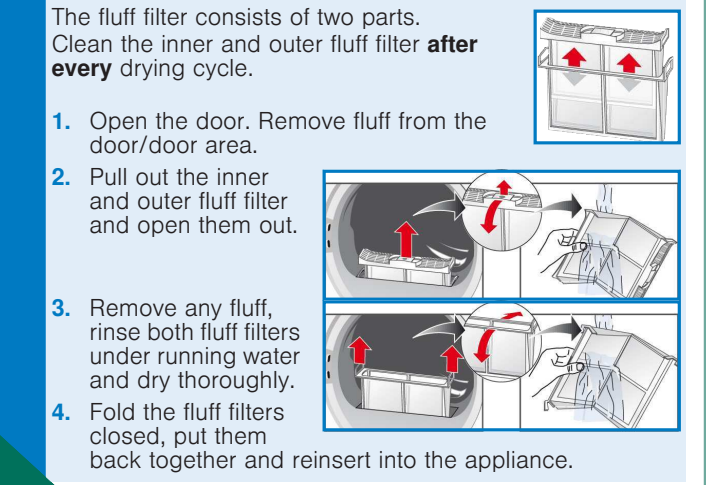

Remove the laundry and switch off the dryer

End of the programme ... Interrupt the programme
1. Open the door or press the **▷||| (START/PAUSE)** button; the drying cycle is cancelled.
2. Add or remove laundry and close the door.
3. If required, select a new programme and additional functions. Press the **▷||| (START/PAUSE)** button. The **Finished in** time is updated after a few minutes.

Display panel and buttons

Display panel

Please clean lint filter Clean the fluff filters → Page 4.
Please empty condensate container Empty the condensate container → Page 4 and/or clean the filter in the condensate container → Installation and maintenance instructions, Page 3.
Heat exchanger is being rinsed Automatic cleaning of the heat exchanger. Do not empty the condensate container while this is displayed.

Buttons

Drying target Select the dryness level (e.g. C/board dry) or the drying time (20 mins up to 3 hrs: 30 mins., depending on the model and programme).
□ **C/board Dry Extra:** For laundry with thick, multi-layered parts.
□ **C/board dry:** For single-layered laundry.
☑ **Iron Dry:** The condition of the laundry means it is suitable for ironing (iron clothes in order to avoid creases).

Easy-Iron After the programme finishes, the drum moves at regular intervals to prevent creases. Automatic reduced ironing function can be set in 30-minute intervals up to 120 minutes. The standard setting for each programme is 60 minutes.

Finished in When a programme is selected, the anticipated drying time for the maximum load is displayed. While drying, the moisture sensors detect the actual load and correct the programme length. This is shown in the display by jumps in the **Finished in** time. The **Finished in** time can be delayed in one-hour steps, up to a maximum of 24 hours. Press the **Finished in** button repeatedly until the required number of hours is displayed (h=hour).
☑ **Spin Speed;** □ **Adjust drying level;** ☁ **Low heat**
ⓘ Depending on the selected programme, it may not be possible to select individual options.
☑ **Spin Speed:** The spin speed that was used for the spin in the washing machine → used exclusively to display the anticipated drying time (**Finished in** time) more precisely.
☑ **Adjust drying level:** The drying result (e.g. C/board dry) can be increased in three stages (+1 - max. +3); exception: Timer programme → default setting = 0. After one programme has been finely adjusted, the setting is retained for the others.
☁ **Low heat:** Reduced temperature for delicate fabrics □ e.g. polyacrylic, polyamide or elastane, with a longer drying time.

M1 / M2 (Memory 1/2)
For saving individual programme settings that are used frequently. Use the programme selector to select the required programme. Press and hold the **M1 / M2 (Memory 1/2)** button for 3 seconds until the required programme has been saved.
To select the saved programme, briefly press the **M1 / M2 (Memory 1/2)** button. The programme that is called from **M1 / M2 (Memory 1/2)** is displayed on the display panel.

Basic settings 3 sec. **end signal, button signal, auto power-off and Language.**
Press and hold buttons **Basic settings 3 sec.** for 3 seconds in order to access the menu.
end signal/button signal: The signal volume level can be selected: off - quiet - medium - loud - very loud.
auto power-off: Activate/deactivate by pressing the **Basic settings 3 sec.** buttons. The dryer automatically switches off, depending on your selection, after 15, 30 or 60 minutes. The setting is active after **Easy-Iron** or end of programme.
Language: Select the required language.

Information on laundry ...

Labelling of fabrics
Follow the manufacturer's care information.
☐ Suitable for tumble drying
☑ Dry at normal temperature.
☑ Dry at low temperature.
☑ Do not tumble dry.
Do not tumble-dry the following fabrics:
– Non-breathable fabrics (e.g. rubber-coated).
– Delicate materials (silk, curtains made from synthetic material) → these may crease.
– Oil-stained laundry.
Drying tips
– To ensure a consistent drying result, sort the laundry by fabric type and drying programme.
– Always dry very small fabrics (e.g. baby socks) together with large items of laundry (e.g. towels).
– Close zips, hooks and eyelets, and button up covers. Tie cloth belts, apron strings, etc. together or use a laundry bag.
– Do not over-dry easy-care laundry → Risk of creasing. Allow laundry to finish drying in the air.
– Do not iron laundry immediately after drying; fold items up and leave for a while → residual moisture will then be distributed evenly.
– Knitted fabrics (e.g. T-shirts, jerseys) often shrink slightly the first time they are tumble-dried. → Do not use the **□ C/board dry extra** programme.
– Starched laundry is not always suitable for dryers → starch leaves behind a coating that reduces the drying effect.
– When washing laundry that is to be tumble-dried afterwards, use the correct amount of fabric softener as specified in the manufacturer's instructions.
– With a small load, use the **Timed** programme.

Environmental protection / Energy-saving tips
– Before drying, spin the laundry in the washing machine → the higher the spin speed, the shorter the drying time will be, thus less energy is consumed. Also spin easy-care laundry.
– Use the maximum recommended capacity, but do not exceed it → Programme overview, Page 7.
– Make sure the room is well ventilated during drying.
– Clean the fluff filters after every drying cycle → Cleaning the fluff filters, Page 4.
– Keep the supply of cool air unobstructed → Do not cover or block the air inlet.

Overview of Programmes → Refer to the table of consumption rates on Page 9 and the notes on Page 6.
→ Sort the laundry according to type of textile and fabric. Fabrics must be suitable for tumble drying
→ Dryness levels can be individually selected → □ C/board dry extra, □ C/board dry and ☑ Iron dry (depending on the model and programme). Degree of dryness can be finely adjusted (depending on the programme). Multi-layered fabrics require a longer drying time than single-layered items of clothing.
Recommendation: Dry separately.

| Programmes | Max. | Type of Fabric |
|-------------------------|--------|--|
| COTTONS | 9 kg | Hard-wearing fabrics, boil-resistant fabrics made of cotton or linen. |
| MIX | 3.5 kg | A mixed load of fabrics made of cotton and synthetic fabrics |
| SYNTHETICS | 3.5 kg | Fabrics made from synthetic or blended fabrics |
| DELICATES | 2 kg | Lingerie made of synthetic fibres, cotton or blended fabric. |
| DOWN | 1.5 kg | Fabrics with down filling |
| TIMED PROG. WARM | | All types of fabric except for wool and silk |
| WOOL IN BASKET | 1 kg | Hand or machine-washable fabrics made of wool or containing wool |
| SHOES IN BASKET | 1 pair | Shoes |
| SUPER 40' | 2 kg | Synthetic fibres, light cotton or mixed fabrics |
| OUTDOOR | 2 kg | Functional clothing made of microfibre |
| HYGIENE PLUS | 4 kg | Hard-wearing fabrics. |
| SHIRTS | 1.5 kg | Shirts and blouses made of cotton and blended fabrics |
| DUVET | 1.5 kg | Fabrics, pillows, quilts or bedspreads filled with synthetic fibres. Dry large items individually. Observe the care label. |
| TOWELS | 3.5 kg | Terry-towelling laundry e.g. towels and bathrobes |

Options and Notes

The program duration is valid for 4 kg spinned with 1000 rpm. During program the displayed remaining time will be adjusted to the load.

Dry non-qualified fabrics separately.
For pre-dried, multi-layered fabrics or small, individual items of laundry. Also for subsequent drying.
Use with separate basket only → see the woollens basket description.
Use with separate basket only → see the woollens basket description.
Easy-to-dry textiles.
Particularly suitable for the highest hygiene requirements.
Creasing is reduced. Not completely dried.

Important information...



Never operate the dryer without the fluff filters and without filter in condensate container!

Fluff filters

During drying, fluff and hair from the laundry is trapped by the fluff filter. A blocked fluff filter may impair the heat exchange process.

The fluff filters must therefore be cleaned after every drying cycle. Rinse regularly under running water → Page 4.

When cleaning the fluff filter, make sure that no foreign material (down, filling material) enters the air duct opening. If necessary, clean the drum beforehand with a vacuum cleaner. If foreign material should still enter the air duct → call the after-sales service.

Filter in the condensate container

The filter in the condensate container cleans the condensation. This condensation is required for the automatic cleaning process. The filter should be cleaned regularly under running water. Empty the condensate container before cleaning the filter → Installation and maintenance instructions, Page 3.

Fabrics

Do not dry any fabrics that have come into contact with solvents, oil, wax, grease or paint: e.g. hair styling products, nail varnish remover, stain remover, cleaning solvent, etc. Empty all pockets.

Do not dry non-breathable fabrics.

Avoid drying laundry items that produce a lot of fluff.

Woolens should be refreshed or dried using the woolens programme only.

Consumption values table

| Programme | Spin speed which is used for spinning the laundry | Duration** | Energy consumption** |
|-------------------|---|---------------|----------------------|
| COTTONS | | | |
| | | 9 kg | 9 kg |
| C/board Dry* | 1400 rpm | 133 min | 1.72 kWh |
| | 1000 rpm | 157 min | 2.13 kWh |
| | 800 rpm | 181 min | 2.48 kWh |
| Iron Dry* | 1400 rpm | 98 min | 1.22 kWh |
| | 1000 rpm | 123 min | 1.62 kWh |
| | 800 rpm | 147 min | 2.00 kWh |
| SYNTHETICS | | | |
| | | 3.5 kg | 3.5 kg |
| C/board Dry* | 800 rpm | 46 min | 0.52 kWh |
| | 600 rpm | 60 min | 0.66 kWh |

* Programme setting in accordance with the applicable IEC61121 standard when using the external drain hose.

** The values may differ from those specified, depending on the type of fabric, composition of laundry to be dried, residual moisture in the laundry, the degree of dryness that has been set, the amount of laundry being loaded, the environmental conditions, and any additional functions that have been activated.

Power consumption when switched off 0.10 W

Power consumption when ready for use (left-on mode) 0.10 W

Normal noises

During drying, the compressor and the pump generate some noise which is entirely normal.

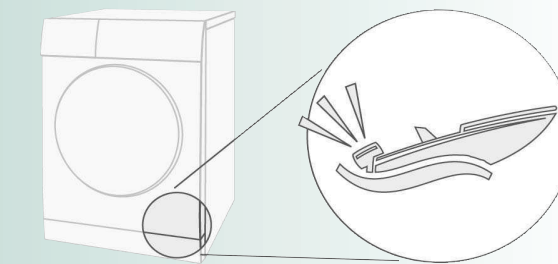

The compressor in the dryer may occasionally generate a humming noise. The volume and pitch of this may vary depending on the selected programmes and the progress of the drying.

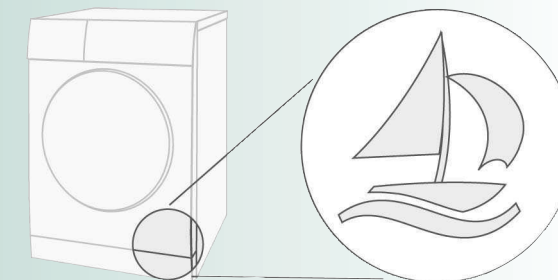

The compressor in the dryer is ventilated from time to time, which creates a whirring sound.

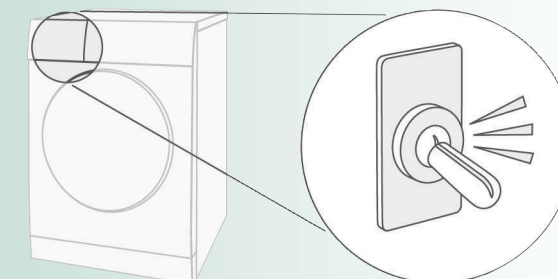

The automatic cleaning process causes a clicking noise.

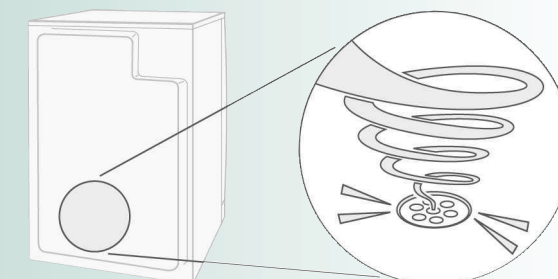

The process of pumping the condensation into the condensate container generates pumping noises.

What to do if ...



If you cannot rectify a fault yourself (e.g. by switching the dryer off/on), please contact our after-sales service. We will always find an appropriate solution and will avoid unnecessary visits by engineers. Trust the expertise of the manufacturer and rest assured that the repair will be carried out by trained service technicians using original spare parts.

The contact details of your local **after-sales service** can be found in the enclosed after-sales service directory:

– **GB** 0844 8928988 (Calls from a BT landline will be charged at up to 3 pence per minute. A call set-up fee of up to 6 pence may apply.)

– **IE** 01450 2655 (0.03 € per minute at peak. Off peak 0.0088 € per minute.) When contacting the after-sales service, please specify the product number (E-Nr.) and production number (FD) of your appliance (see inside of door).

Switch the dryer off using the programme selector and unplug the mains plug from the socket.

● **Please empty condensate container** is displayed. Emptying the condensate container → Page 4. Press any button. Press the **START/PAUSE** button again.

● **Please empty condensate container** is displayed and the drying cycle is interrupted. If the condensation drain hose is connected, check it and, if necessary, clean it. Stopper in the condensate container? → separate *Instructions for condensation drain*.

Is the filter in the condensate container dirty? → Clean the filter in the condensate container → *Installation and maintenance instructions, Page 3*.

● Residual water in the condensate container despite the dryer being connected to the condensate drain. Not a fault. If the condensation drain is installed, residual water remains in the condensate container due to the dryer's self-cleaning function.

● **Please clean lint filter** is displayed. Clean the fluff filters → Page 4. Press the **START/PAUSE** button again.

● Dryer does not start. Has the **START/PAUSE** button been pressed? Door closed? Ambient temperature greater than 5 °C? The optimum ambient temperature for drying is between 5 °C and 35 °C.

● Water is leaking out. Make sure the dryer is level. Push the condensate container back in until it locks fully into place.

What to do if ...

● Laundry is not dried correctly or is still too damp.

After the end of the programme, warm laundry feels damper than it actually is. Spread the laundry out and allow the heat to disperse.

Finely adjust the dryness level – this extends the drying time but does not increase the temperature. Your laundry will become drier.

Select a programme with a longer drying time or increase the drying level. This does not increase the temperature.

Select a time programme for extended drying of laundry that is still damp.

If you have exceeded the maximum load for the programme, the laundry may not be dried correctly.

Clean the moisture sensor in the drum. A fine layer of limescale may adversely affect the performance of the sensors and your washing will not dry properly.

Drying has been interrupted as a result of a power cut, because the condensate container is full or because the maximum drying time has been exceeded.

● Drying time too long.

Clean the fluff filters under running water → Page 4.

Insufficient supply of air → Ensure that air can circulate.

Air inlet may be obstructed? Clear the inlet → *Installation and maintenance instructions, Page 1*.

Ambient temperature higher than 35 °C → Ventilate the room. The optimum ambient temperature for drying is between 5 °C and 35 °C. Outside of this range, the drying time may increase.

● The humidity in the room increases significantly.

Make sure the room is sufficiently ventilated.

● **Heat exchanger is being rinsed** is displayed in the display panel.

Not an error. Automatic cleaning of the heat exchanger. Do not empty the condensate container during the cleaning process.

● Power failure.

Remove the laundry from the dryer immediately and spread out. This allows the heat to dissipate. Be careful as the door, the drum and the laundry may be hot.

● Other intermittent noises and vibrations.

Normal noises → Page 10.

Safety instructions



Emergency ONLY use the dryer...

The dryer must NEVER...

Hazards

- Pull the appliance plug out of the socket immediately or disconnect the fuse.
- in rooms inside the house.
- to dry fabrics.
- be used for purposes other than those described above.
- be modified in terms of its technology or properties.
- The dryer must not be used by children or persons who have not been instructed in its use.
- Do not leave children unsupervised near the dryer.
- Keep pets away from the dryer.
- Remove all objects from pockets, and lighters in particular → **Risk of explosion**.
- Do not lean or sit on the door → **Risk of tipping**.
- Open the door carefully. Hot steam may escape. Fabrics and drum may be hot → **Risk of burns**.

Installation

- Secure loose leads or hoses, otherwise there is a **risk of tripping**.
- Below 0 °C there is a possibility of frost damage.

Mains connection

- Connect the dryer to an AC earthed socket according to specifications, otherwise it cannot be guaranteed that the appliance is completely safe.
- The cable cross-section must be sufficient.

- Only use earth-leakage circuit breakers with the following symbol:
- The appliance plug and socket must be compatible.
- Do not use multiple plugs/connectors and/or extension cables.
- Do not touch or hold the appliance plug with wet hands → **Risk of electric shock**.

Operation

- Only load the dryer as recommended in the programme descriptions (*Programmes/fabrics, Page 1* and *Programme overview, Page 7*). Check the contents before you switch the dryer on.
- Do not use the dryer if the laundry has been in contact with solvents, oil, wax, grease or paint (e.g. hair styling products, nail varnish remover, stain remover, cleaning solvent, etc.) → **Risk of fire/explosion**.
- The tumble dryer is not to be used if industrial chemicals have been used for cleaning.
- Dust (e.g. coal dust, flour) poses a danger: Do not use the dryer → **Risk of explosion**.
- Do not turn off the dryer until the drying process ends, unless the laundry will be removed quickly and spread out, so that the heat can dissipate.
- Do not put laundry containing foam material/rubber in the dryer → elastic material may be destroyed and the dryer may be damaged due to possible deformation of the foam material.
- Light things, such as long hair, may be sucked into the air inlet of the dryer → **Risk of injury**.
- Final part of a tumble dryer cycle occurs without heat (cool down cycle), to ensure that the items are left at a temperature that ensures that the items will not be damaged.
- Switch off the dryer once the programme has ended.
- The distilled water/water from condensation is not drinking water and may be contaminated with fluff.

Defect

- Do not use the dryer if it is defective or if you suspect that it is. Repairs must only be carried out by the after-sales service.
- Do not use the dryer if the mains cable is defective. To avoid danger, only have the defective mains cable replaced by the after-sales service.

Spare parts

- Only use genuine spare parts and accessories for safety reasons.

Disposal

- Dryer: Pull out the appliance plug, **then** cut off the mains cable from the appliance. Dispose of the appliance at a municipal waste disposal facility.
- Packaging: Keep all packaging out of reach of babies and children → **Risk of suffocation**.
- The dryer's heat exchanger contains fluorinated greenhouse gas (R407C) in a hermetically sealed unit → Dispose of this properly. Capacity: 0.290 kg. Total GWP: 0.514 tCO₂.
- All materials are environmentally sound and can be reused. Dispose of in an environmentally-responsible manner.

Tumble dryer WT 260110CN



Observe the safety instructions on Page 13.



You must read this instruction manual and the **Installation and maintenance instructions** before using the dryer. To install the condensation drain, follow the **Condensation drain instructions** (provided separately)!

Your dryer

Congratulations – you have chosen to buy a modern, high-quality Gaggenau domestic appliance.

A distinctive feature of the condensation dryer with heat pump and automatic cleaning of the heat exchanger is its low energy consumption.

Every dryer which leaves our factory is carefully checked to ensure that it functions correctly and is in perfect condition.

Should you have any questions, our after-sales service will be pleased to help.

Environmentally-responsible disposal

Dispose of packaging in an environmentally-responsible manner.

Keep children away from the packaging materials and packaging materials are not toys.

Reprocessing and reuse of packaging material saves raw materials, reducing waste.

All packaging materials used are in line with environmental protection requirements and reusable.

For further information about our products, accessories, spare parts and services, please visit: www.gaggenau.com

Contents

| | Page |
|---|-------|
| ■ Preparation | 2 |
| ■ Control panel | 2 |
| ■ Drying | 3/4 |
| ■ Display panel and buttons | 5 |
| ■ Notes on laundry | 6 |
| ■ Overview of programmes | 7 |
| ■ Important Information | 8 |
| ■ Consumption rates | 9 |
| ■ Normal noises | 10 |
| ■ What to do if ... / After-sales service | 11/12 |
| ■ Safety instructions | 13 |

Intended use

- For domestic use only.
- Only to be used for drying fabrics that have been washed with water.



Keep children younger than 3 years old away from the dryer.

Do not let children make the cleaning and maintenance work on the dryer without supervision. Do not leave children unsupervised near the dryer. Keep pets away from the dryer.

The dryer can be operated by children 8 years old and older, by persons with reduced physical, sensory or mental abilities and by persons with insufficient experience or knowledge if they are supervised or have been instructed in its use by a responsible adult.

This appliance is intended for use up to a maximum height of 4000 metres above sea level.

Programmes / Fabrics

Detailed overview of the programmes and fabrics → Programme overview, Page 7.

Observe the care information on the care label.

Dryness level, timer programming and options can be individually selected depending on the selected programme and the progress of the programme.

| | |
|-------------------------|--|
| COTTONS | Hard-wearing fabrics. |
| MIX | A mixed load of fabrics made of cotton or synthetic fabrics. |
| SYNTHETICS | Fabrics made from synthetic or blended fabrics. |
| DELICATES | Lingerie made of synthetic fibres, cotton or blended fabric. |
| DOWN | Fabrics with down filling. |
| TIMED PROG. WARM | All types of fabric except for wool and silk. |
| WOOL IN BASKET | Woollen fabrics that are suitable for use in washers. |
| SHOES IN BASKET | Shoes |
| SUPER 40' | Synthetic fibres, light cotton or mixed fabrics. |
| OUTDOOR | Functional clothing made of microfibre. |
| HYGIENE PLUS | Hard-wearing fabrics. |
| SHIRTS | Shirts and blouses made of cotton and blended fabrics. |
| DUVET | Fabrics, pillows, quilts or bedspreads filled with synthetic fibres. |
| TOWELS | Terry-towelling laundry e.g. towels and bathrobes |

Preparation

Installation → Installation and main



Never start
Inform you

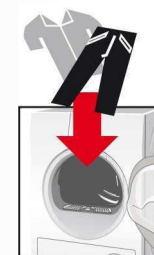

The dryer is switched on and off by pressing the ① button in the centre of the programme selector. Select the programme by turning the outer ring on the programme selector (the selector can be turned in both directions). The selected programme is displayed.

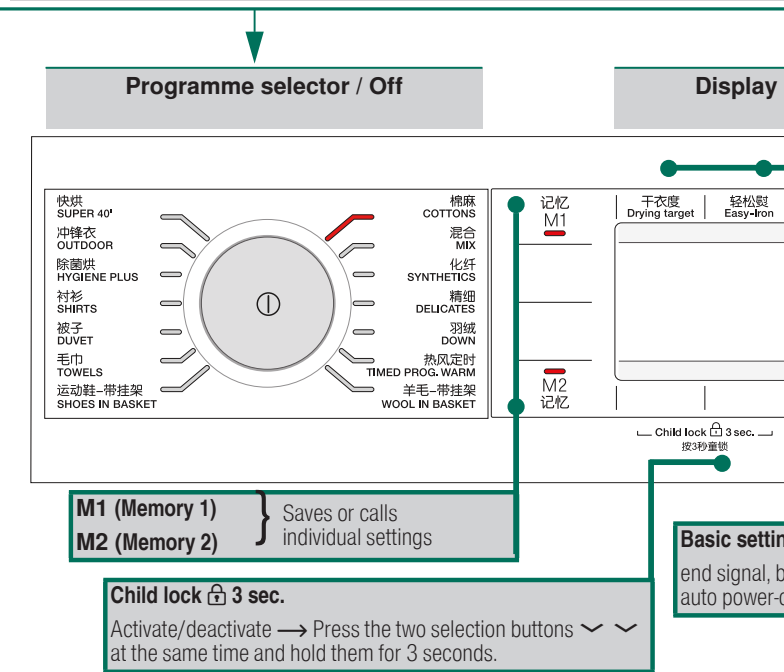

M1 (Memory 1)
M2 (Memory 2) } Saves or calls individual settings

Child lock 3 sec.
Activate/deactivate → Press the two selection buttons at the same time and hold them for 3 seconds.

Basic settings
end signal, b
auto power-o

...t the dryer if it is damaged.
...r after-sales service.

Make sure your hands are dry.
Hold the plug only.

Inspect the dryer

Connect the mains plug

Sort the laundry

Remove all items from pockets.
Check for cigarette lighters.
The drum must be empty prior to loading.

See programme overview on page 7.
See also separate instructions for "basket for woollens"
(depending on the model)

**Open the door/load the laundry/
press the programme selector/
set the programme**

panel / Buttons

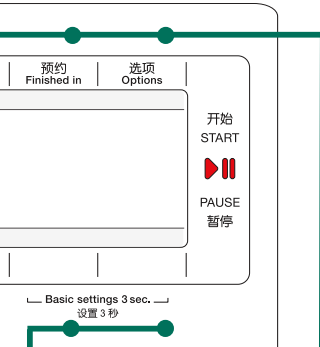

Close the door

**Select the
▶|| (START/PAUSE)
button**

...gs 3 sec.

...utton signal,
...off and Language

| Change the functions in the display using the buttons | |
|---|---|
| Drying target | ☐ C/board dry extra, ☐ C/board dry, ☐ Iron dry |
| Easy-Iron | Reduced ironing function can be set up to 120 minutes |
| Finished in | Time delay |
| Options | ☐ Spin Speed, ☐ Adjust drying level, ☐ Low heat |

Drying



1

2

3

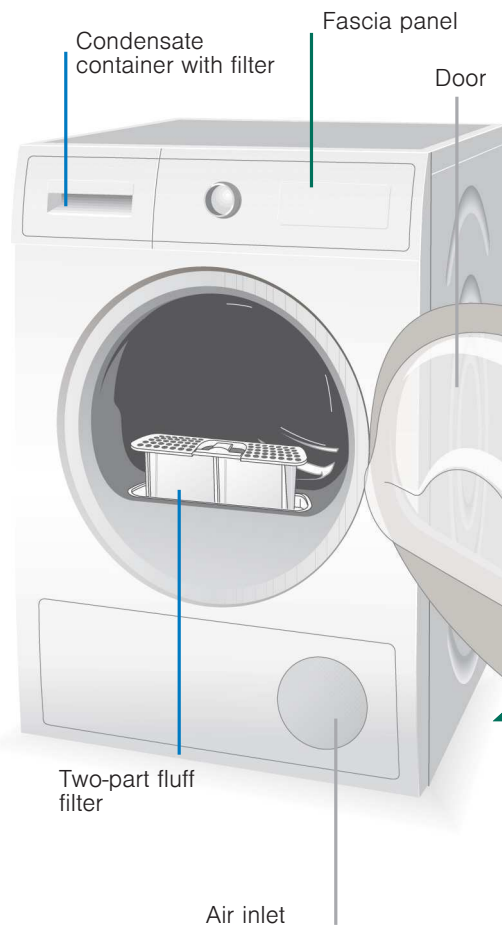

6

7

Empty the condensate container

Condensation will form in the appliance as it dries the laundry. If there is no drain hose connected to the appliance, the condensation water from the appliance will run into the condensation container. In this case, you will need to empty the condensation container each time the dryer finishes drying the laundry, and also if it becomes full before drying is complete.

1. Remove the container, holding it level.
 2. Pour out the condensation. Push the container back in until it clicks into place.
- You must also observe the → *Installation and maintenance instructions*, Page 3.

Clean the fluff filters

i Clean fluff filters reduce energy consumption.

The fluff filter consists of two parts. Clean the inner and outer fluff filter **after every** drying cycle.

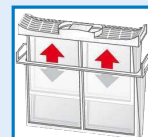

1. Open the door. Remove fluff from the door/door area.
2. Pull out the inner and outer fluff filter and open them out.
3. Remove any fluff, rinse both fluff filters under running water and dry thoroughly.
4. Fold the fluff filters closed, put them back together and reinsert into the appliance.

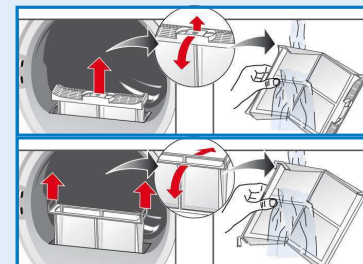

Remove the laundry and switch off the dryer

End of the programme ...

Interrupt the programme

1. Open the door or press the ▶|| (START/PAUSE) button; the drying cycle is cancelled.
2. Add or remove laundry and close the door.
3. If required, select a new programme and additional functions. Press the ▶|| (START/PAUSE) button. The **Finished in** time is updated after a few minutes.

Drying









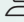

Further information can be found on page 5

Display panel and buttons

Display panel

- Please clean lint filter** Clean the fluff filters → *Page 4*.
- Please empty condensate container** Empty the condensate container → *Page 4* and/or clean the filter in the condensate container → *Installation and maintenance instructions, Page 3*.
- Heat exchanger is being rinsed** Automatic cleaning of the heat exchanger. Do not empty the condensate container while this is displayed.

Buttons

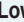
- Drying target** Select the dryness level (e.g. C/board dry) or the drying time (20 mins up to 3 hrs: 30 mins., depending on the model and programme).
-  **C/board Dry Extra:** For laundry with thick, multi-layered parts.
-  **C/board dry:** For single-layered laundry.
-  **Iron Dry:** The condition of the laundry means it is suitable for ironing (iron clothes in order to avoid creases).
- Easy-Iron** After the programme finishes, the drum moves at regular intervals to prevent creases. Automatic reduced ironing function can be set in 30-minute intervals up to 120 minutes. The standard setting for each programme is 60 minutes.
- Finished in** When a programme is selected, the anticipated drying time for the maximum load is displayed. While drying, the moisture sensors detect the actual load and correct the programme length. This is shown in the display by jumps in the **Finished in** time. The **Finished in** time can be delayed in one-hour steps, up to a maximum of 24 hours. Press the **Finished in** button repeatedly until the required number of hours is displayed (h=hour).
- Options**  **Spin Speed;**  **Adjust drying level;**  **Low heat**
-  Depending on the selected programme, it may not be possible to select individual options.
-  **Spin Speed:** The spin speed that was used for the spin in the washing machine → used exclusively to display the anticipated drying time (**Finished in** time) more precisely.
-  **Adjust drying level:** The drying result (e.g. C/board dry) can be increased in three stages (+1 - max. +3); exception: Timer programme → default setting = 0. After one programme has been finely adjusted, the setting is retained for the others.
-  **Low heat:** Reduced temperature for delicate fabrics , e.g. polyacrylic, polyamide or elastane, with a longer drying time.
- M1 / M2 (Memory 1/2)** For saving individual programme settings that are used frequently. Use the programme selector to select the required programme. Press and hold the **M1 / M2 (Memory 1/2)** button for 3 seconds until the required programme has been saved. To select the saved programme, briefly press the **M1 / M2 (Memory 1/2)** button. The programme that is called from **M1 / M2 (Memory 1/2)** is displayed on the display panel.
- Basic settings 3 sec.** **end signal, button signal, auto power-off** and **Language**. Press and hold buttons **Basic settings 3 sec.** for 3 seconds in order to access the menu.
- end signal/button signal:** The signal volume level can be selected: off - quiet - medium - loud - very loud.
- auto power-off:** Activate/deactivate by pressing the **Basic settings 3 sec.** buttons. The dryer automatically switches off, depending on your selection, after 15, 30 or 60 minutes. The setting is active after **Easy-Iron** or end of programme.
- Language:** Select the required language.

Information on laundry ...



Labelling of fabrics

Follow the manufacturer's care information.

- Suitable for tumble drying
- Dry at normal temperature.
- Dry at low temperature.
- Do not tumble dry.

Do not tumble-dry the following fabrics:

- Non-breathable fabrics (e.g. rubber-coated).
- Delicate materials (silk, curtains made from synthetic material) → these may crease.
- Oil-stained laundry.

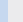

Drying tips

- To ensure a consistent drying result, sort the laundry by fabric type and drying programme.
- Always dry very small fabrics (e.g. baby socks) together with large items of laundry (e.g. towels).
- Close zips, hooks and eyelets, and button up covers. Tie cloth belts, apron strings, etc. together or use a laundry bag.
- Do not over-dry easy-care laundry → Risk of creasing. Allow laundry to finish drying in the air.
- Do not iron laundry immediately after drying; fold items up and leave for a while → residual moisture will then be distributed evenly.
- Knitted fabrics (e.g. T-shirts, jerseys) often shrink slightly the first time they are tumble-dried. → Do not use the  **C/board dry extra** programme.
- Starched laundry is not always suitable for dryers → starch leaves behind a coating that reduces the drying effect.
- When washing laundry that is to be tumble-dried afterwards, use the correct amount of fabric softener as specified in the manufacturer's instructions.
- With a small load, use the Timed programme.

Environmental protection / Energy-saving tips

- Before drying, spin the laundry in the washing machine → the higher the spin speed, the shorter the drying time will be, thus less energy is consumed. Also spin easy-care laundry.
- Use the maximum recommended capacity, but do not exceed it → *Programme overview, Page 7*.
- Make sure the room is well ventilated during drying.
- Clean the fluff filters after every drying cycle → *Cleaning the fluff filters, Page 4*.
- Keep the supply of cool air unobstructed → Do not cover or block the air inlet.

Overview of Programmes → Refer to the table of consumption rates on Page 9 and the notes on Page 6.

→ Sort the laundry according to type of textile and fabric. Fabrics must be suitable for tumble drying
 → Dryness levels can be individually selected →  C/board dry extra,  C/board dry and  Iron dry (depending on the model and programme). Degree of dryness can be finely adjusted (depending on the programme). Multi-layered fabrics require a longer drying time than single-layered items of clothing.
 Recommendation: Dry separately.

| Programmes | Max. | Type of Fabric | Options and Notes |
|-------------------------|--------|--|---|
| COTTONS | 9 kg | Hard-wearing fabrics, boil-resistant fabrics made of cotton or linen. | The program duration is valid for 4 kg spinned with 1000 rpm. During program the displayed remaining time will be adjusted to the load. |
| MIX | 3.5 kg | A mixed load of fabrics made of cotton and synthetic fabrics | |
| SYNTHETICS | 3.5 kg | Fabrics made from synthetic or blended fabrics | |
| DELICATES | 2 kg | Lingerie made of synthetic fibres, cotton or blended fabric. | |
| DOWN | 1.5 kg | Fabrics with down filling | Dry non-quilted fabrics separately. |
| TIMED PROG. WARM | | All types of fabric except for wool and silk | For pre-dried, multi-layered fabrics or small, individual items of laundry. Also for subsequent drying. |
| WOOL IN BASKET | 1 kg | Hand or machine-washable fabrics made of wool or containing wool | Use with separate basket only → see the woollens basket description. |
| SHOES IN BASKET | 1 pair | Shoes | Use with separate basket only → see the woollens basket description. |
| SUPER 40' | 2 kg | Synthetic fibres, light cotton or mixed fabrics | Easy-to-dry textiles. |
| OUTDOOR | 2 kg | Functional clothing made of microfibre | |
| HYGIENE PLUS | 4 kg | Hard-wearing fabrics. | Particularly suitable for the highest hygiene requirements. |
| SHIRTS | 1.5 kg | Shirts and blouses made of cotton and blended fabrics | Creasing is reduced. Not completely dried. |
| DUVET | 1.5 kg | Fabrics, pillows, quilts or bedspreads filled with synthetic fibres. Dry large items individually. Observe the care label. | |
| TOWELS | 3.5 kg | Terry-towelling laundry e.g. towels and bathrobes | |

9711 / 9001358415



Gaggenau Hausgeräte GmbH
 Carl-Wery-Str. 34
 81739 München / Deutschland

WT2601 10CN

Important information...

Your dryer is designed to be particularly energy efficient. Its technical features include a refrigeration circuit, which uses energy efficiently in a similar way to a refrigerator. The dryer's heat exchanger is cleaned automatically during drying. The fluff filters and filter in the condensate container must be cleaned regularly.



Never operate the dryer without the fluff filters and without filter in condensate container!

Fluff filters

During drying, fluff and hair from the laundry is trapped by the fluff filter. A blocked fluff filter may impair the heat exchange process.

The fluff filters must therefore be cleaned after every drying cycle.

Rinse regularly under running water → Page 4.

When cleaning the fluff filter, make sure that no foreign material (down, filling material) enters the air duct opening. If necessary, clean the drum beforehand with a vacuum cleaner.

If foreign material should still enter the air duct → call the after-sales service.

Filter in the condensate container

The filter in the condensate container cleans the condensation. This condensation is required for the automatic cleaning process. The filter should be cleaned regularly under running water. Empty the condensate container before cleaning the filter → *Installation and maintenance instructions, Page 3.*

Fabrics

Do not dry any fabrics that have come into contact with solvents, oil, wax, grease or paint: e.g. hair styling products, nail varnish remover, stain remover, cleaning solvent, etc.

Empty all pockets.

Do not dry non-breathable fabrics.

Avoid drying laundry items that produce a lot of fluff.

Woollens should be refreshed or dried using the woollens programme only.

Consumption values table

| Programme | Spin speed which is used for spinning the laundry | Duration** | Energy consumption** |
|-------------------|---|---------------|----------------------|
| COTTONS | | 9 kg | 9 kg |
| ☒ C/board Dry* | 1400 rpm | 133 min | 1.72 kWh |
| | 1000 rpm | 157 min | 2.13 kWh |
| | 800 rpm | 181 min | 2.48 kWh |
| ☒ Iron Dry* | 1400 rpm | 98 min | 1.22 kWh |
| | 1000 rpm | 123 min | 1.62 kWh |
| | 800 rpm | 147 min | 2.00 kWh |
| SYNTHETICS | | 3.5 kg | 3.5 kg |
| ☒ C/board Dry* | 800 rpm | 46 min | 0.52 kWh |
| | 600 rpm | 60 min | 0.66 kWh |

* Programme setting in accordance with the applicable IEC61121 standard when using the external drain hose.

** The values may differ from those specified, depending on the type of fabric, composition of laundry to be dried, residual moisture in the laundry, the degree of dryness that has been set, the amount of laundry being loaded, the environmental conditions, and any additional functions that have been activated.

Power consumption when switched off 0.10 W

Power consumption when ready for use (left-on mode) 0.10 W

Normal noises

During drying, the compressor and the pump generate some noise which is entirely normal.

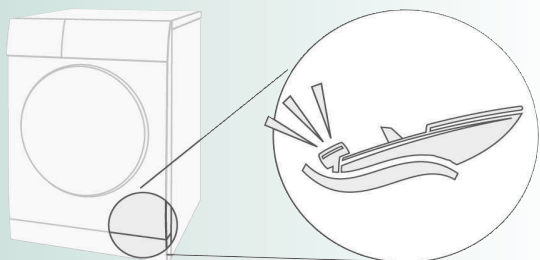

The compressor in the dryer may occasionally generate a humming noise. The volume and pitch of this may vary depending on the selected programmes and the progress of the drying.

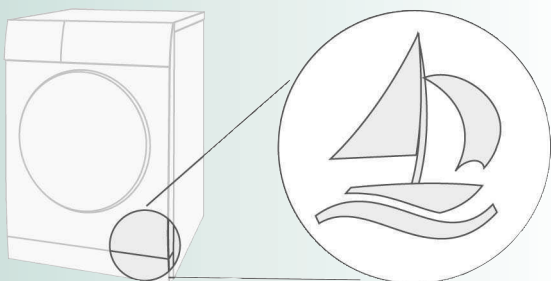

The compressor in the dryer is ventilated from time to time, which creates a whirring sound.

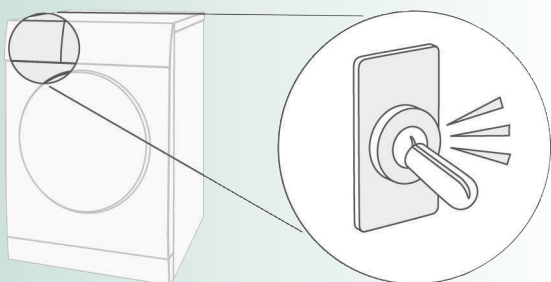

The automatic cleaning process causes a clicking noise.

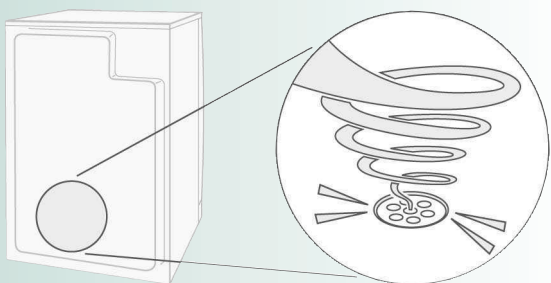

The process of pumping the condensation into the condensate container generates pumping noises.

What to do if ...



If you cannot rectify a fault yourself (e.g. by switching the dryer off/on), please contact our after-sales service.

We will always find an appropriate solution and will avoid unnecessary visits by engineers. Trust the expertise of the manufacturer and rest assured that the repair will be carried out by trained service technicians using original spare parts.

The contact details of your local **after-sales service** can be found in the enclosed after-sales service directory:

– **GB** 0844 8928988 (Calls from a BT landline will be charged at up to 3 pence per minute.

A call set-up fee of up to 6 pence may apply.)

– **IE** 01450 2655 (0.03 € per minute at peak. Off peak 0.0088 € per minute.) When contacting the after-sales service, please specify the product number (E-Nr.) and production number (FD) of your appliance (see inside of door).

Switch the dryer off using the programme selector and unplug the mains plug from the socket.

- **Please empty condensate container** is displayed. Emptying the condensate container → *Page 4*. Press any button. Press the  (**START/PAUSE**) button again.

- **Please empty condensate container** is displayed and the drying cycle is interrupted. If the condensation drain hose is connected, check it and, if necessary, clean it. Stopper in the condensate container? → separate *Instructions for condensation drain*.

Is the filter in the condensate container dirty? → Clean the filter in the condensate container → *Installation and maintenance instructions, Page 3*.

- Residual water in the condensate container despite the dryer being connected to the condensate drain. Not a fault. If the condensation drain is installed, residual water remains in the condensate container due to the dryer's self-cleaning function.

- **Please clean lint filter** is displayed. Clean the fluff filters → *Page 4*. Press the  (**START/PAUSE**) button again.

- Dryer does not start. Has the  (**START/PAUSE**) button been pressed? Door closed? Ambient temperature greater than 5 °C? The optimum ambient temperature for drying is between 5 °C and 35 °C.

- Water is leaking out. Make sure the dryer is level. Push the condensate container back in until it locks fully into place.

What to do if ...

- Laundry is not dried correctly or is still too damp.

After the end of the programme, warm laundry feels damper than it actually is. Spread the laundry out and allow the heat to disperse.

Finely adjust the dryness level – this extends the drying time but does not increase the temperature. Your laundry will become drier.

Select a programme with a longer drying time or increase the drying level. This does not increase the temperature.

Select a time programme for extended drying of laundry that is still damp.

If you have exceeded the maximum load for the programme, the laundry may not be dried correctly.

Clean the moisture sensor in the drum. A fine layer of limescale may adversely affect the performance of the sensors and your washing will not dry properly.

Drying has been interrupted as a result of a power cut, because the condensate container is full or because the maximum drying time has been exceeded.

- Drying time too long.

Clean the fluff filters under running water → *Page 4*.

Insufficient supply of air → Ensure that air can circulate.

Air inlet may be obstructed? Clear the inlet → *Installation and maintenance instructions, Page 1*.

Ambient temperature higher than 35 °C → Ventilate the room. The optimum ambient temperature for drying is between 5 °C and 35 °C. Outside of this range, the drying time may increase.

- The humidity in the room increases significantly.

Make sure the room is sufficiently ventilated.

- **Heat exchanger is being rinsed** is displayed in the display panel.

Not an error. Automatic cleaning of the heat exchanger. Do not empty the condensate container during the cleaning process.

- Power failure.

Remove the laundry from the dryer immediately and spread out. This allows the heat to dissipate. Be careful as the door, the drum and the laundry may be hot.

- Other intermittent noises and vibrations.

Normal noises → *Page 10*.

Safety instructions



- Emergency ONLY use the dryer...**
 - Pull the appliance plug out of the socket immediately or disconnect the fuse.
 - in rooms inside the house.
 - to dry fabrics.
- The dryer must NEVER...**
 - be used for purposes other than those described above.
 - be modified in terms of its technology or properties.
- Hazards**
 - The dryer must not be used by children or persons who have not been instructed in its use.
 - Do not leave children unsupervised near the dryer.
 - Keep pets away from the dryer.
 - Remove all objects from pockets, and lighters in particular → **Risk of explosion.**
 - Do not lean or sit on the door → **Risk of tipping.**
 - Open the door carefully. Hot steam may escape. Fabrics and drum may be hot → **Risk of burns.**
- Installation**
 - Secure loose leads or hoses, otherwise there is a **risk of tripping.**
 - Below 0 °C there is a possibility of frost damage.
- Mains connection**
 - Connect the dryer to an AC earthed socket according to specifications, otherwise it cannot be guaranteed that the appliance is completely safe.
 - The cable cross-section must be sufficient.
 - Only use earth-leakage circuit breakers with the following symbol: 
 - The appliance plug and socket must be compatible.
 - Do not use multiple plugs/connectors and/or extension cables.
 - Do not touch or hold the appliance plug with wet hands → **Risk of electric shock.**
 - Never pull the appliance plug out of the socket by its cable.
 - Do not damage the mains lead → **Risk of electric shock.**
- Operation**
 - Only load the dryer as recommended in the programme descriptions (*Programmes/fabrics, Page 1* and *Programme overview, Page 7*). Check the contents before you switch the dryer on.
 - Do not use the dryer if the laundry has been in contact with solvents, oil, wax, grease or paint (e.g. hair styling products, nail varnish remover, stain remover, cleaning solvent, etc.) → **Risk of fire/explosion.**
 - The tumble dryer is not to be used if industrial chemicals have been used for cleaning.
 - Dust (e.g. coal dust, flour) poses a danger: Do not use the dryer → **Risk of explosion.**
 - Do not turn off the dryer until the drying process ends, unless the laundry will be removed quickly and spread out, so that the heat can dissipate.
 - Do not put laundry containing foam material/rubber in the dryer → elastic material may be destroyed and the dryer may be damaged due to possible deformation of the foam material.
 - Light things, such as long hair, may be sucked into the air inlet of the dryer → **Risk of injury.**
 - Final part of a tumble dryer cycle occurs without heat (cool down cycle), to ensure that the items are left at a temperature that ensures that the items will not be damaged.
 - Switch off the dryer once the programme has ended.
 - The distilled water/water from condensation is not drinking water and may be contaminated with fluff.
- Defect**
 - Do not use the dryer if it is defective or if you suspect that it is. Repairs must only be carried out by the after-sales service.
 - Do not use the dryer if the mains cable is defective. To avoid danger, only have the defective mains cable replaced by the after-sales service.
- Spare parts Disposal**
 - Only use genuine spare parts and accessories for safety reasons.
 - Dryer: Pull out the appliance plug, **then** cut off the mains cable from the appliance. Dispose of the appliance at a municipal waste disposal facility.
 - Packaging: Keep all packaging out of reach of babies and children → **Risk of suffocation.**
 - The dryer's heat exchanger contains fluorinated greenhouse gas (R407C) in a hermetically sealed unit → Dispose of this properly. Capacity: 0.290 kg. Total GWP: 0.514 tCO₂.
 - All materials are environmentally sound and can be reused. Dispose of in an environmentally-responsible manner.

Tumble dryer WT 260110CN



Observe the safety instructions on Page 13.



You must read this instruction manual and the **Installation and maintenance instructions** before using the dryer.

To install the condensation drain, follow the **Condensation drain instructions** (provided separately)!