



CI292102

CA050300:

Flex pan set, 3 pcs.

CA051300:

Teppan Yaki (large)

CA051301:

Teppan Yaki

CA052300:

Griddle Plate

CA055300:

Flex pan large

CA230100:

Magnetic knob, black

Flex induction hob 200 series

90 cm

CI292102

Frameless for flush mounting

Flex function for combining the rectangular cooking areas

Free positioning of cookware inside combined cooking areas

Professional cooking function for splitting the cooktop into 3 predefined heat areas

Cooking sensor function for temperature control in pots

Frying sensor function for temperature control in pans

Large cooking zone for pots up to ø 32 cm

Twist-Pad control with removable magnetic knob

Easy control of all functions with bicoloured display

Cooking zones

1 induction cooking zone ø 21 cm (2200 W, with booster 3700 W), automatically switches to ø 26 cm (2600 W, with booster 3700 W) and to ø 32 cm (3300 W, with booster 3700 W).

Handling

Twist-Pad control with removable magnetic knob.

User friendly control with bicoloured display (white / orange).

Cooking zone and cooking area marking.

Electronic power control in 17 output levels.

Features

Flex function for rectangular cooking areas.

Professional cooking function.

Cooking sensor function (in use with cooking sensor CA 060 300).

Frying sensor function.

Booster function for pots.

Booster function for pans.

Keep warm function.

Stopwatch.

Cooking timer for up to 99 minutes.

Short-term timer.

Options menu.

Power management.

Cooktop-based ventilation control (with suitable hood).

Home network integration for digital services (Home Connect) wireless via WiFi.

The use of the Home Connect functionality depends on the Home Connect services, which are not available in every country. For further information please check: home-connect.com.

Safety

Main switch.

Operation indicator.

Pot detection.

Residual heat indicator: digital 2-step

Child lock.

Safety shut-off.

Planning notes

Operates with magnetic (induction) iron pots and pans only. For an optimal heat distribution, the use of sandwich bottom cookware is recommended.

The wok pan WP 400 001 cannot be used with this appliance.

Appliance must be fixed from underneath.

Appliance weight: approx. 27.

Connection

Total connected load 11.1 KW.

Connecting cable 1.5 m without plug.

Power consumption standby/display off 0.5 W.

Power consumption standby/network 2.0 W.

Please check the user manual for how to switch off the WiFi module.

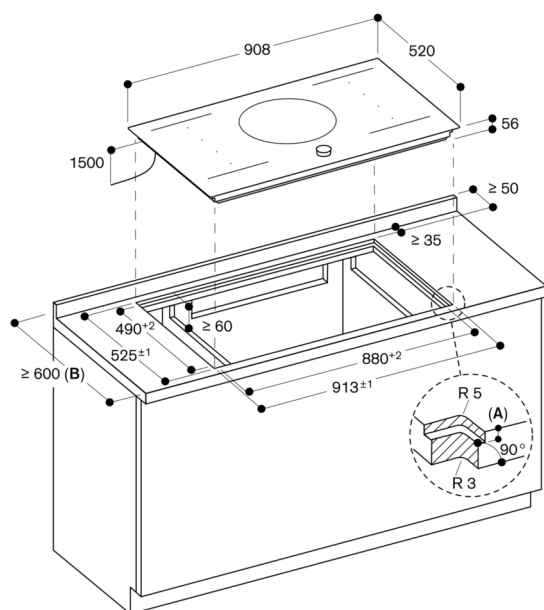

A: $6.5^{+0.5}$

B: Please check the installation manual in case the worktop depth is below 600 mm.

measurements in mm

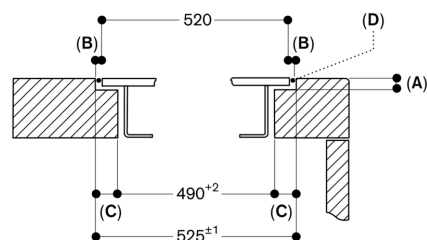

A: $6.5^{+0.5}$

B. 2.5

C: 17.5

D: Fill with silicone

measurements in mm

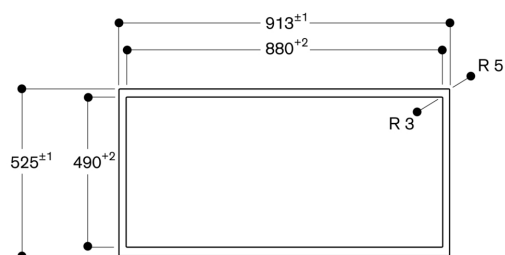

measurements in mm

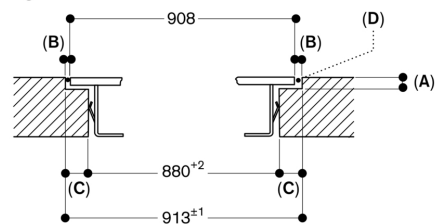
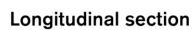

A: $6.5^{+0.5}$

B: 2.5

C: 16.5

D: Fill with silicone

measurements in mm