



DF250160
Dishwasher 200 series
fully integrated
Height 81.5 cm

13 place setting capacity.
6 programmes with aqua sensor and 2 options, Power and Intensive:
Clean and dry dishes in 59 minutes
Intensive cleaning in the lower basket while protecting glassware in the upper basket
TFT display for intuitive handling of all functions
Bright interior lighting
Very quiet: 44 dB
Aqua stop with guarantee

Handling
 TFT display indicating remaining or end time, refill for salt and rinsing agent, inflow of water.
 Touch key operation.
 Information key with use indications. Time delay up to 24 hours.
 Visual and acoustic end of programme indicator.
 Info-Light.

Technical Features
 Bright interior lighting.
 Glass protection.
 Aqua sensor.
 Load sensor.
 Automatic detergent function.
 Regeneration electronics.
 Heat exchanger.
 Continuous flow heater.
 Triple filter system.
 Soft lock.
 Aqua stop with guarantee.
 Child lock.

Programmes
 6 programmes:
 Auto 35 °C - 45 °C.
 Auto 45 °C - 65 °C.
 Auto 65 °C - 75 °C.
 Standard Eco 50 °C.
 Quick wash 45 °C (29 min.).
 Pre-rinse.
 2 options:
 Intensive.
 Power.

Features
 Flexible basket system.
 Upper basket:
 Rackmatic with 3 levels, adjustable in height up to 5 cm.
 2 folding spines.
 2 folding racks.
 1 knife rack.
 Lower basket:
 4 folding spines.
 Cutlery basket.
 Maximum dish sizes (upper/lower basket)
 27/25, 24,5/27.5 or 22/31 cm respectively.
 13 place setting capacity.

Consumption data
 2.5 energy rating, 5.5 WELS water rating
 9.7 l water consumption per wash.
 From 0.92 kWh.
 Noise level 44 dB (re 1 pW).

Planning notes
 Height-adjustable feet.
 Appliance plinth recess 100 mm (see drawing).
 Rear feet adjustable at front.
 Door weight up to 8.5 kg.
 Door panel dimension dependent on plinth height of kitchen furniture.

Characteristics
Water consumption (l)
 9.5
Built-in / Free-standing
 Built-in
Height of removable worktop (mm)
 0
Required niche size for installation (HxWxD)
 815-875 x 600 x 550
Depth with open door 90 degree (mm)
 1150
Adjustable feet
 Yes - front only
Maximum adjustability feet (mm)
 60
Adjustable plinth
Net weight (kg)
 37.330
Gross weight (kg)
 40.0
Connection Rating (W)
 2400
Current (A)
 10
Voltage (V)
 220-240
Frequency (Hz)
 50; 60
Length electrical supply cord (cm)
 175
Plug type
 Gardy plug w/ earthing
Length inlet hose (cm)
 165
Length outlet hose (cm)
 190
EAN code
 4242006251536

Consumption and connection features
Number of place settings
 13
Energy efficiency class (2010/30/EC)
 A++
Energy consumption annual (kWh/annum)
 262.00
Energy consumption (kWh)
 0.92
Power consumption in left-on mode (W) - NEW (2010/30/EC)
 0.50
Power consumption in off-mode (W) - NEW (2010/30/EC)
 0.50
Water consumption annual (l/annum)
 2660
Drying performance
 A
Reference programme
 Eco
Total cycle time of reference programme (min)
 210
Noise level (dB)
 44
Installation typology
 Full-integrated
2019-09-24
Page 1

For installation into a tall unit, ventilation openings are recommended (min. 200 cm²).

Connection
 Total connected load 2.4 kW.
 Connecting cable pluggable.
 Water connection with 3/4" screw joint.
 Connection to hot or cold water possible.

Color Variants
DF250160
fully integrated
Height 81.5 cm

Included accessories
 1 x baking tray spray head.

Installation Accessories
GH045010
Handle bar with 2 mounts, stainless steel, Length 45 cm, drilling distance 427 mm

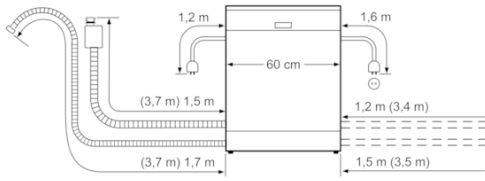

() Werte mit Verlängerungssatz

Connection dimensions for a 60 cm wide dishwasher

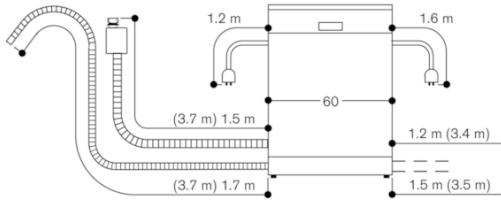

() values with extension kit

81.5 cm high dishwasher

