



AC200191



AA210110:

Active charcoal filter f. recirc. module

AA211812:

Recirculation module w.active charcoal

**Canopy extractor 200 series**  
**86 cm, Stainless steel and glass, Stainless steel**  
**AC200191**

- Energy saving low-noise fan
- Air extraction or air recirculation system
- Can be integrated invisibly in upper cabinet
- Can be integrated invisibly in upper cabinet

Energy-saving, low-noise fan

Rim extraction with flat and easy-to-clean glass cover

Dimmable, neutral white LED light for ideal illumination of the whole cooktop

Air extraction or recirculation system

Energy efficiency class A++

#### Output

Performance and noise level, output level  
 3/Intensive:

Air output according to EN 61591. Sound power level according to EN 60704-3.

Air extraction:

610 / 800m³/h.

64 / 70 dB (A) re 1 pW.

Air recirculation:

540 / 790m³/h.

72 / 77 dB (A) re 1 pW.

#### Features

Three electronically controlled power levels and an intensive mode.

Interval ventilation, 6 min.

Run-on function, 6 min

Grease filter saturation indicator.

Metal grease filter, dishwasher-safe.

Glass filter cover.

Neutral white LED light (4000 K), dimmable.

Lamp output 2 x 1W LED.

Illuminance: 266 lx

Fan technology with highly efficient, brushless DC motor.

#### Product rating

Energy efficiency class A++ at a range of energy efficiency classes from A+++ to D.

Energy consumption 31.4 kWh/year.

Ventilation efficiency class A.

Illumination efficiency class A.

Grease filter efficiency class D.

Sound level min. 41 dB / max. 64 dB normal mode.

#### Planning notes

The equivalent ducting length to ensure good performance is Lmax 19 m.

For air recirculation an external air recirculation module is required.

Patented air recirculation module with activated charcoal filter can be installed in the upper cabinet. The activated carbon filter can be changed from the front by simply pulling out the filter drawer.

The door of the upper cabinet must be fully open in order to change the activated charcoal filter.

Can be integrated invisibly in upper cabinet.

Vario cooktops with intensive production of vapours like VR/VP/VF should be placed in the middle beneath the cooker hood (in this case air recirculation is not recommended).

Clearance above gas appliances min. 65 cm (more than total load gas 12 kW min. 70 cm).

Clearance above electric appliances min. 50 cm.

When installing a ventilation hood with air extraction mode and a chimney-vented fireplace, the hood's power supply line needs to feature a suitable safety switch.

#### Connection

Total connected load 172 W.

Connecting cable 1.0 m with plug.

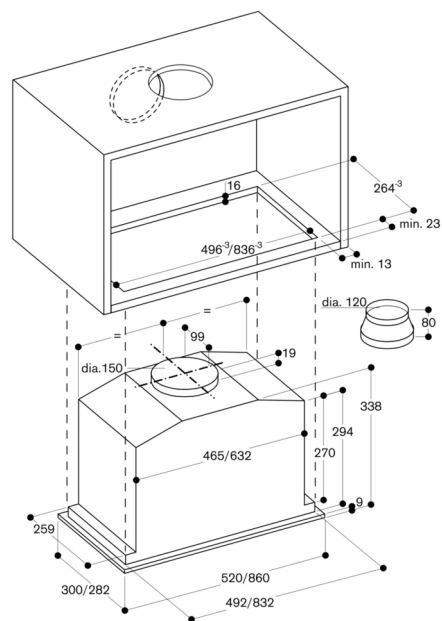

View of upper cabinet from above with AC 200 and AA 211 812

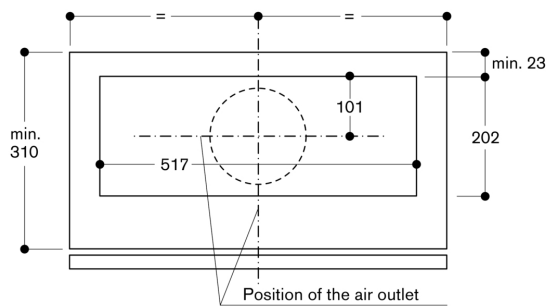

Cross-section of upper cabinet with AC 200 and AA 211 812

