

AC402181



#### Optional accessories

AA012811:

Ext.recirculation module ceiling White

AA200112:

Activated charc. filter for AA200812/816

#### installation accessories

AA010811:

Ext.recirculation mod. ceiling st.steel

AA012811:

Ext.recirculation module ceiling White

AD754048:

Air Collector Box DN 150mm round

AD854048:

Air Collector Box DN 150 flat

#### Ceiling ventilation 400 series 80 cm

AC402181

- Discreet integration into the architecture of the kitchen
- Flexible by dimension, performance and ventilation mode
- Room ventilation to always have clean and fresh air
- Perfect Integration with Vario Cooktops 400 series
- Discreet integration into the architecture of the kitchen

Flexible by dimension, performance and ventilation mode

Room ventilation

Modular ceiling ventilation which can be configured individually by separate components such as filter module, control modules and light module

Motorless, can be combined with Gaggenau BLDC remote fan units

Highly efficient patented rim extraction

Planed and easy to clean underside with covered filters

#### Output

Noise level depends on the built-in situation.

Power levels depend on the remote fan unit.

#### Features

Rim extraction filter, dishwasher-safe.

Installation frame for thread rods (rods not included).

Connection piece DN 150 cylindrical.

#### Product rating

Consumption data is referred to a configuration with the remote fan unit AR 400 142.

Energy efficiency class B at a range of energy efficiency classes from A+++ to D.

Energy consumption 60.6 kWh/year.

Ventilation efficiency class A.

Illumination efficiency class E.

Grease filter efficiency class B.

Sound level min. 50 dB / max. 65 dB normal mode.

#### Planning notes

Lmax, the equivalent ducting length to ensure good performance is depending on the configuration.

For optimum extraction performance, the maximum distance between the cooktop and the ventilation appliance is 120 cm.

The ceiling ventilation has to be handled as a room ventilation when distance to cooktop is larger than 120 cm since the direct capture of vapours will be limited.

Please consider to consult an HVAC (Heating and ventilation air conditioning) specialist.

For air recirculation an external air recirculation module is required.

When installing remote fan unit AR 400 within the ceiling or furniture block it must remain accessible through the ceiling cutout or another maintenance access.

When installing a ventilation hood with air extraction mode or recirculation outlet in another area of room air (e.g. cellar) and a chimney-vented fireplace, the hood's power supply line needs a suitable safety switch.

Minimum installation height including flat duct DN 150

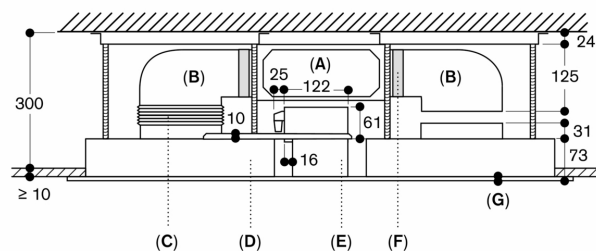

A: AD 854 048  
 B: AD 857 042  
 C: AD 751 010  
 D: AC 402 181  
 E: AC 472 181 / AC 482 181  
 F: AD 857 040  
 G: 0.8 mm

Measurements in mm

AC 402 Further possible ceiling fixture

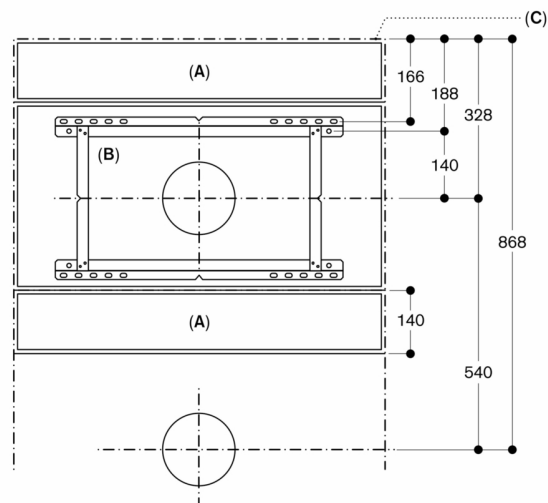

A: AC 482 / 472  
 B: AC 402  
 C: Ceiling cut-out

Measurements in mm

AC 402 Ceiling fixture and position of connecting piece DN 150

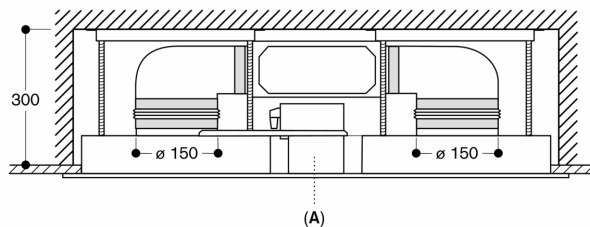

A: AC 472 181 / AC 482 181

Measurements in mm

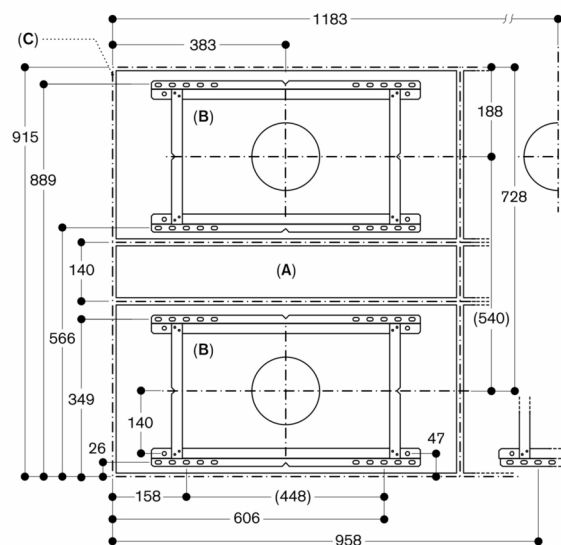

A: AC 482 / 472  
 B: AC 402  
 C: Ceiling cut-out

Measurements in mm

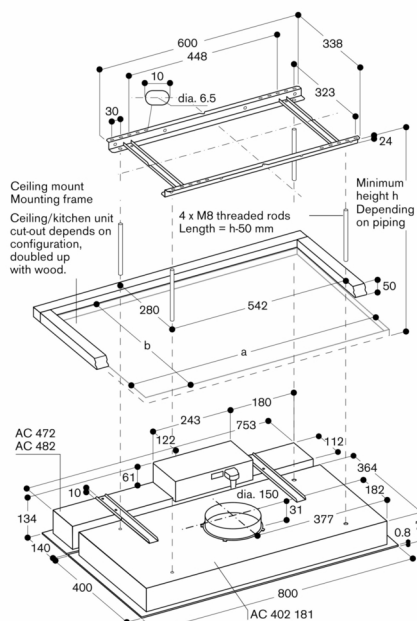
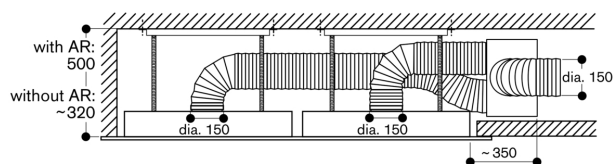
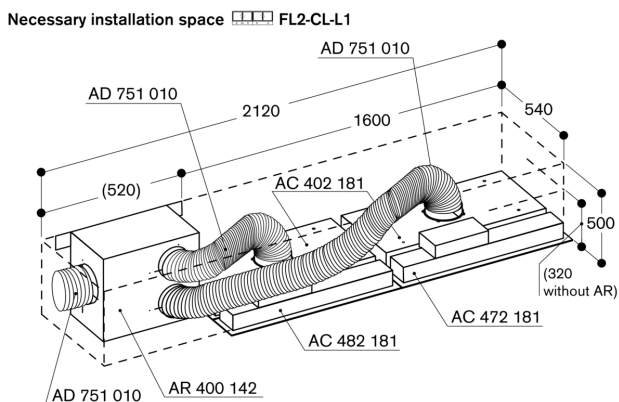
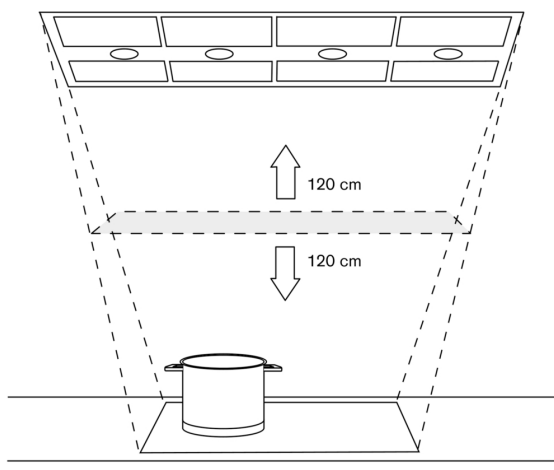
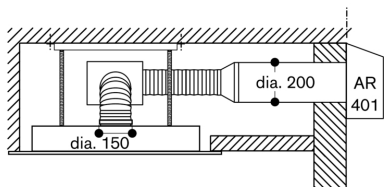
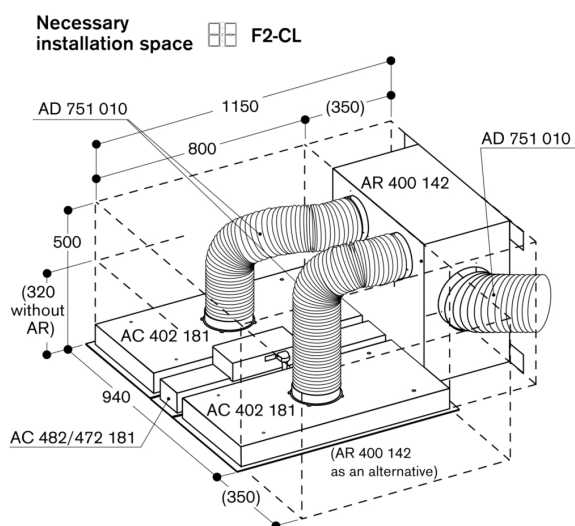

For multiple configurations:  
Ceiling deflection around cut-out: max. + 3 mm.  
Support is required in the middle to prevent deflection upwards when fastening the modules.  
The required threaded rods, nuts and ceiling bolts are supplied as standard.

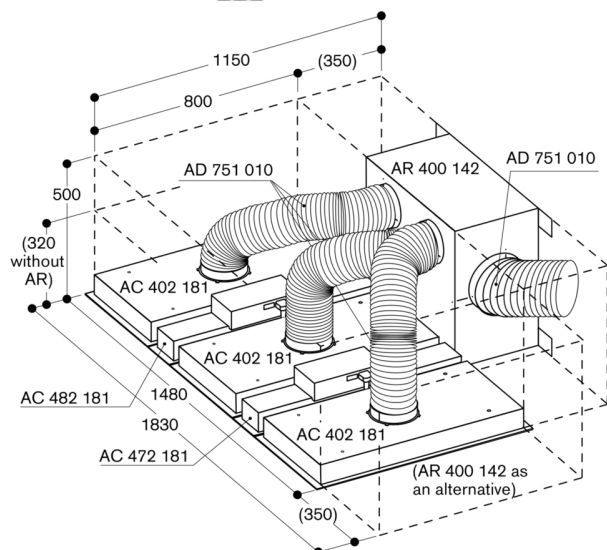
Necessary installation space  F3-CL-L1

## AC 402 with air recirculation module AA 010 810

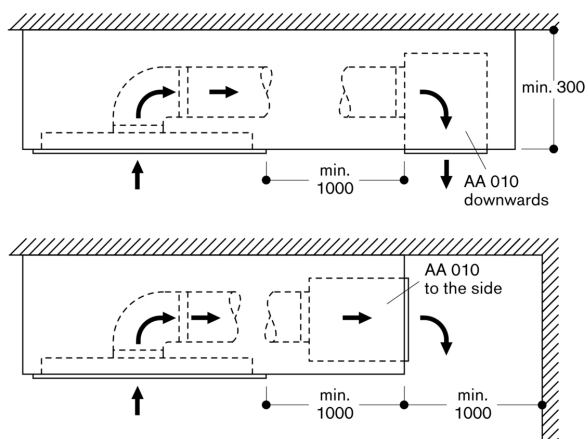

## AC 402 with air recirculation module

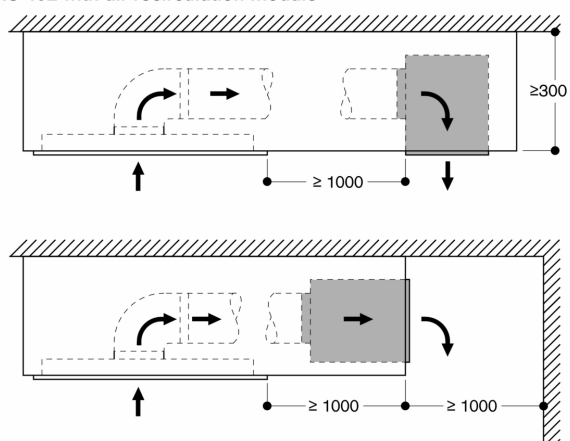

measurements in mm