



Color Variants

WM260163

Free-standing, slide-under or stackable

Width 60 cm, height 84.8 cm

WM260163

Washing machine

Free-standing, slide-under or stackable

Width 60 cm, height 84.8 cm



Intelligent dosage system iDos for automatic in-flow control of liquid detergent and softener
9 kg drum with interior lighting
Large porthole with 180 ° door opening angle
Innovative motor technology for more performance, higher durability as well as less energy consumption and noise
Anti-stain automatic for stain specific programme cycles
Combines perfectly with WT 260 101
Energy efficiency class A+++

Handling

Electronic control.
Illuminated rotary knob with integrated On-Off switch.
Touch key operation.
TFT display with clear text and symbols.
Loading indicator with dosage recommendation.
Programme sequence and remaining time display.
Time delay up to 24 hours.
Multiple signal tones.

Features

Aqua sensor.
Flow-through sensor.
Anti-stain automatic.
Continuous automatic load adjustment.
Foam detection system.
Spin speed selection from 400 to 1600 rpm.
Top-up function.
Automatic stabilisation.
Anti-crease system.
Child lock.
Integrated WiFi module for digital services (Home Connect).
The availability of the Home Connect functionality depends on the availability of the Home Connect Services in your country. Home Connect Services are not available in every country – for further information please check: www.home-connect.com

Programmes

Eco Cottons.
Easy care.
Quick/Mix.
Delicates/Silk.
Wool.
Shirts/Blouses.
Super 15/30.
Hygiene.
Sports.
Jeans.
Automatic Soft.
Automatic Intensive.
Additional Programmes: Downs, Curtains, Spinning, Rinse Plus, Drum Clean, Drain.
Options: Eco Perfect, Speed Perfect, Rinse Plus, Easy Iron, Rinse Hold, Water Plus, Silent Wash, Prewash, Stain Automatic.

Features

Powder detergent drawer with automatic cleaning mode after every wash cycle.
2 iDos tanks with 1.3 and 0.5 l capacity for liquid detergent or softener.
Stainless steel drum with wave structure.
Drum interior lighting.

Characteristics

Construction type

Free-standing

Height of removable worktop

-2

Dimensions of the product

848 x 598 x 590

Height for building under

850.00

Net weight

82.9

Connection rating

2300

Fuse protection

10

Voltage

220-240

Frequency

50

Approval certificates

CE, Eurasian, G-Mark, SG SAFETY, Ukraine, VDE

Length of electrical supply cord

160

Capacity cotton

Energy efficiency class

Washing performance class

A

Total annual energy consumption

Water consumption

Total annual water consumption

Door hinge

Left

Wheels

No

Power consumption standby/network:
Please check the user manual for how to switch off the WiFi module.

1.5

Time auto-standby/network

20.0

EAN code

4242006281816

Repair index

Capacity cotton - NEW (2010/30/EC)

9.0

Energy efficiency rating

A+++

Energy consumption annual - NEW (2010/30/EC)

152.00

Energy consumption

Power consumption in off-mode - NEW (2010/30/EC)

0.12

Power consumption in left-on mode - NEW (2010/30/EC)

0.43

Water consumption annual - NEW (2010/30/EC)

11220

Spin drying performance class

A

Maximum spin speed - NEW (2010/30/EC)

1556

Average washing time cotton 40C (partial load) - NEW (2010/30/EC)

285

Average washing time cotton 60C (full load) - NEW (2010/30/EC)

285

Average washing time cotton 60C (partial load) - NEW (2010/30/EC)

285

20

Noise level washing

47

Noise level spinning

73

Installation type

Free-standing

Consumption and connection features

created on 2022-02-27

Page 1

Volume capacity from 1 to 9 kg.

Product rating

Energy efficiency class A+++ at a range of energy efficiency classes from A++ to D.

Water consumption 11220 l/year.

Energy consumption 152 kWh/year.

Planning notes

Left-hinged.

Height-adjustable feet.

Height for slide-under installation: 85 cm.

Stackable under the tumble dryer WT 260 101 in combination with special accessory.

Connection

Total connected load 2.3 KW.

Connection cable 1.60 m with plug.

Water connection with 3/4 " screw joint.

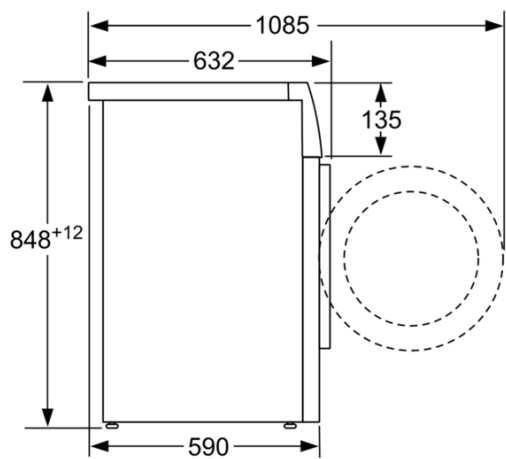

measurements in mm

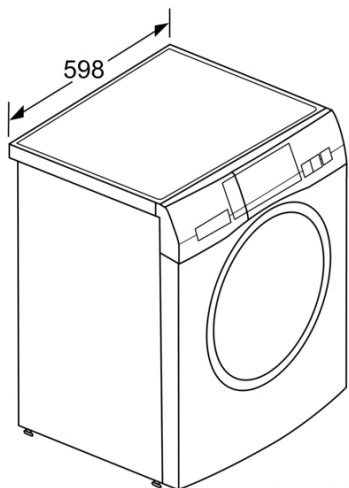

measurements in mm

