



#### Color Variants

WT260100

Free-standing, slide-under or stackable

Width 60 cm, height 84.2 cm

#### WT260100

Tumble dryer with heat pump

Free-standing, slide-under or stackable

Width 60 cm, height 84.2 cm

Can be perfectly combined with WM 260 161

Large drum with interior lighting

Large porthole with 180 ° door opening angle

Self-cleaning heat exchanger, highest comfort and constantly low consumption

Heat pump technology

Energy efficiency class A++

#### Handling

Electronic control.

Illuminated rotary knob with integrated

On-Off switch.

Touch key operation.

TFT display with clear text and symbols.

Programme sequence and remaining time display.

Time delay up to 24 h hours.

Multiple signal tones.

#### Features

Moisture and time controlled programmes.

Heat pump technology.

Self-cleaning heat exchanger.

Anti-crease cycle at programme end.

Child lock.

#### Programmes

Easy care.

Mix.

Towels.

Blankets.

Super 40.

Outdoor.

Downs.

Shirts/blouses.

#### Features

varioSoft drum system.

Volume capacity from 1 to 8 kg.

Drum interior lighting.

#### Product rating

Energy efficiency class NO\_FEATURE.

#### Planning notes

Right-hinged, reversible.

Height-adjustable feet.

Height for slide-under installation: 84.2 cm.

Stackable over the washing machine WM 260 161 in combination with special accessory.

#### Connection

Total connected load 1.0 kW.

Connection cable 1.45 m with plug.

#### Characteristics

Construction type

Free-standing

Removable work top

No

Door hinge

Right reversible

Length of electrical supply cord (cm)

145.0

Height of removable worktop (mm)

842

Dimensions of the product (mm)

842 x 598 x 599

Net weight (kg)

57.124

Fluorinated greenhouse gases

Yes

Type of refrigerant

R407C

Hermetically sealed equipment

Yes

Quantity of fluorinated gases (kg)

0.290

The quantity expressed in CO2

equivalent (t)

0.514

Power consumption standby/network:

Please check the user manual for how to switch off the WiFi module.

Time auto-standby/network

EAN code

4242006248505

#### Consumption and connection features

Connection rating (W)

1000

Current (A)

10

Voltage (V)

220-240

Frequency (Hz)

50

Approval certificates

CE, Eurasian, G-Mark, UA, Ukraine grounding sign, VDE

Capacity cotton (kg) - NEW (2010/30/EC)

8.0

Standard cotton programme

Cotton cupboard dry

Energy efficiency class (2010/30/EC)

A++

Energy consumption electric dryer, full load - NEW (2010/30/EC)

1.93

Standard cotton programme time at full load (min)

138

Energy consumption electric dryer, partial load - NEW (2010/30/EC) (kWh)

1.08

Standard cotton programme time at partial load (min)

92

Weighted annual energy consumption, electric dryer - NEW (2010/30/EC) (kWh)

232.0

Weighted programme time (min)

112

Average condensation efficiency full load (%)

91

Average condensation efficiency partial load (%)

91

Weighted condensation efficiency (%)

91

created on 2019-07-10

Page 1

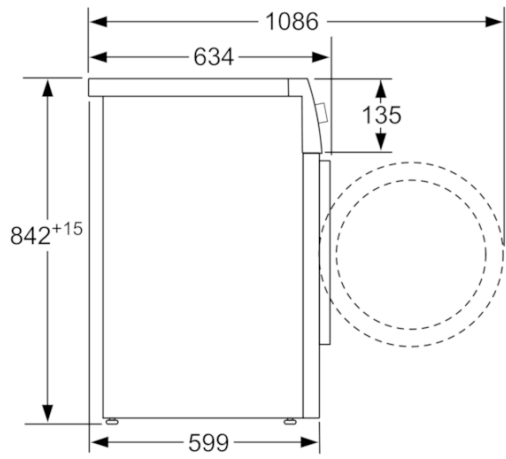

measurements in mm

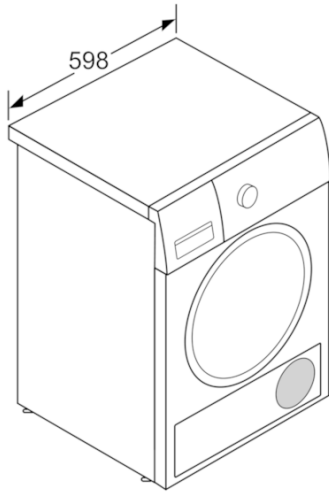

measurements in mm

