



WT260110

WA027400:  
Stacking kit with pull-out shelf

## Heat pump tumble dryer 200 Series 9 kg WT260110

### Capacity

Volume capacity from 1 to 9 kg.

### Consumption Rates

9 Energy Stars, Energy consumption 129kWh per year on Cottons, Cupboard Dry Extra, Drying level +3, used once per week. When tested in accordance with AS/NZS 2442.2. Actual energy use and running costs will depend on how you use the appliance.

### Programs

Drying Programs: Hygiene, Cottons, Shirts, Down clothing, Delicates, Mixed Load, Sportswear, towels, Easy Care, wool drying in basket (basket optional accessory), Wool, Timed program cold, Timed program warm, Super 40 minute program: Mixed load of synthetic fabrics and light colours, Additional Programs, 1 Shirt or Blouse: Cold timed program for reducing creases and airborne odours, 5 Shirts or Blouses: Cold timed program for reducing creases and airborne odours, 2 to 5 garments, Business: Cold timed program for reducing creases and airborne odours, suitable for Dry Clean only garments, 1 suit (1 jacket 1 pair of trousers/skirt), Smart Dry: a washing machine with Home Connect can automatically set the ideal drying program settings based on what it has just washed

Moisture and time controlled programmes.

The use of the Home Connect functionality depends on the Home Connect services, which are not available in every country. For further information please check: [home-connect.com](http://home-connect.com).

Combines perfectly with washing machine WM260164.

### Performance

Noise level: Very silent drying with only 62 dB(A)

Heat pump technology

Steam Refresh: refreshes and removes creases from dry laundry

Refresh function without previous washing cycle.

Smart Dry automatically selects the right dryer program based on the last washing program

Self-cleaning condenser for automatic fluff removal

Dry wool without shrinking or matting thanks to the included basket for woollens.

### Features

TFT display with clear text and symbols.

Programme sequence and remaining time display.

Time delay up to 24 hours.

Illuminated rotary knob with integrated On-Off switch.

Drum interior lighting.

Self-cleaning heat exchanger.

Anti-crease cycle at programme end.

Touch key operation.

Multiple signal tones.

Child lock.

Home network integration for digital services (Home Connect) wireless via WiFi.

### Technical Information

Right-hinged Door, but is reversible to Left-hinged.

Stainless steel drum with honeycomb structure.

Large porthole with 165 ° opening angle.

Total connected load 0.6 KW.

Connection cable 1.45 m with plug.

Height-adjustable feet by a total of 120mm

Height for slide-under installation: 84.2 cm.

Width 598 mm, height 842mm, depth 61.3 cm and 651mm depth including closed door

Side view of WT 260 above WM 260 with connection kit accessory

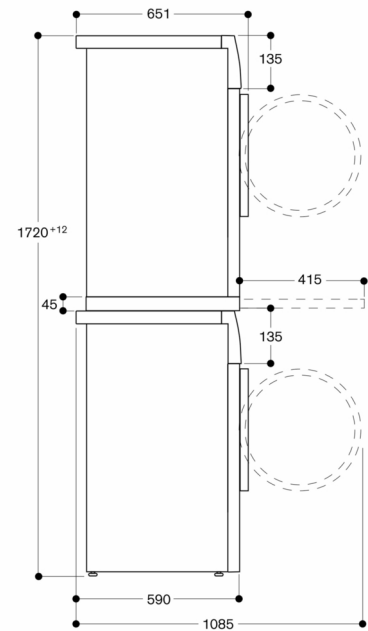

measurements in mm

Measurements in mm

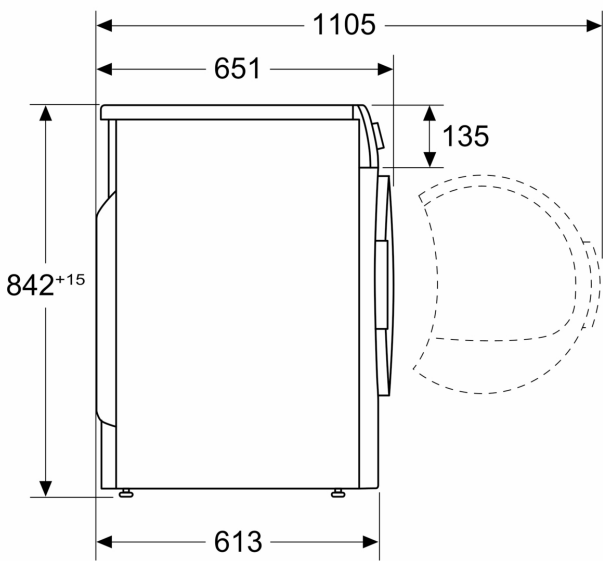

Measurements in mm

