



AC200191

AA210110:

Active charcoal filter f. recirc. module

AA211812:

Recirculation module w.active charcoal

**Canopy extractor 200 series**  
**86 cm, clear glass silver printed, Stainless steel**  
**AC200191**

Can be integrated invisibly in upper cabinet  
Energy-saving, low-noise fan  
Rim extraction with flat and easy-to-clean glass underside  
Dimmable, neutral white LED light for ideal illumination of the cooktop  
Air extraction or air recirculation system  
Energy efficiency class A++

**Output**

Performance and noise level, output level 3/Intensive:  
Air output according to EN 61591. Sound power level according to EN 60704-3.  
Air extraction:  
610 / 800m³/h.  
64 / 70 dB (A) re 1 pW.  
Air recirculation:  
540 / 790m³/h.  
72 / 77 dB (A) re 1 pW.

**Features**

3 electronically controlled power levels and 1 intensive mode.  
Interval ventilation, 6 min.  
Run-on function, 6 min.  
Grease filter saturation indicator.  
Metal grease filter, dishwasher-safe.  
Glas filter cover.  
Neutral white LED light (4000 K), dimmable.  
Lamp output 2 x 1 W.  
Illuminance 266 lx.  
Fan technology with highly efficient, brushless DC motor (BLDC).

**Consumption data**

Energy efficiency class A++ at a range of energy efficiency classes from A+++ to D.  
Energy consumption 31.4 kWh/year.  
Ventilation efficiency class A.  
Illumination efficiency class A.  
Grease filter efficiency class D.  
Sound level min. 41 dB / max. 64 dB normal mode.

**Planning notes**

The equivalent ducting length to ensure good performance is Lmax 19 m.  
For air recirculation an external air recirculation module is required.  
Patented air recirculation module with activated charcoal filter can be installed in the upper cabinet. The activated carbon filter can be changed from the front by simply pulling out the filter drawer.  
The door of the upper cabinet must be fully open in order to change the activated charcoal filter.  
Can be integrated invisibly in upper cabinet.  
Vario cooktops with intensive production of vapours like VR/VP should be placed in the middle beneath the hood (in this case air recirculation is not recommended).  
Clearance above gas appliances min. 65 cm (more than total load gas 12 kW min. 70 cm).  
Clearance above electric appliances min. 50 cm.

When installing a ventilation hood with air extraction mode and a chimney-vented fireplace, the power supply line of the ventilation appliance needs a suitable safety switch.

**Connection**

Total connected load 172 W.  
Connecting cable 1.0 m with plug.

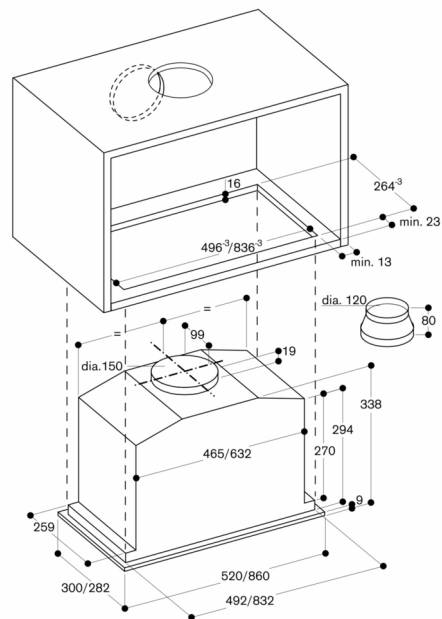

View of upper cabinet from above with AC 200 and AA 211 812

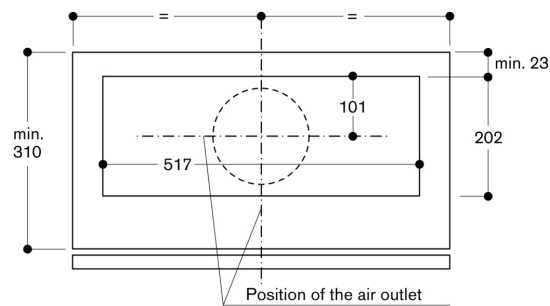

Cross-section of upper cabinet with AC 200 and AA 211 812

