



DF260164
Dishwasher 200 series
Fully integrated
Height 81.5 cm

Optional door opening at the end of the programme to support the hygienic drying process
6 programmes with aqua sensor and 4 options, such as Power and Intensive:
Clean and dry dishes in 59 minutes
Intensive cleaning in the lower basket while protecting glassware in the upper basket
Flexible basket system with smooth running rails on all levels
TFT display for intuitive handling of all functions
Remaining time projection onto the kitchen floor
Bright interior lighting
Very quiet: 42 dB
Energy efficiency class A++
Aqua stop with guarantee

Handling
 TFT display indicating remaining or end time, refill for salt and rinsing agent, inflow of water.
 Touch key operation.
 Information key with use indications.
 Time delay up to 24 hours.
 Visual and acoustic end of programme indicator.
 Remaining time projection.

Technical Features
 Bright interior lighting.
 Glass protection.
 Aqua sensor.
 Load sensor.
 Detergent recognition.
 Regeneration electronics.
 Heat exchanger.
 Continuous flow heater.
 Triple filter system.
 Soft lock.
 Aqua stop with guarantee.

Programmes
 6 programmes:
 Auto 35 °C - 45 °C.
 Auto 45 °C - 65 °C.
 Auto 65 °C - 75 °C.
 Eco 50 °C.
 Quick wash 45 °C (29 min.).
 Pre-rinse.
 4 options:
 Intensive.
 Power.
 Half Load.
 Holiday.

Features
 Flexible basket system with smooth running rails on all levels.
 Upper basket:
 Over extension.
 Rackmatic with 3 levels, adjustable in height up to 5 cm.
 6 folding spines.
 4 folding racks.
 2 glass support bars.
 Lower basket:
 8 folding spines.
 2 folding racks.
 Dividable glass support.
 Cutlery basket.
 Maximum dish sizes (upper/lower basket)
 27/25, 24.5/27.5 or 22/31 cm respectively.
 12 place setting capacity.
 Maximum glass loading capacity 23 wine glasses.

Consumption data

Characteristics
Energy efficiency class
Cleaning performance
 A
Water consumption (l)
 9.5
Total annual energy consumption (kWh)
Total annual water consumption (l)
Estimated annual consumption (220 standard cycles) energy (kWh)
 198
Total annual water consumption (l) 220 days
 2090
Built-in / Free-standing
 Built-in
Removable top
 No
Door panel options
 Not possible
Height with worktop (mm)
 0
Height of the product (mm)
 815
Adjustable feet
 Yes - front only
Maximum adjustability feet (mm)
 60
Adjustable plinth
Net weight (kg)
 43.830
Gross weight (kg)
 46.0
Connection Rating (W)
 2400
Current (A)
 10
Voltage (V)
 220-240
Frequency (Hz)
 50; 60
Length electrical supply cord (cm)
 175
Plug type
 Gardy plug w/ earthing
Length inlet hose (cm)
 165
Length outlet hose (cm)
 190
Hidden heating element
 Yes
Water protection system description
 Triple water protection 24h
 No
Water softener
 Yes
Top basket type
Adjustable upper basket
 Rackmatic 3-stage
Upper rack cup shelf
Bottom basket type
Lower rack cup shelf
 2
3rd Rack
 None
Silverware Basket
 Standard
Optional accessories
 DA041160, DA042030, DA043000
Included accessories 2
 baking-sheet spray head grey, s/s decorative strips, vapor barrier plate
Number of place settings
 12
Color / Material panel
 Grey
Color / Material body
Color / Material top
Dimensions of the packed product (HxWxD) (mm)
 870 x 670 x 660
Consumption and connection features
Brand
 Gaggenau
Product name / Commercial code
 DF260164
Number of place settings
 12
Energy efficiency class - NEW (2010/30/EC)

Energy efficiency class A++ at a range of energy efficiency classes from A++ to D.
 From 9.5 l water.
 From 0.9 kwh.
 Noise level 42 dB (re 1 pW).

Planning notes
 Height-adjustable feet.
 Appliance plinth recess 100 mm (see drawing).
 To display the remaining time projection, a minimum plinth protrusion is required (40 mm + thickness of the furniture front).
 The maximum plinth height must be reduced by 30 mm to provide an optimal display of the remaining time projection.
 Rear feet adjustable at front.
 Door weight up to 8.5 kg.
 Door panel dimension dependent on plinth height of kitchen furniture.
 For installation into a tall unit, ventilation openings are recommended (min. 200 cm²).

Connection
 Total connected load 2.4 kW.
 Connecting cable pluggable.
 Water connection with 3/4" screw joint.
 Connection to hot or cold water possible.

Color Variants
 DF260164
 Fully integrated
 Height 81.5 cm

Included accessories
 1 x baking tray spray head.

Optional accessories
 DA041160
 Cutlery drawer with smooth running rails
 DA042030
 Silvercare cartridge for all dishwashers
 DA043000
 Holder for long-stemmed glasses

Installation Accessories
 DA021000
 Hinge for all fully integrated dishwashers
 DA231010
 Stainless steel-backed full glass door for 81.5 cm high dishwashers
 GH045010
 Handle bar with 2 mounts, stainless steel, Length 45 cm, drilling distance 427 mm
 GZ010011
 Extension for water inlet and outlet (2 m long)

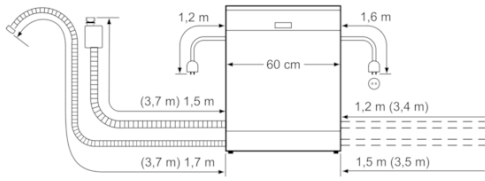

() Werte mit Verlängerungssatz

Connection dimensions for a 60 cm wide dishwasher

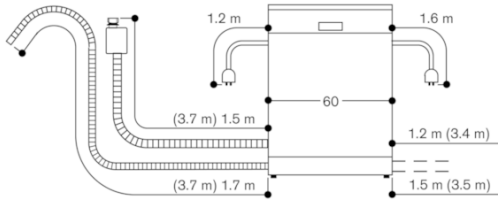

() values with extension kit

81.5 cm high dishwasher

