



DF260261
Dishwasher 200 series
Fully integrated
Height 81.5 cm

6 programmes with aqua sensor and 2 options, Power and Intensive: Clean and dry dishes in 59 minutes Intensive cleaning in the lower basket while protecting glassware in the upper basket
TFT display for intuitive handling of all functions
Remaining time projection onto the kitchen floor
Bright interior lighting
Push-to-open function for perfect integration into handleless furniture fronts
Very quiet: 44 dB
Aqua stop

Handling

TFT display indicating remaining or end time, refill for salt and rinsing agent, inflow of water.
 Touch key operation.
 Information key with use indications.
 Time delay up to 24 hours.
 Visual and acoustic end of programme indicator.
 Remaining time projection.

Technical Features

Bright interior lighting.
 Glass protection.
 Aqua sensor.
 Load sensor.
 Detergent recognition.
 Regeneration electronics.
 Heat exchanger.
 Continuous flow heater.
 Triple filter system.
 Soft lock.
 Aqua stop.

Programmes

6 programmes:
 Auto 35 °C - 45 °C.
 Auto 45 °C - 65 °C.
 Auto 65 °C - 75 °C.
 Eco 50 °C.
 Quick wash 45 °C (29 min.).
 Pre-rinse.
 2 options:
 Intensive.
 Power.

Features

Flexible basket system.
 Upper basket:
 Over extension.
 Rackmatic with 3 levels, adjustable in height up to 5 cm.
 6 folding spines.
 2 folding racks.
 1 knife rack.
 1 glass support bar.
 Lower basket:
 8 folding spines.
 2 folding racks.
 Glass support.
 Cutlery basket.
 Maximum dish sizes (upper/lower basket)
 27/25, 24.5/27.5 or 22/31 cm respectively.
 13 place setting capacity.

Consumption data

Energy efficiency class A++ at a range of energy efficiency classes from A++ + to D.
 From 9.5 l water.
 From 0.92 kWh.
 Noise level 44 dB (re 1 pW).

Planning notes

Height-adjustable feet.

Characteristics

Energy efficiency class
Cleaning performance
 A
Water consumption (l)
 9.5
Total annual energy consumption (kWh)
Estimated annual consumption (220 standard cycles) energy (kWh)
 202
Total annual water consumption (l) 220 days
 2090
Built-in / Free-standing
 Built-in
Removable top
 No
Door panel options
 Not possible
Height with worktop (mm)
 0
Height of the product (mm)
 815
Adjustable feet
 Yes - front only
Maximum adjustability feet (mm)
 60
Adjustable plinth
Net weight (kg)
 38.830
Gross weight (kg)
 41.0
Connection Rating (W)
 2400
Current (A)
 10
Voltage (V)
 220-240
Frequency (Hz)
 50; 60
Length electrical supply cord (cm)
 175
Plug type
 Gardy plug w/ earthing
Length inlet hose (cm)
 165
Length outlet hose (cm)
 190
Hidden heating element
 Yes
Water protection system description
 Triple water protection 24h
Water softener
 Yes
Top basket type
Adjustable upper basket
 Rackmatic 3-stage
Upper rack cup shelf
Bottom basket type
 Lower rack cup shelf
3rd Rack
 None
Silverware Basket
 Standard
Optional accessories
 DA041161, DA042030, DA043000, DA043060
Included accessories 2
 baking-sheet spray head grey, vapor barrier plate
Number of place settings
 13
Color / Material panel
 Grey
Color / Material body
Color / Material top
Dimensions of the packed product (HxWxD) (mm)
 880 x 670 x 660
Consumption and connection features
Brand
 Gaggenau
Product name / Commercial code
 DF260261
Number of place settings
 13
Energy efficiency class - NEW (2010/30/EC)
 A++
Energy consumption annual (kWh/

Appliance plinth recess 100 mm (see drawing).
 To display the remaining time projection, a minimum plinth protrusion is required (40 mm + thickness of the furniture front).
 The maximum plinth height must be reduced by 30 mm to provide an optimal display of the remaining time projection.
 Rear feet adjustable at front.
 Door weight up to 8.5 kg.
 Door panel dimension dependent on plinth height of kitchen furniture.
 Installation and usage also with furniture handle possible. The push-to-open function remains active.
Connection
 Total connected load 2.4 kW.
 Connecting cable pluggable.
 Water connection with 3/4" screw joint.
 Connection to hot or cold water possible.

Color Variants

DF260261
Fully integrated
Height 81.5 cm

Included accessories

1 x baking tray spray head.

Optional accessories

DA041161
Cutlery drawer
DA042030
Silvercare cartridge for all dishwashers
DA043000
Holder for long-stemmed glasses
DA043060
Glass basket

Installation Accessories

DA020010
Stainless steel trim kit for 81,5 cm high dishwashers
DA021000
Hinge for all fully integrated dishwashers
DA231010
Stainless steel-backed full glass door for 81.5 cm high dishwashers
GH045010
Handle bar with 2 mounts, stainless steel, Length 45 cm, drilling distance 427 mm
GZ010011
Extension for water inlet and outlet (2 m long)

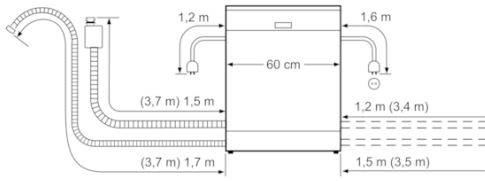

() Werte mit Verlängerungssatz

Connection dimensions for a 60 cm wide dishwasher

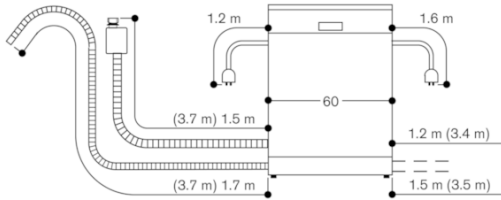

() values with extension kit

81.5 cm high dishwasher

