



WT260100
Tumble dryer with heat pump
Free-standing, slide-under or stackable
Width 60 cm, height 84.2 cm

Can be perfectly combined with WM 260 162
Large drum with interior lighting
Large porthole with 180 ° door opening angle
Self-cleaning heat exchanger, highest comfort and constantly low consumption
Heat pump technology
Energy efficiency class A++

Handling

Electronic control.
 Illuminated rotary knob with integrated On-Off switch.
 Touch key operation.
 TFT display with clear text and symbols. Programme sequence and remaining time display.
 Time delay up to 24 hours.
 Multiple signal tones.

Technical Features

Moisture and time controlled programmes.
 Heat pump technology.
 Self-cleaning heat exchanger.
 Anti-crease cycle at programme end.
 Child lock.

Programmes

Cottons.
 Easy Care.
 Mix.
 Shoes in basket.
 Wool in Basket.
 Cold.
 Warm.
 Towels.
 Blankets.
 Jeans.
 Super 40.
 Outdoor.
 Downs.
 Shirts/blouses.

Features

Stainless steel drum with honeycomb structure.
 Dry wool without shrinking or matting thanks to the included basket for woollens.
 Volume capacity from 1 to 8 kg.
 Drum interior lighting.

Consumption data

Energy efficiency class A++ at a range of energy efficiency classes from A++ to D.

Planning notes

Right-hinged, reversible.
 Height-adjustable feet.
 Height for slide-under installation: 84.2 cm.
 Stackable over the washing machine WM 260 162 in combination with special accessory.

Connection

Total connected load 1.0 kW.
 Connection cable 1.45 m with plug.

Characteristics

Built-in / Free-standing
 Free-standing
Removable top
 No
Door hinge
 Right reversible
Color / Material body
 White
Length electrical supply cord (cm)
 145.0
Height with worktop (mm)
 842
Dimensions of the product (mm)
 842 x 598 x 599
Net weight (kg)
 57.124
Drum volume (l)
 112
Fluorinated greenhouse gases
 Yes
Type of refrigerant
 R407C
Hermetically sealed equipment
 Yes
Quantity of fluorinated gases (kg)
 0.290
The quantity expressed in CO2 equivalent (t)
 0.514
Power consumption standby/network:
Please check the user manual for how to switch off the WiFi module.
Time auto-standby/network

Consumption and connection features

Connection Rating (W)
 1000
Current (A)
 10
Voltage (V)
 220-240
Frequency (Hz)
 50
Approval certificates
 CE, Eurasian, G-Mark, UA, Ukraine grounding sign, VDE
Drying process
 automatic
Capacity cotton (kg) - NEW (2010/30/EC)
 8.0
Standard cotton programme
 Cotton cupboard dry
Energy efficiency class - NEW (2010/30/EC)
 A++
Energy consumption electric dryer, full load - NEW (2010/30/EC) (kWh)
 1.93
Standard cotton programme time at full load (min)
 138
Energy consumption electric dryer, partial load - NEW (2010/30/EC) (kWh)
 1.08
Standard cotton programme time at partial load (min)
 92
Weighted annual energy consumption, electric dryer - NEW (2010/30/EC) (kWh)
 232.0
Power consumption in off-mode (W) - NEW (2010/30/EC)
 0.10
Power consumption in left-on mode (W) - NEW (2010/30/EC)
 0.10
Duration of the left-on mode - NEW (2012/30/EC) (min)
 30
Weighted programme time (min)
 112
Condensation efficiency class - NEW (2010/30/EC)
 A
Average condensation efficiency full load (%)
 91
Average condensation efficiency partial load (%)
 91

Color Variants

WT260100
Free-standing, slide-under or stackable
Width 60 cm, height 84.2 cm

Optional accessories

WA032001
Connection kit with extendable shelf

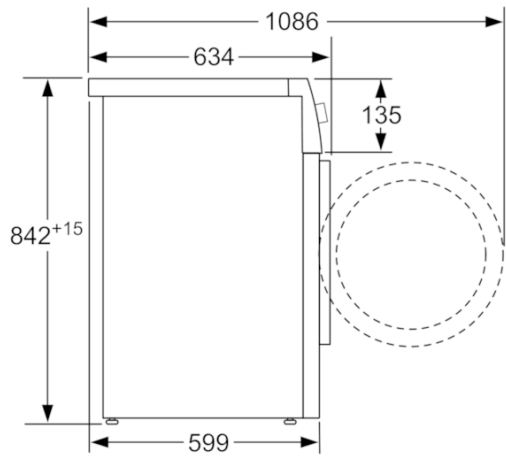

measurements in mm

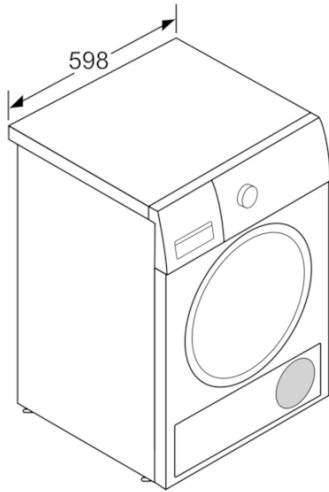

measurements in mm

