



Color Variants

WT260110CN

Free-standing, slide-under or stackable

Width 60 cm, height 84.2 cm

Optional accessories

WA032001

Connection kit with extendable shelf

WT260110CN

Tumble dryer with heat pump

Free-standing, slide-under or stackable

Width 60 cm, height 84.2 cm

Can be perfectly combined with WM 260 162 CN
Large drum with interior lighting
Large porthole with 180 ° door opening angle
Self-cleaning heat exchanger, highest comfort and constantly low consumption
Heat pump technology

Handling

Electronic control.
Illuminated rotary knob with integrated On-Off switch.
Touch key operation.
TFT display with clear text and symbols.
Programme sequence and remaining time display.
Time delay up to 24 hours.
Multiple signal tones.

Technical Features

Moisture and time controlled programmes.
Heat pump technology.
Self-cleaning heat exchanger.
Anti-crease cycle at programme end.
Child lock.

Programmes

Cottons.
Mix.
Synthetics.
Delicates.
Duvets.
Programme time warm.
Wool in Basket.
Shoes in basket.
Towels.
Duvets.
Shirts.
Hygiene Plus.
Outdoor.
Super 40.

Features

Stainless steel drum with honeycomb structure.
Dry wool without shrinking or matting thanks to the included basket for woollens.
Volume capacity from 1 to 9 kg.
Drum interior lighting.

Planning notes

Right-hinged, reversible.
Height-adjustable feet.
Height for slide-under installation: 84.2 cm.
Stackable over the washing machine WM 260 162 CN in combination with special accessory.

Connection

Total connected load 1.0 kW.
Connection cable 1.45 m with plug.

Characteristics

Built-in / Free-standing

Free-standing

Removable top

No

Door hinge

Right reversible

Color / Material body

White

Length electrical supply cord (cm)

145.0

Height with worktop (mm)

842

Dimensions of the product (mm)

842 x 598 x 599

Net weight (kg)

55.462

Drum volume (l)

112

Fluorinated greenhouse gases

Yes

Type of refrigerant

R407C

Hermetically sealed equipment

Yes

Quantity of fluorinated gases (kg)

0.290

The quantity expressed in CO2 equivalent (t)

0.514

Power consumption standby/network:
Please check the user manual for how to switch off the WiFi module.

Time auto-standby/network

Consumption and connection features

Connection Rating (W)

1000

Current (A)

10

Voltage (V)

220

Frequency (Hz)

50

Approval certificates

CE, VDE

Drying process

automatic

Capacity cotton (kg) - NEW (2010/30/EC)

9.0

Standard cotton programme

Energy efficiency class - NEW (2010/30/EC)

A++

Energy consumption electric dryer, full load - NEW (2010/30/EC) (kWh)

Standard cotton programme time at full load (min)

Energy consumption electric dryer, partial load - NEW (2010/30/EC) (kWh)

Standard cotton programme time at partial load (min)

Weighted annual energy consumption, electric dryer - NEW (2010/30/EC) (kWh)

Power consumption in off-mode (W) - NEW (2010/30/EC)

0.10

Power consumption in left-on mode (W) - NEW (2010/30/EC)

0.10

Duration of the left-on mode - NEW (2012/30/EC) (min)

30

Weighted programme time (min)

Condensation efficiency class - NEW (2010/30/EC)

A

Average condensation efficiency full load (%)

Average condensation efficiency partial load (%)

Weighted condensation efficiency (%)

2019-11-08

Page 1

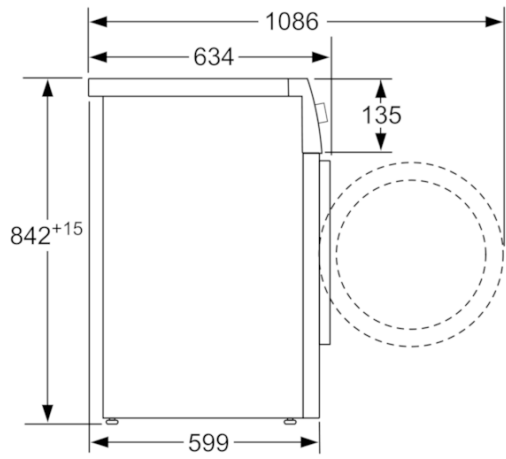

measurements in mm

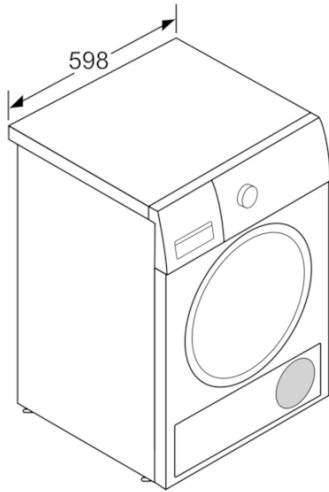

measurements in mm

